



Beauvale Road
Hucknall Nottingham

burchell
edwards

Beauvale Road Hucknall Nottingham NG15 6PF

for sale offers over
£190,000



Property Description

Burchell Edwards are delighted to offer for sale this beautifully presented three-bedroom end terrace property that has been enhanced throughout by the current owner. The property consists of entrance hallway, ground floor WC, lounge, dining kitchen. On the first floor there are three bedrooms and a spacious family bathroom. The property has an enclosed spacious rear garden with patio area and outbuildings and lawn, to the front is a driveway.

Entrance Hallway

Accessed via entrance door leading into the hall with a radiator and door leading to the lounge.

Lounge

12' 11" x 12' 1" (3.94m x 3.68m)
Having a window to the front elevation and a radiator.

Kitchen/ Diner

16' 3" x 9' 6" (4.95m x 2.90m)
Fitted with wall and base units with work surfaces over, spot lights, extractor fan, space for cooker, a radiator, three UPVC windows to the rear elevation, inset sink unit, space and plumbing for washing machine, space for fridge freezer, boiler and door to W.C.

Downstairs W.C

Having low level W.C, wash hand basin and window to the side elevation.

First Floor Landing

Having loft access.

Bedroom One

.11' x 1' 1" (3.35m x 0.33m)
Having window to the rear elevation and a radiator.

Bedroom Two

9' 6" x 7' 1" (2.90m x 2.16m)
Having a window to the front elevation and a radiator.

Bedroom Three

6' 4" x 10' 6" (1.93m x 3.20m)
Having carpet flooring, window to the front elevation, a radiator, spot lights and built-in storage cupboard.

Family Bathroom

6' 5" x 7' 8" (1.96m x 2.34m)
Having tiled flooring, corner shower cubicle with electric shower over, obscured window to the rear elevation, a radiator, pedestal wash hand basin and low level W.C.

Outside

To the rear the garden has a patio area with steps up leading to a lawned section, summer house and a shed







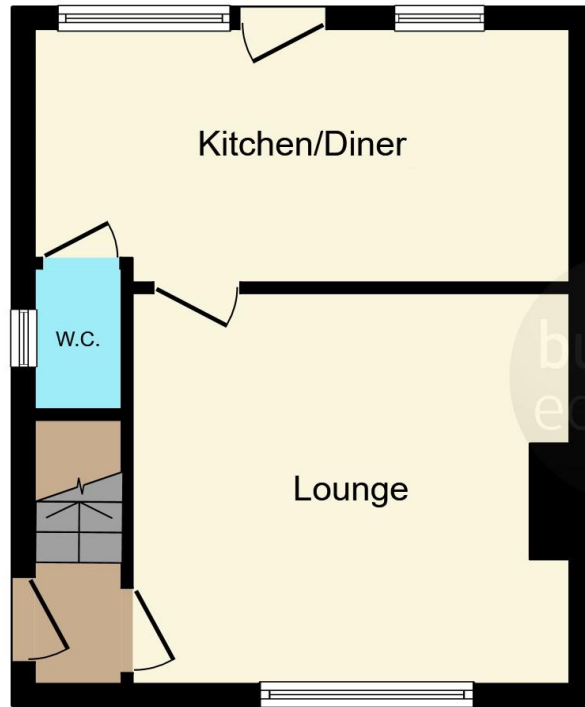

Ground Floor

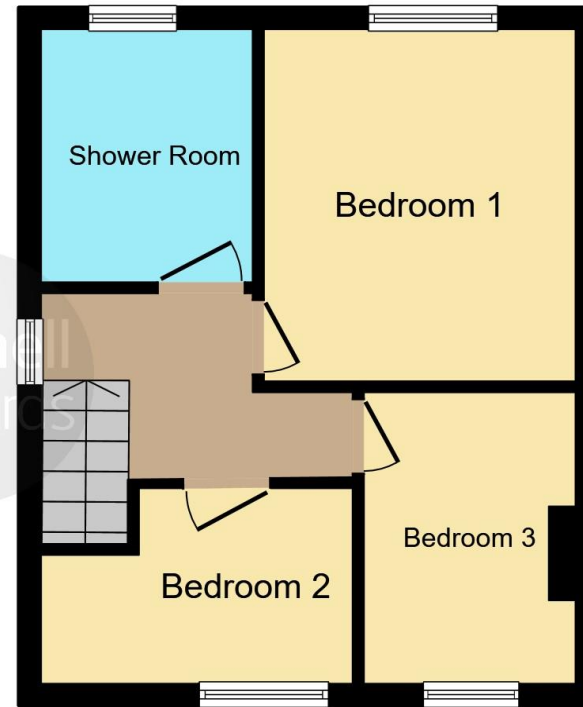

First Floor

This floor plan is for illustrative purposes only. It is not drawn to scale. Any measurements, floor areas (including any total floor area), openings and orientation are approximate. No details are guaranteed, they cannot be relied upon for any purpose and they do not form part of any agreement. No liability is taken for any error, omission or misstatement. A party must rely upon its own inspection(s). Powered by www.focalagent.com

To view this property please contact Burchell Edwards on

T 0115 968 0528
E hucknall@burchelledwards.co.uk

64 High Street Hucknall
NOTTINGHAM NG15 7AX

EPC Rating: F

Tenure: Freehold

view this property online burchelledwards.co.uk/Property/HUK102678



1. MONEY LAUNDERING REGULATIONS Intending purchasers will be asked to produce identification documentation at a later stage and we would ask for your co-operation in order that there will be no delay in agreeing the sale. 2. These particulars do not constitute part or all of an offer or contract. 3. The measurements indicated are supplied for guidance only and as such must be considered incorrect. Potential buyers are advised to recheck measurements before committing to any expense. 4. We have not tested any apparatus, equipment, fixtures, fittings or services and it is in the buyers interest to check the working condition of any appliances.

Burchell Edwards is a trading name of Connells Residential which is registered in England and Wales under company number 1489613, Registered Office is Cumbria House, 16-20 Hockliffe Street, Leighton Buzzard, Bedfordshire, LU7 1GN. VAT Registration Number is 500 2481 05.

See all our properties at www.burchelledwards.co.uk | www.rightmove.co.uk | www.zoopla.co.uk

Property Ref: HUK102678 - 0001