



Pilkington Road, Braunstone, LE3



Guide price £180,000



Key Features

- Three Well Proportioned Bedrooms
- Semi Detached Home
- Available With No Upward Chain
- In Need of Modernisation
- Larger Than Normal Corner Plot
- Popular Location
- EPC rating D
- Freehold





EXCITING RENOVATION PROJECT! - Offered to the market with no upward chain, walk in and be surprised by this three bedroom semi detached requiring total modernisation throughout but boasting amazing potential and must be viewed in person to fully appreciate what could be a fabulous family home or investment. The layout includes an entrance hall, lounge, kitchen, utility/storage area and bathroom, with the first floor offering three bedrooms and a separate WC. Occupying a position set back corner position, the plot offers parking to the front with a garden to the rear. Perfect for those looking for a home to 'put their own stamp on', an early viewing comes highly recommended to avoid disappointment.

Tenure & Council Tax

We understand the property to be freehold with vacant possession upon completion. Leicester City Council - Tax Band A. Please be advised that when a property is sold, local authorities reserve the right to re-calculate the council tax band.

Viewing Arrangements

Viewings are strictly by appointment only.

Need Independent Mortgage Advice?

We are pleased to introduce the Mortgage Advice Bureau, who works with Newton Fallowell Estate Agents to provide our customers with expert mortgage advice. They have access to thousands of mortgages, including exclusive deals not available on the high street. Their advice is tailored to your circumstances, whether you're looking to take your first steps on the property ladder, moving home, or even investing in a buy-to-let property. They can help find the right mortgage for you and support your application every step of the way. To speak with our expert 'in branch' adviser, please contact our office.

Making an Offer

In line with current money laundering regulations, prospective buyers will be asked to provide us with

photo I.D. (e.g. Passport, driving licence, bus pass etc) and proof of address (e.g. Current utility bill, bank statement etc). You will also be asked to provide us with proof of how you will be funding your purchase. Please note that when making an offer, if you are taking out a mortgage, you will also be asked to have a no obligation chat with our 'in branch' mortgage adviser to confirm your affordability. We ask for your cooperation in this matter as this information will be required before a sale can be agreed.

Agents Note

These particulars, whilst believed to be accurate are set out as a general outline only for guidance and do not constitute any part of an offer or contract. Details are given without any responsibility, and any intending purchasers, lessees or third parties should not rely on them as statements of representation of fact, but must satisfy themselves by inspection or otherwise as to their accuracy. All photographs, measurements (width x length), floorplans and distances referred to are given as a guide only and should not be relied upon for the purchase of carpets or any other fixtures or fittings. All services and appliances have not and will not be tested by Newton Fallowell. Lease details, service ground rent are given as a guide only and should be checked and confirmed by your solicitor prior to exchange of contracts. No person in this firm's employment has the authority to make or give any representation or warranty in respect of the property. We retain the copyright.

Referrals

Newton Fallowell and our partners provide a range of services to our vendors and purchasers, although you are free to choose an alternative provider. We can refer you to Benjamin York at Chamelo to help with finances, we may receive a referral fee if you take out a mortgage through him. If you require a solicitor to handle your sale or purchase, we can refer you on to a panel of preferred providers and we will receive a referral fee should you decide to use them to sell or purchase a property. We can also refer you to a surveyor and energy assessor and we will receive a referral fee should you use their services. If you require more information regarding our referral programmes, please ask at our office.

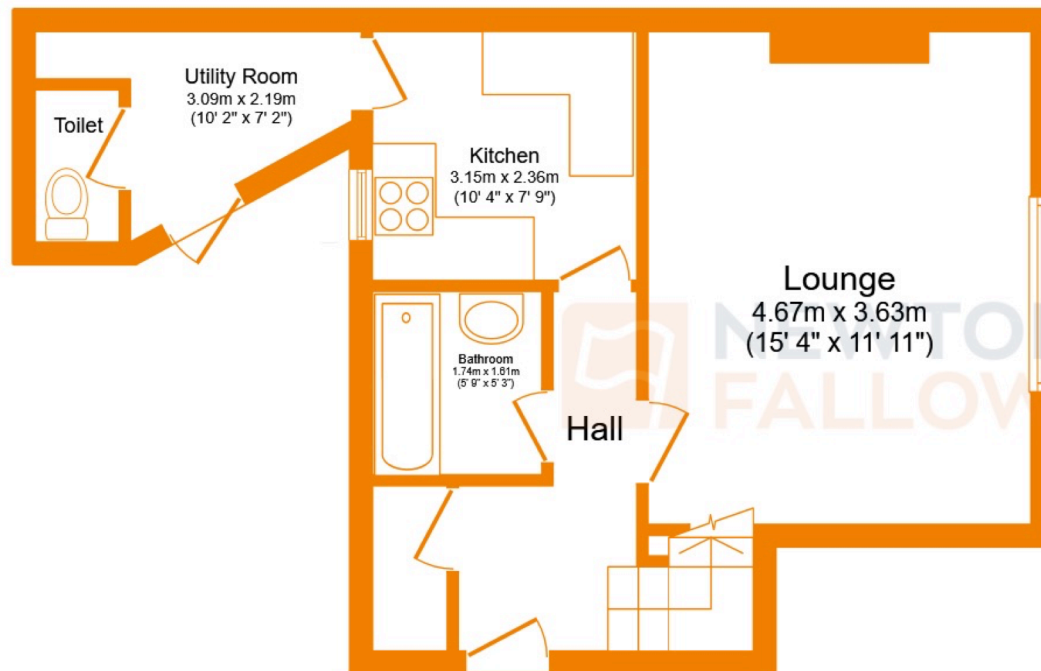

Ground Floor

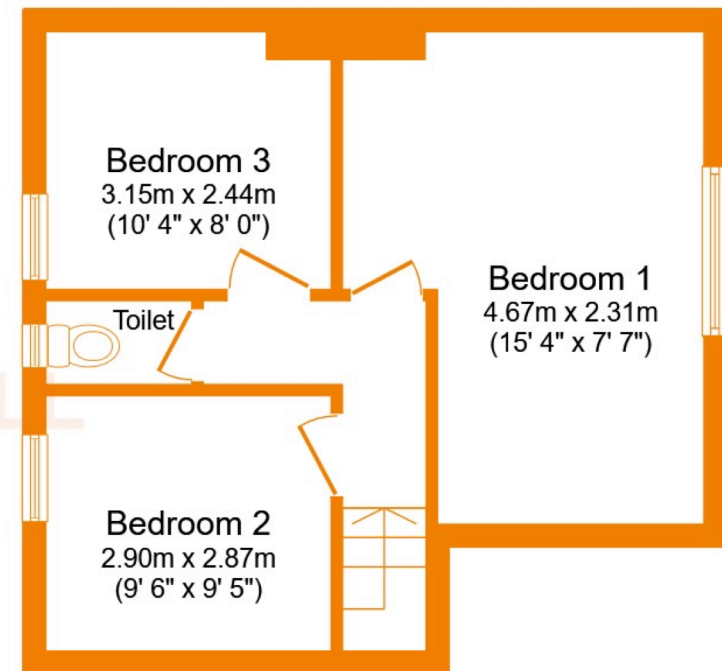

First Floor

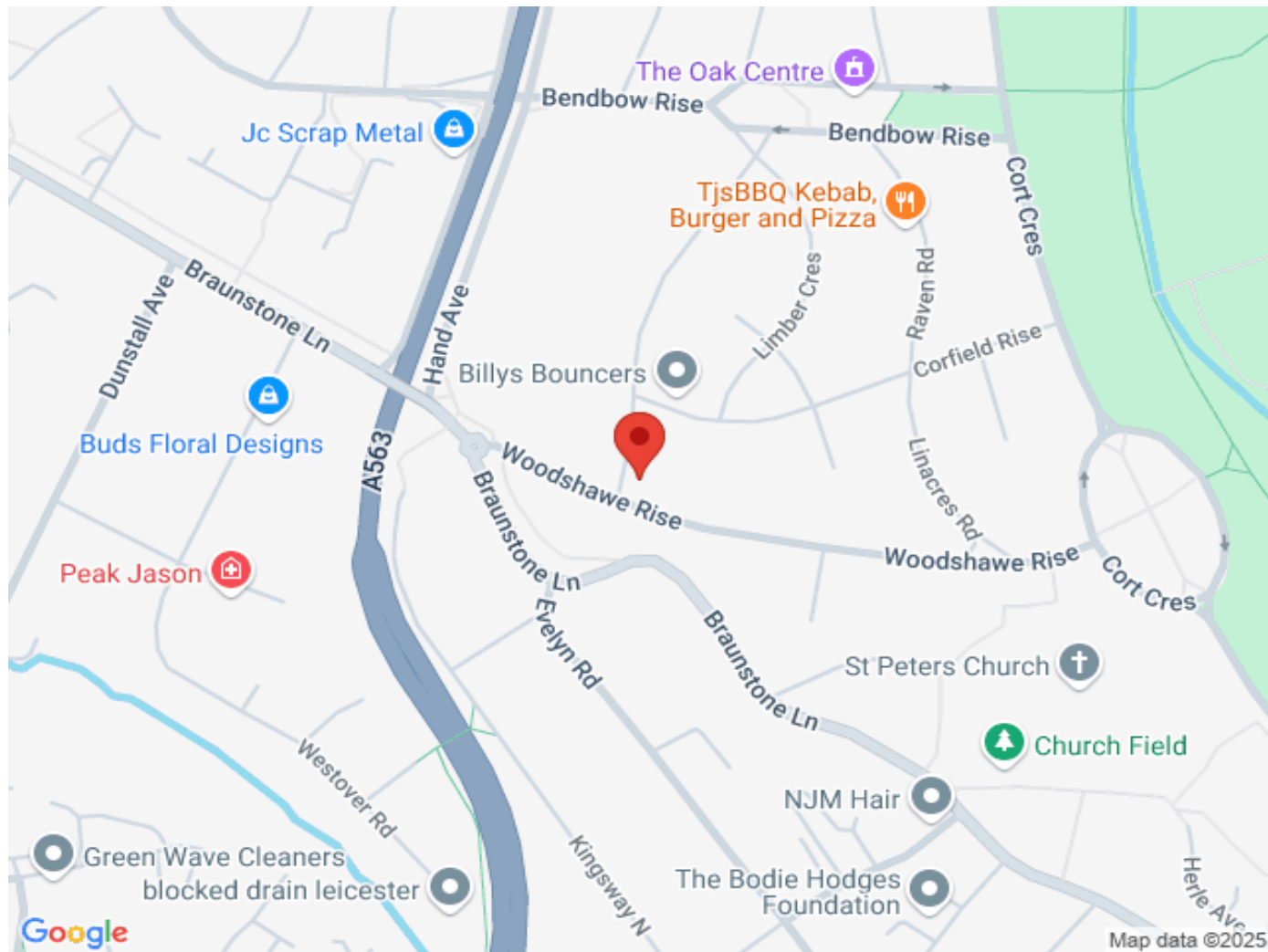

 **NEWTONFALLOWELL**

0116 366 5666
lfe@newtonfallowell.co.uk