



**£2,950 PCM**     *Unfurnished*

**\*\*AVAILABLE MID APRIL\*\***

Set in an extremely quiet cul-de-sac, backing onto woodland in the popular village of Penn's is this superb, four bedroom, detached family home that enjoys a quiet and tucked away position with well level and well proportioned gardens. The property is situated close to the centre of Penn, with it being one of the most picturesque villages in the region with a village green and pond, shopping facilities for day to day needs, a doctors surgery and excellent first and middle schools, whilst Beaconsfield old and new towns are both within a short drive. There is also a mainline station from Beaconsfield and the nearby town of High Wycombe serving London Marylebone in approximately 30 minutes and just the other side of Beaconsfield Old Town the M40 Junction 2 can be found which provides good access to the M25 national motorway network, and also the London Airports. There are several good traditional country inns locally and an extensive selection of restaurants in Beaconsfield and the nearby town of Amersham. The accommodation includes; spacious entrance hall, guest w/c, fitted

- AVAILABLE MID APRIL
- DOUBLE GARAGE
- DRIVEWAY PARKING
- EN-SUITE WITH MASTER BEDROOM
- LARGE LEVEL REAR GARDEN
- FITTED KITCHEN BREAKFAST ROOM
- DETACHED
- INTERNAL VIEWING ADVISED
- FOUR DOUBLE BEDROOMS
- LOUNGE & DINING ROOM



**25 Hillside Road, Penn, Bucks, HP10 8JJ**

Estate Agents ~ Lettings Agents ~ Valuers ~ Independent Mortgage Advisors

Hurst Estate Agents, 1 Crendon Street, High Wycombe, Bucks, HP13 6LE Tel: 01494 521234 Fax: 01494 523392 Email: [wyc@hursts.co.uk](mailto:wyc@hursts.co.uk) Web: [www.hursts.co.uk](http://www.hursts.co.uk)



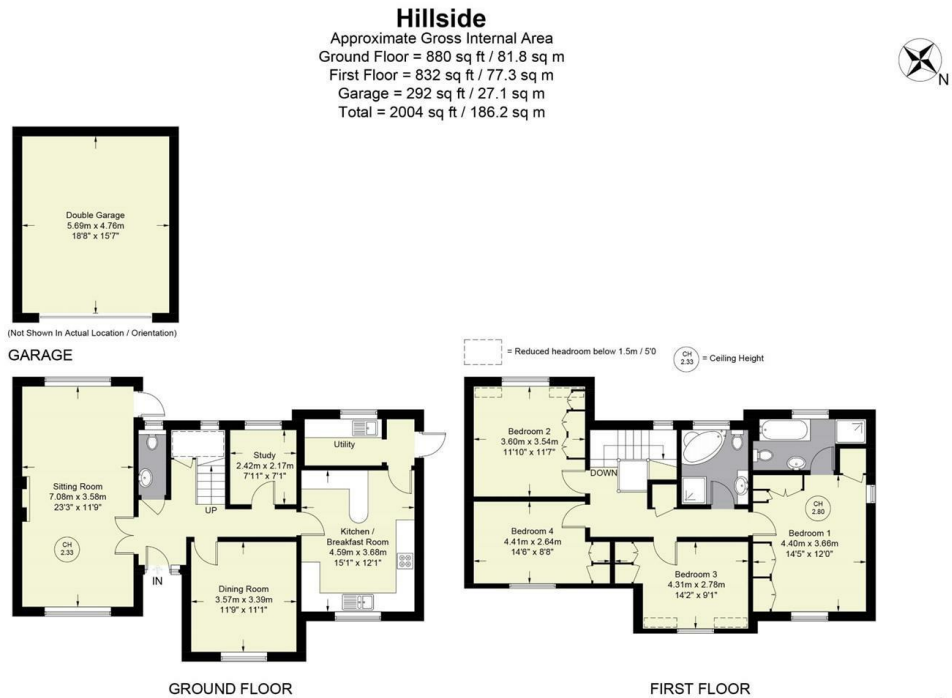

Floor Plan produced for Hursts by Media Arcade ©.  
Illustration for identification purposes only. Window and door openings are approximate. Whilst every attempt is made to assure accuracy in the preparation of this plan, please check all dimensions, shapes and compass bearings before making any decisions reliant upon them.

