



andrew scott
robertson
residential



Longmans Mews, SW20

£500,000

The property offers two generously sized double bedrooms, a contemporary bathroom and a separate cloakroom. The fully integrated kitchen/diner features smart stone worktops and opens into a bright living area, with glazed doors leading out to a private courtyard garden. Further benefits include underfloor heating throughout and built in wardrobes in the bedrooms.

Longmans Mews enjoys a convenient location, well placed for the wide range of shopping, leisure, and transport options available in Raynes Park, Wimbledon Chase, and Wimbledon Town Centre.

- Two Double Bedrooms • Under Floor Heating • Secluded Private Courtyard •
- Ground Floor Apartment • Open Plan Kitchen • Guest Cloakroom •



andrew scott
robertson
residential

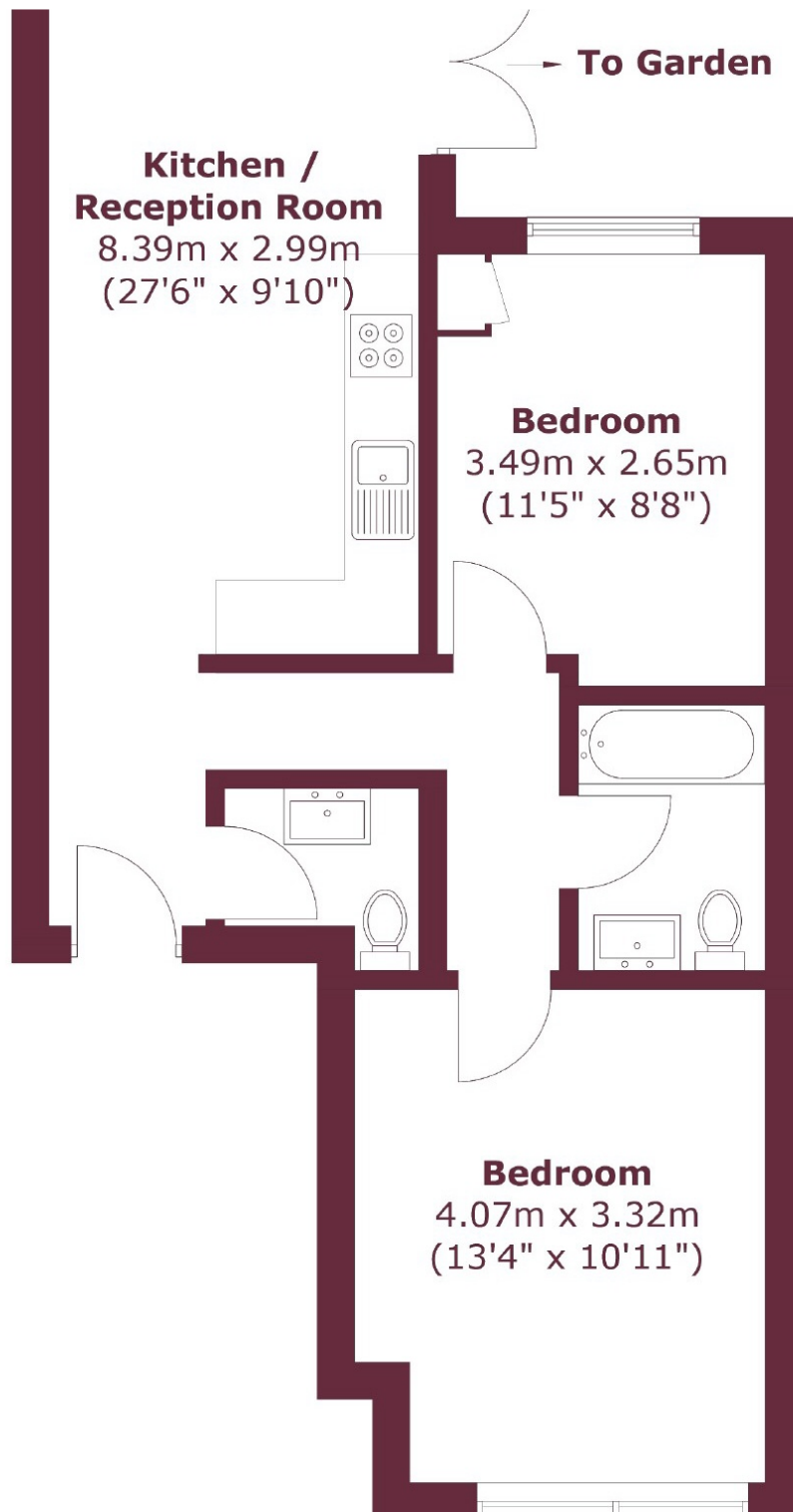

andrew scott robertson
24 High Street, Wimbledon Village, SW19 5DX
Sales: 020 8879 6660
asr-residential.co.uk



Energy Rating: D We aim to make our particulars both accurate and reliable. However they are not guaranteed; nor do they form part of an offer or contract. If you require clarification on any points then please contact us, especially if you're travelling some distance to view. Please note that appliances and heating systems have not been tested and therefore no warranties can be given as to their good working order.