



Damac Tower
67 Bondway, SW8





A must-see one-bedroom one-bathroom apartment in the spectacular Damac Tower, moments from Vauxhall Station. The apartment offers breath-taking views of London and the River Thames from the 30th floor.

DAMAC Tower Nine Elms London is nestled between Vauxhall and Nine Elms and offers the ultimate in branded living experiences with interiors by renowned luxury design house, Versace Home. Artistic director, Donatella Versace, has considered every design detail.

Rising 50 storeys, the Tower boasts 8010 square feet of communal gardens, an indoor swimming pool and Jacuzzi, a state-of-the-art gymnasium, a cinema room, a games room, a large residents lounge, a children's play area, secure bike storage, and a 24 hour concierge.

The area is close to the Vauxhall Cross rail and bus stations, as well as the Underground. In addition, the new Northern Line extension and the Elizabeth Line further enhance its strong transport links with the rest of London.

- Stunning Views
- 30th Floor
- 23rd Floor Pool
- Resident Gym
- 24 Hour Concierge
- Cinema Room

£3,000 pcm

Additional tenant charges apply (fees apply to non-AST tenancies only)

Tenancy Agreement Fee: £300

References per Tenant/Guarantor: £60

Inventory check (approx. £100 – £250 inc. VAT)

[chestertons.co.uk/property-to-rent/applicable-fees](https://www.chestertons.co.uk/property-to-rent/applicable-fees)

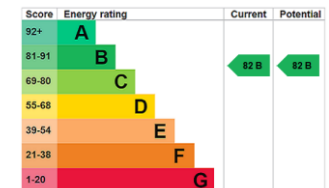

Minimum Term: 12 months
Deposit Required: £3,461.54
Local Authority: London Borough Of Lambeth
Council Tax Band: E
EPC Rating: B
Furnished

Chestertons Battersea Park & Nine Elms Lettings

62-64 Battersea Bridge Road
 London
 SW11 3AG

batterseapark@chestertons.co.uk
 02030408269
[chestertons.co.uk](https://www.chestertons.co.uk)

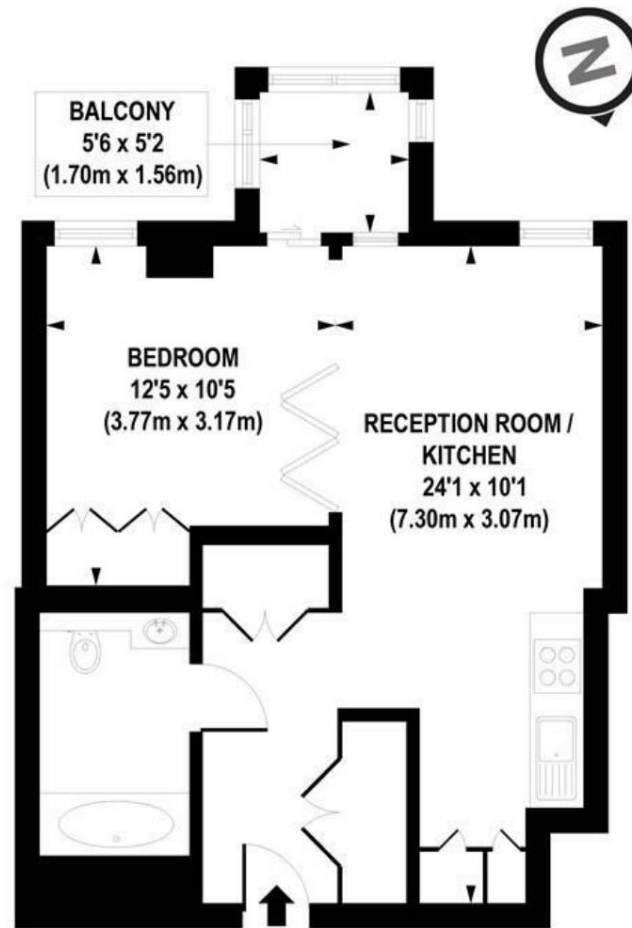

APPROX. GROSS INTERNAL FLOOR AREA 467 sq. ft / 43.41 sq. m

Chesterton UK Services Limited trading as Chestertons for themselves and for the vendor of this property whose agents they are, give notice that (i) these particulars do not constitute any part of an offer or contract, (ii) all statements contained within these particulars are made without responsibility on the part of Chestertons or the vendor, (iii) whilst made in good faith, none of the statements contained within these particulars are to be relied upon as a statement or representation of fact, (iv) any intending purchasers must satisfy themselves by inspection or otherwise as to the correctness of each of the statements contained within these particulars, (v) the vendor does not make or give either Chestertons or any person in their employment any authority to make or give representation or warranty whatsoever in relation to this property. Wide angle lenses may be used. ©Copyright Chestertons | Chesterton Global Ltd | Registered Office 40 Connaught Street, Hyde Park, London W2 2AB Registered Company Number 05334580.

