



Fentiman Road
London, SW8

CHESTERTONS





Chestertons are pleased to present this substantial, newly refurbished house in Stockwell/Vauxhall. Arranged over three floors, the property comprises five bedrooms, three receptions, three bathrooms, a utility room and a private garden. It has been

- Five Bedroom House
- Short Let
- Available in September
- Fully Furnished
- Private Garden
- Arranged over Three Floors

£12,500 pcm

Additional tenant charges apply (fees apply to non-AST tenancies only)

Tenancy Agreement Fee: £300

References per Tenant/Guarantor: £60

Inventory check (approx. £100 – £250 inc. VAT)

[chestertons.co.uk/property-to-rent/applicable-fees](https://www.chestertons.co.uk/property-to-rent/applicable-fees)

Minimum Term: months
Deposit Required: £0.00
Local Authority: Lambeth
Council Tax Band: G
EPC Rating: To be confirmed
Furnished

Chestertons Battersea Park & Nine Elms Lettings

59 Battersea Bridge Road

London

SW11 3AU

lettings.batterseapark@chestertons.co.uk

02030408269

[chestertons.co.uk](https://www.chestertons.co.uk)



Fentiman Road, SW8

CAPTURE DATE 06/05/2022 LASER SCAN POINTS 130,015,406

GROSS INTERNAL AREA

228.47 sqm / 2459.23 sqft

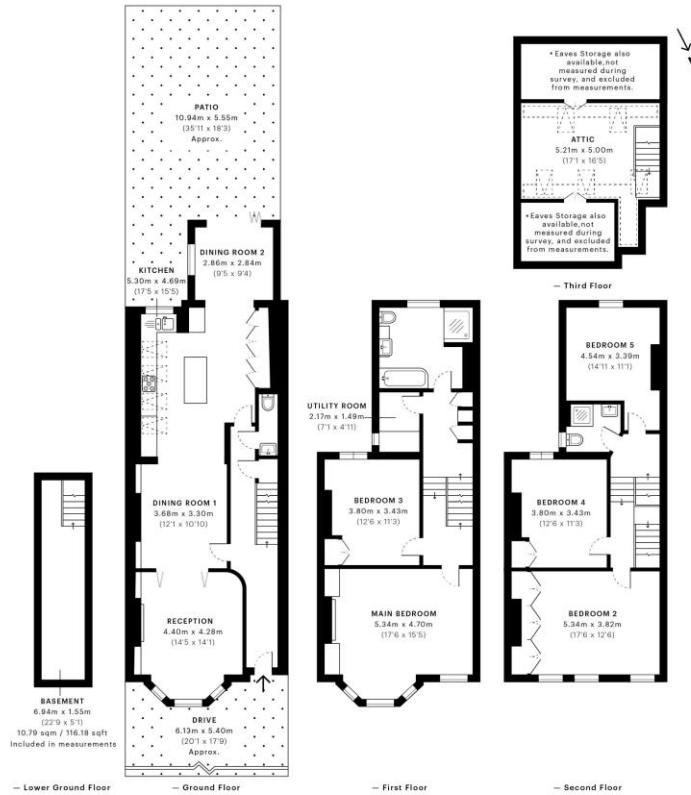

GROSS INTERNAL AREA (GIA)
The footprint of the property
228.47 sqm / 2459.23 sqft

NET INTERNAL AREA (NIA)
Excludes walls and external features
Includes washrooms, restricted head height
207.30 sqm / 2231.36 sqft

EXTERNAL STRUCTURAL FEATURES
Balconies, terraces, verandas etc.
0.00 sqm / 0.00 sqft

RESTRICTED HEAD HEIGHT
Disturbed use area under 1.5m
5.41 sqm / 58.23 sqft



Spec Verified floor plans are produced in accordance with Royal Institution of Chartered Surveyors' Property Measurement Standards. Plots and gardens are illustrative only and excluded from all area calculations. Due to rounding, numbers may not add up precisely. All measurements shown for the individual room lengths and widths are the maximum points of measurements captured in the scan.

IPMS 2B RESIDENTIAL 217.91 sqm / 2345.56 sqft
IPMS 3C RESIDENTIAL 208.40 sqm / 2243.20 sqft

SPIC ID: 62710228c8aD80dc4968a99

Chesterton Global Ltd trading as Chestertons for themselves and for the vendor of this property whose agents they are, give notice that (i) these particulars do not constitute any part of an offer or contract, (ii) all statements contained within these particulars are made without responsibility on the part of Chestertons or the vendor, (iii) whilst made in good faith, none of the statements contained within these particulars are to be relied upon as a statement or representation of fact, (iv) any intending purchasers must satisfy themselves by inspection or otherwise as to the correctness of each of the statements contained within these particulars, (v) the vendor does not make or give either Chestertons or any person in their employment any authority to make or give representation or warranty whatsoever in relation to this property. Wide angle lenses may be used. ©Copyright Chestertons | Chesterton Global Ltd | Registered Office 40 Connaught Street, Hyde Park, London W2 2AB Registered Company Number 05334580.



This paper is 100% recyclable