



Albion Riverside Building
8 Hester Road, SW11

CHESTERTONS





The property is part of Albion Riverside, a river-facing building with a truly unique location consisting of two double bedrooms and two bathrooms with high specification appliances throughout.

It is half a mile from the Kings Road in the prestigious Chelsea neighbourhood, the street which is historically world famous for its little boutiques, cafes and restaurants, and the building is very far from roads which makes the surrounding areas quiet and the air easier to breeze, a true luxury for the capital. Albion Riverside building is located in a charming area near Battersea Park, Fosters & Partners and Vivienne Westwood offices, the Royal College of Arts, The Prince Albert Pub and a number of restaurants. The neighbours and the local employees are very pleasant indeed.

*Disclaimer - The furniture in the advertised photographs may vary from what is currently in the apartment.

- Norman Foster Designed Development
- Two Spacious Double Bedrooms
- Two Bathrooms
- Unfurnished
- 24hr concierge
- Swimming Pool & Gym

Guide Price £1,175,000

Energy Efficiency Rating		Current	Potential
100-109	A		
81-100	B	83	85
69-80	C		
55-68	D		
39-54	E		
21-38	F		
1-20	G		

Not energy efficient - higher running costs

EU Directive 2002/91/EC

England, Scotland & Wales

Tenure: Leasehold 969 years 9 months

Service Charge: £15000

Ground Rent: £275 pa

Local Authority: London Borough of Wandsworth

Council Tax Band: G

Chestertons Battersea Park & Nine Elms Sales

59 Battersea Bridge Road

London

SW11 3AU

batterseapark@chestertons.co.uk

0203 040 8700

chestertons.co.uk

Albion Riverside, SW11

Approximate gross internal area

114.92 sq m / 1237 sq ft

Key :
CH - Ceiling Height

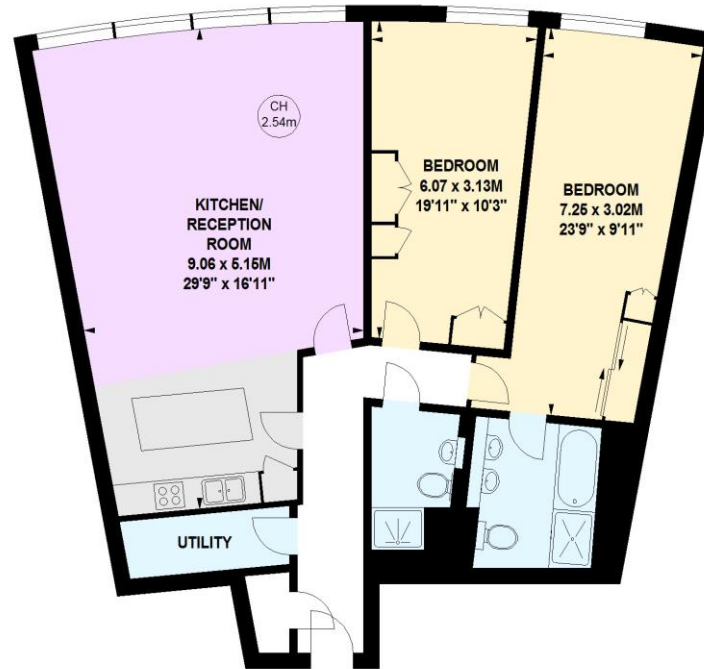

Fifth Floor

The floor plan is not to scale and measurements and areas shown are approximate and therefore should be used for illustrative purposes only.

The plan has been prepared in accordance with the RICS code of Measuring Practice and whilst we have confidence in the information produced, it must be not be relied on.

If there is any aspect of particular importance, you should carry out or commission your own inspection of the property.

Copyright of FeaturePRO.

