



Bear Estate Agents are excited to present this charming three bedroom semi-detached house in Southend-on-Sea. Benefiting from a bay fronted lounge, a spacious open plan layout, a large four piece bathroom, ample off-street parking and a well-presented garden with a summerhouse, this home makes the perfect family purchase.

- Three Bedroom Semi-Detached House
- French Doors to the Rear and Archway to Kitchen
- Bay Fronted Master Bedroom with Built-in Wardrobes
- Well-Presented Garden with Summerhouse and External WC
- Double Glazing and Gas Central Heating
- Bay Fronted Lounge with Archway to Dining Room
- Ground Floor WC and Understair Storage
- Large Four Piece Family Bathroom
- Off-Street Parking For Two/Three Vehicles
- Close to Schools, Parks, Train Links and Amenities

## Park Lane

Southend-on-Sea

**£425,000**





# Park Lane



The ground floor accommodation comprises a welcoming entrance hall with under stair storage, a bay fronted lounge with an open archway into the dining room, French doors leading out to the garden and a further archway into the kitchen, which provides a courtesy back door. A convenient WC completes the ground floor. Upstairs, the first floor hosts a bay fronted master bedroom with built-in wardrobes, a second double bedroom, a single bedroom and a generously sized four piece family bathroom. There is also useful storage on the landing. Externally, the property boasts a delightful rear garden with a garden office (fully insulated with power) and an external storage room which houses the boiler (previously a WC), as well as off-street parking for two to three vehicles to the front. Further benefits include double glazing and gas central heating throughout.

The property is located on Park Lane in Southend-on-Sea, within catchment for Porters Grange Primary School and Southchurch High School. Families will enjoy the proximity to Southchurch Hall Gardens and Southchurch Park, while excellent amenities, bus links and Southend East Train Station are all close to hand.

## Three Bedroom Semi-Detached House

### Entrance Hall

#### Lounge

16'4 x 13'4

### Dining Room

12'11 x 11'2

### Kitchen

9'6 x 7'10

### WC

4'11 x 2'8

### Landing

### Bedroom One

16'5 x 13'4

### Bedroom Two

13'0 x 8'2

### Bedroom Three

8'0 x 7'4

### Bathroom

11'0 x 7'5

### Garden

### External Storage

Houses the boiler.

### Garden Office

14'10 x 9'5

Has power and is fully insulated.

### Off-Street Parking



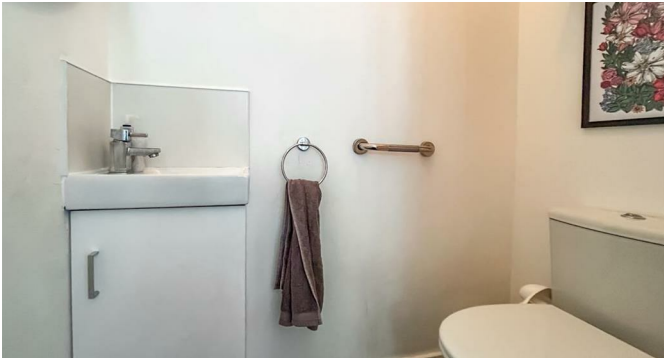



## Floor Plan

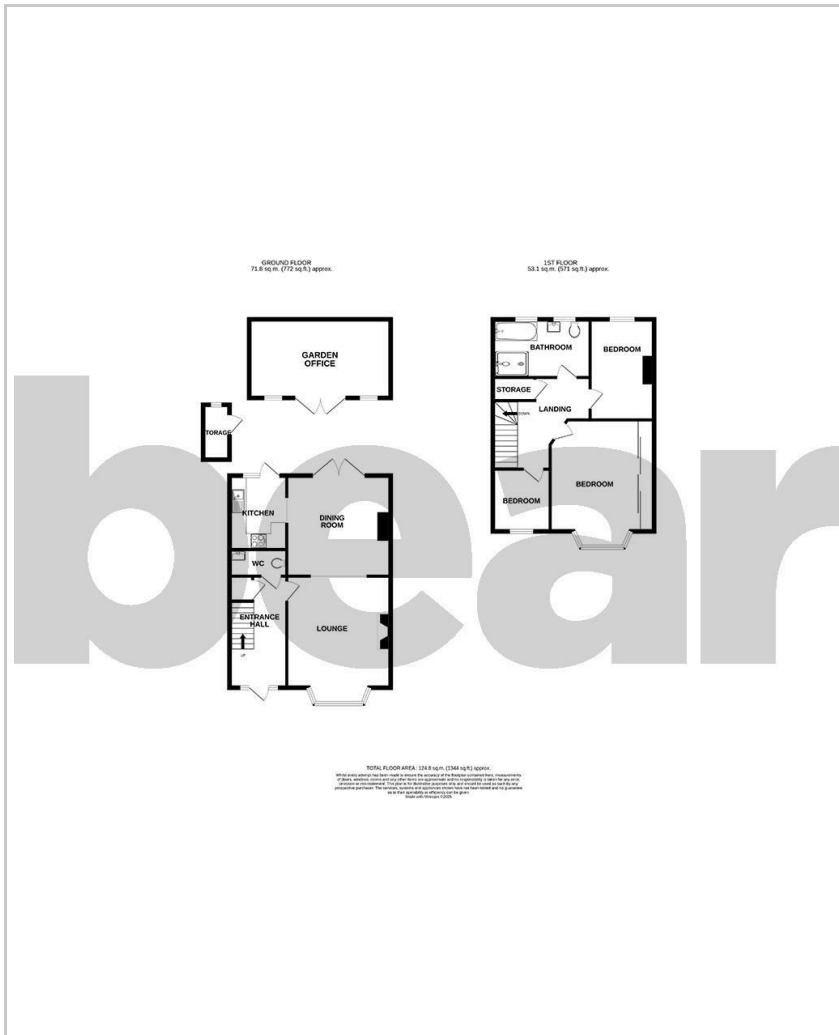

## Area Map

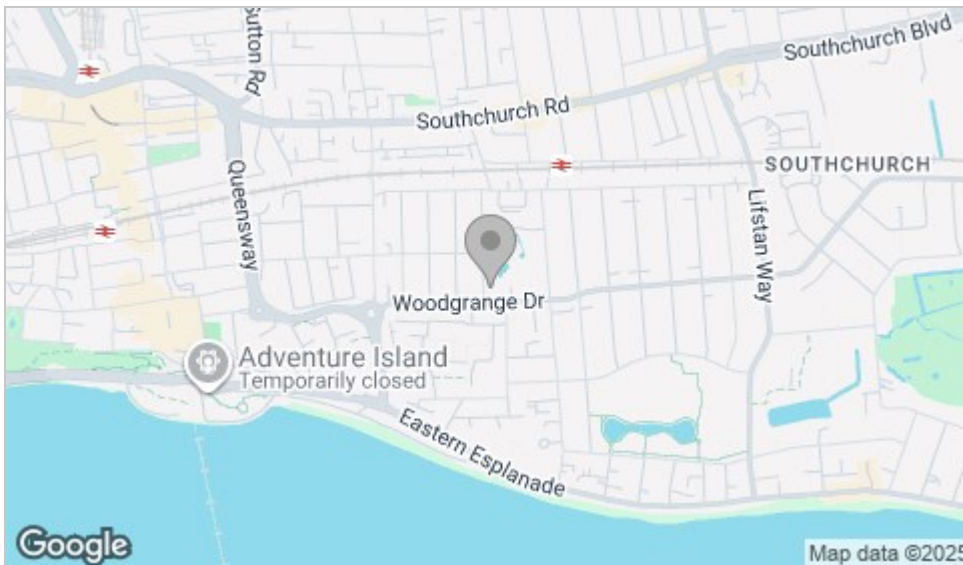

## Viewing

Please contact our Southend-on-Sea Office on 01702 811211 if you wish to arrange a viewing appointment for this property or require further information.

These particulars, whilst believed to be accurate are set out as a general outline only for guidance and do not constitute any part of an offer or contract. Intending purchasers should not rely on them as statements of representation of fact, but must satisfy themselves by inspection or otherwise as to their accuracy. No person in this firm's employment has the authority to make or give any representation or warranty in respect of the property.

204 Woodgrange Drive, Southend-on-Sea, Essex, SS1 2SJ

Office: 01702 811211 [info@bearestateagents.co.uk](mailto:info@bearestateagents.co.uk) <https://www.bearestateagents.co.uk>

## Energy Efficiency Graph

