



Albert Road

Rochford

£360,000 Price Guide



* Guide Price £360,000 - £400,000 * Versatile detached bungalow offering generous living space, a large rear garden and plenty of off-street parking space. Situated on a popular residential road in Rochford within easy reach of local schools, amenities and travel links.

- Detached Bungalow
- Versatile Bedroom/Lounge/Diner
- Good-Sized Kitchen
- Bright and Airy Lounge/Diner
- Two Generous Bedrooms
- Three Piece Bathroom
- Large Rear Garden
- Plenty of Off-Street Parking to the Front
- Double Glazing
- Gas Central Heating

Albert Road



Bear Estate Agents are excited to welcome to the market, this unique detached bungalow which offers versatile living accommodation throughout. Inside, you will find an open plan 'L' shaped bedroom which was the original lounge/diner, a good-sized kitchen which opens into a bright and airy conservatory/lounge/diner, a bay fronted bedroom to the front which is complemented by a feature fireplace, a third bedroom and a three piece bathroom. Further benefits include a large laid to lawn rear garden, plenty of off-street parking space to the front, double glazing and gas central heating.

Albert Road is a popular residential road in Rochford, located within easy reach of local schools, parks and amenities, whilst bus connections and Rochford Train Station are close to hand.

Detached Bungalow

Entrance Hall

Lounge/Diner
18'3 x 8'10

Kitchen
10'7 x 9'2

Bedroom One (original lounge/diner)
10'10>9'3 x 10'5>8'8

Bedroom Two
13'4 x 11'5

Bedroom Three
9'7 x 8'9

Bathroom

Garden

Off-Street Parking





Floor Plan

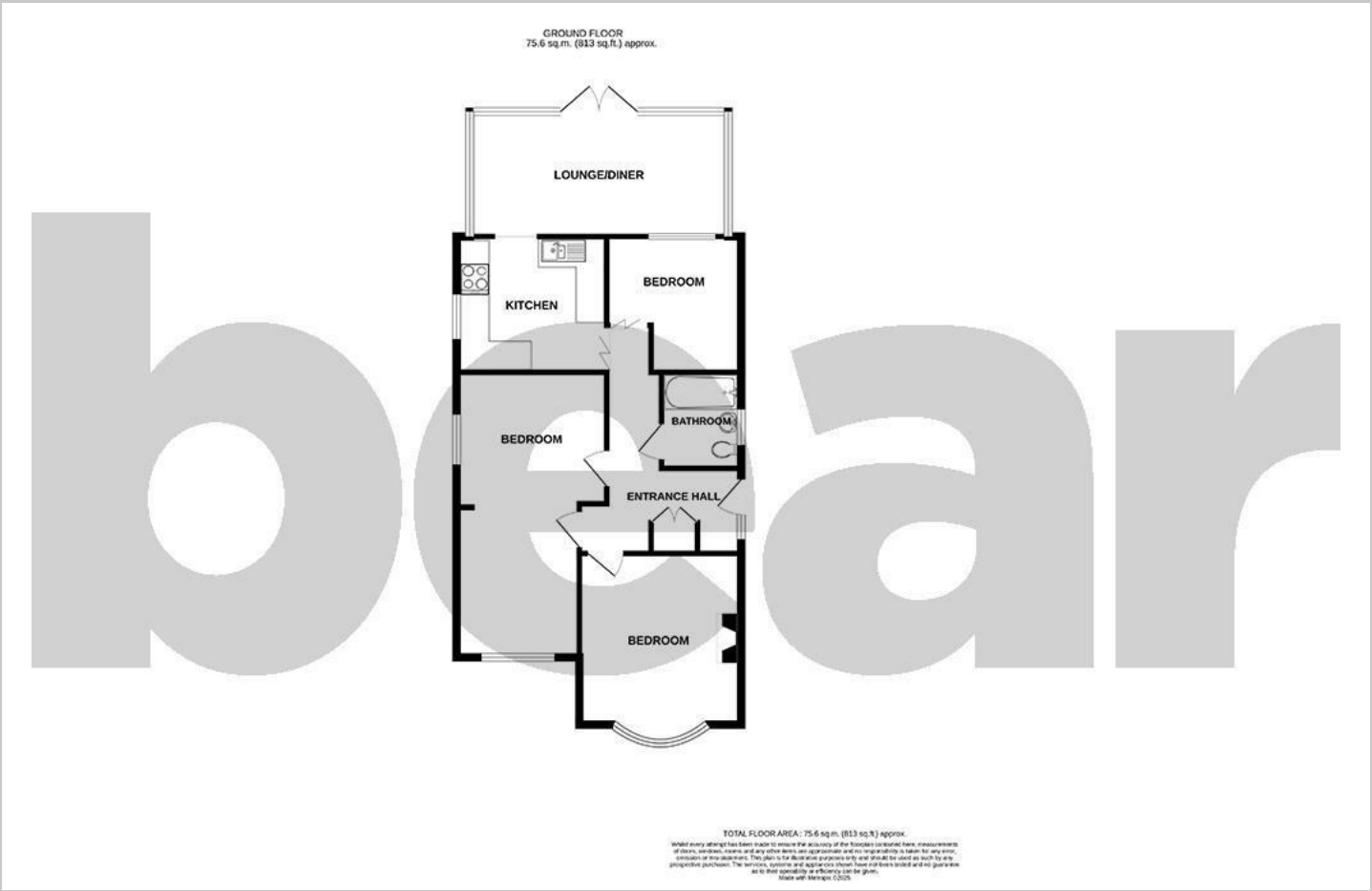

Area Map

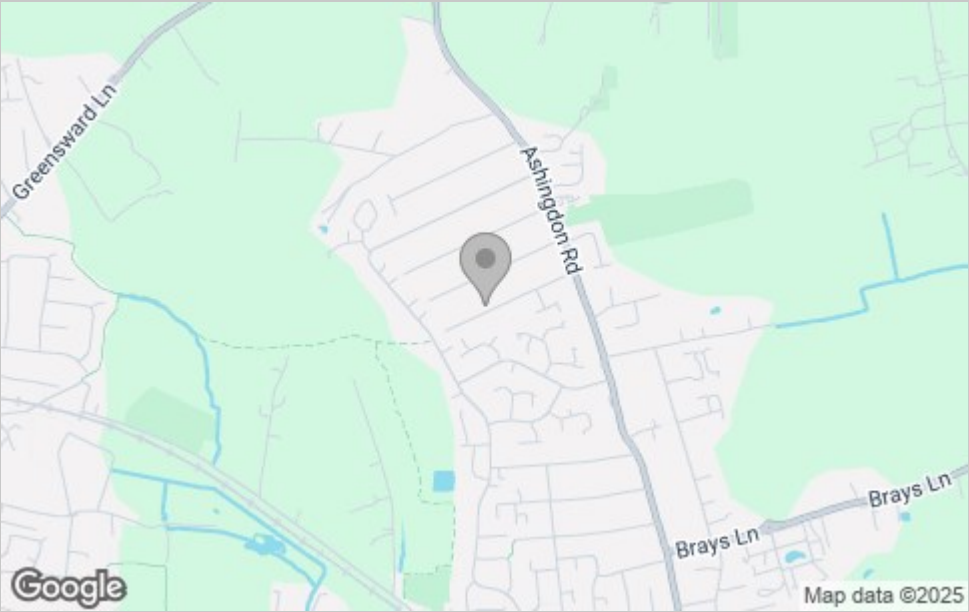

Viewing

Please contact our Southend-on-Sea Office on 01702 811211 if you wish to arrange a viewing appointment for this property or require further information.

These particulars, whilst believed to be accurate are set out as a general outline only for guidance and do not constitute any part of an offer or contract. Intending purchasers should not rely on them as statements of representation of fact, but must satisfy themselves by inspection or otherwise as to their accuracy. No person in this firm's employment has the authority to make or give any representation or warranty in respect of the property.

204 Woodgrange Drive, Southend-on-Sea, Essex, SS1 2SJ

Office: 01702 811211 info@bearestateagents.co.uk <https://www.bearestateagents.co.uk>

Energy Efficiency Graph

