

bear

Estate Agents



* NEWLY REFURBISHED - NO ONWARD CHAIN
* Generous two bedroom flat in the heart of Westcliff-on-Sea close to travel networks, favoured amenities, Southend Hospital within a 10 minute walk and schools. An ideal purchase for first time buyers wanting to get on the property ladder or buy to let investors.

- Partly Refurbished First Floor Flat
- Three Piece Shower Room
- Central Location Close to Bus Links
- Not Far From Popular Amenities
- Ideal for First Time Buyers and Buy to Let Investors
- Two Well-Proportioned Bedrooms
- Spacious Lounge
- Access to The A127 and Train Lines
- Close Proximity to Schools and Parks
- No Onward Chain

Southview Drive

Westcliff-on-Sea

£175,000



Southview Drive



Positioned in the centre of Westcliff-on-Sea is this generous two bedroom first floor flat. Just minutes away, you will find convenient bus links, whilst beneficial train lines are close by with direct access to London. Favoured amenities are located along London Road, as well as Southend High Street which are both within close proximity. Also within the area, are popular schools, Chalkwell Park and the seafront with its sandy beaches.

The flat is located on the first floor and comprises a spacious lounge, a fitted kitchen, two bedrooms and a three piece shower room. The property has been newly refurbished, perfect for someone looking to move straight in.

Two Bedroom First Floor Flat

Entrance Hall

Lounge

16'2 x 7'8

Kitchen

12'1 x 4'7

Bedroom One

9'1 x 8'7

Bedroom Two

8'8 x 6'7

Three Piece Shower Room

7'5 x 3'3

Agents Notes:

Lease charges TBC



Floor Plan

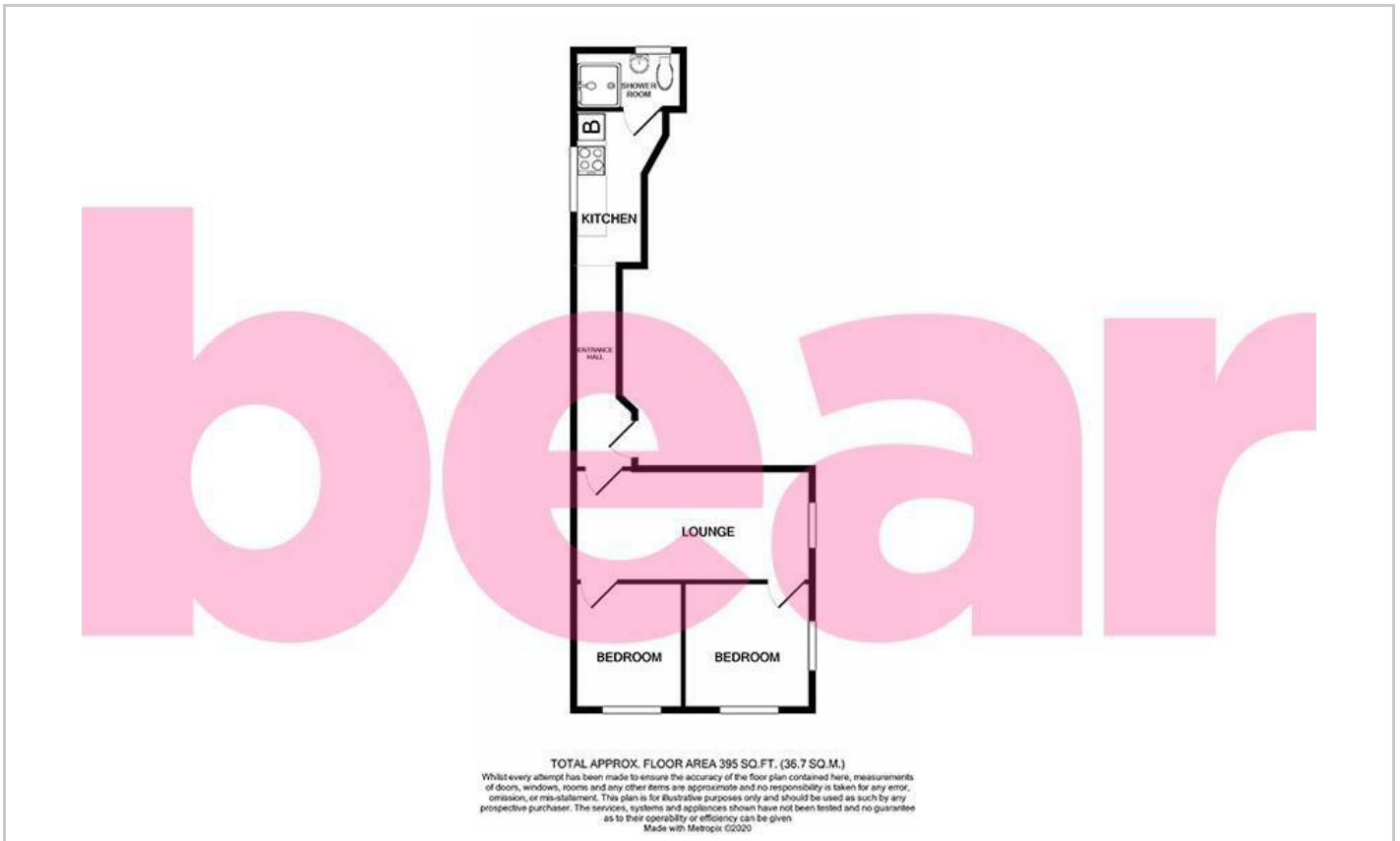

Area Map

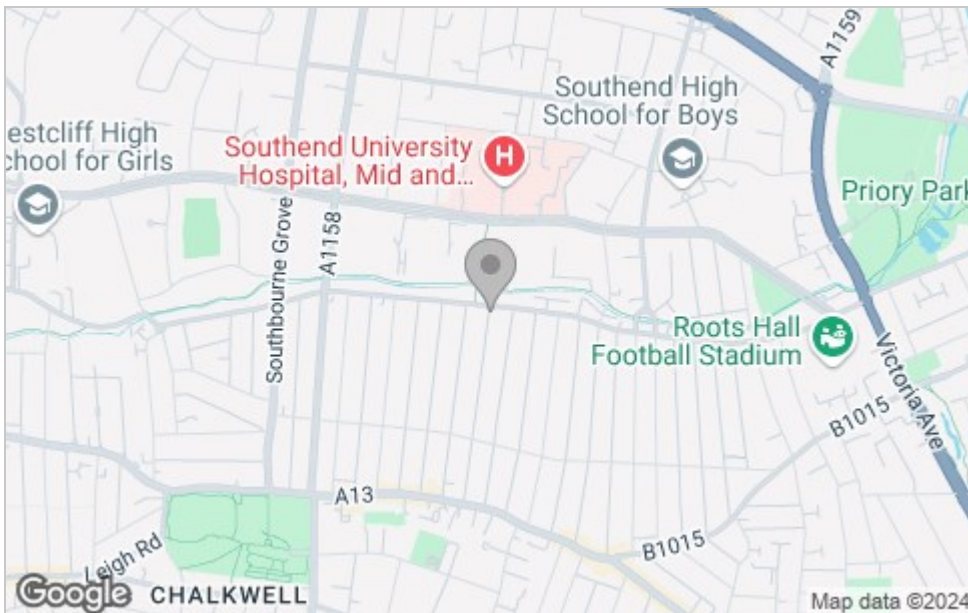

Viewing

Please contact our Southend-on-Sea Office on 01702 811211 if you wish to arrange a viewing appointment for this property or require further information.

These particulars, whilst believed to be accurate are set out as a general outline only for guidance and do not constitute any part of an offer or contract. Intending purchasers should not rely on them as statements of representation of fact, but must satisfy themselves by inspection or otherwise as to their accuracy. No person in this firm's employment has the authority to make or give any representation or warranty in respect of the property.

204 Woodgrange Drive, Southend-on-Sea, Essex, SS1 2SJ

Office: 01702 811211 info@bearestateagents.co.uk <https://www.bearestateagents.co.uk>

Energy Efficiency Graph

