

# bear

*Estate Agents*



**Whitegate Road**

**Southend-on-Sea**

**£235,000**

Price Guide



# Whitegate Road



## Description

\*£235,000-£255,000\* \* No Onward Chain \* Share of Freehold \* Well presented first floor flat accommodating three bedrooms, a bay fronted lounge and a communal rear garden. Situated in the centre of Southend-on-Sea just a stones throw away from the high street, seafront, travel networks and more.

- No Onward Chain
- First Floor Flat
- Bay Fronted Lounge
- Three Piece Bathroom
- Double Glazing
- Share of Freehold
- Long Lease
- Three Bedrooms
- Communal Rear Garden
- Gas Central Heating





# Floor Plan

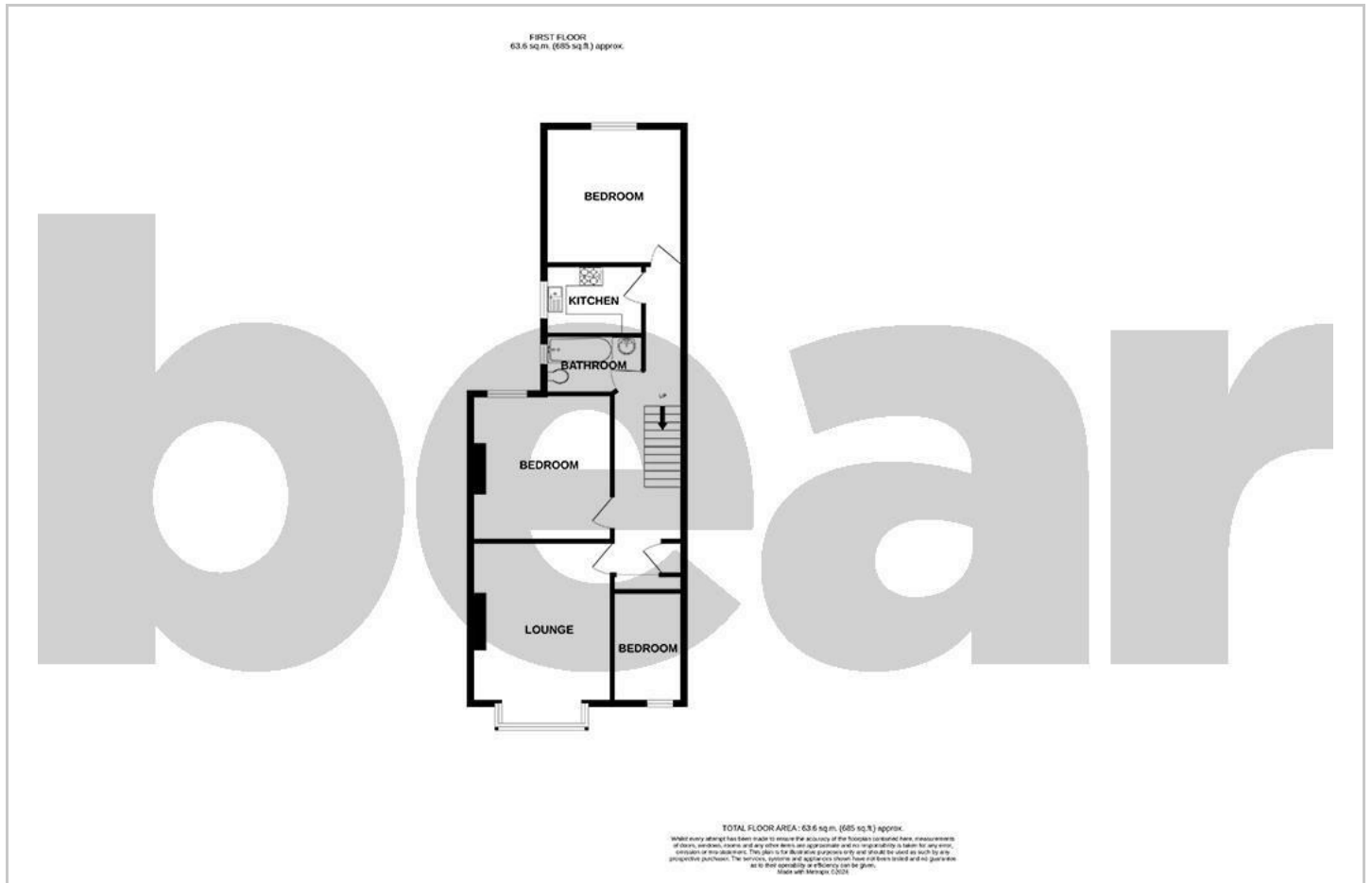

# Area Map

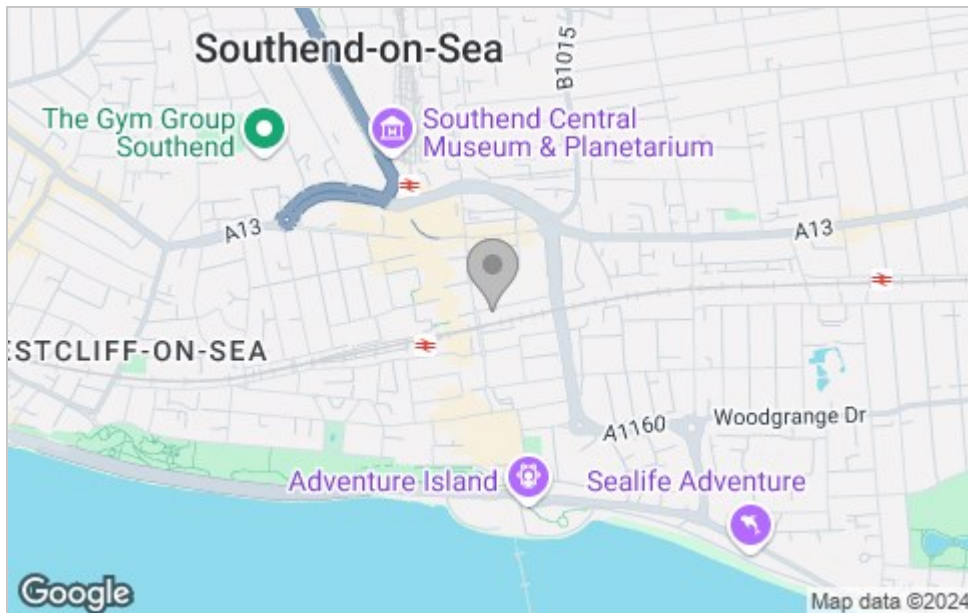

# Viewing

Please contact our Southend-on-Sea Office on 01702 811211 if you wish to arrange a viewing appointment for this property or require further information.

These particulars, whilst believed to be accurate are set out as a general outline only for guidance and do not constitute any part of an offer or contract. Intending purchasers should not rely on them as statements of representation of fact, but must satisfy themselves by inspection or otherwise as to their accuracy. No person in this firm's employment has the authority to make or give any representation or warranty in respect of the property.

204 Woodgrange Drive, Southend-on-Sea, Essex, SS1 2SJ

Office: 01702 811211 [info@bearestateagents.co.uk](mailto:info@bearestateagents.co.uk) <https://www.bearestateagents.co.uk>

# Energy Efficiency Graph

