



St. Benets Road

Southend-on-Sea

£300,000

Price Guide



St. Benets Road



Description

** STUNNING VALUE & NO ONWARD CHAIN - GUIDE PRICE 300,000-£325,000 ** Bear Estate Agents are delighted to bring to the market this striking semi detached bungalow. The property offers two double bedrooms, kitchen/diner and well maintained private rear garden. There is also the added benefit of an independent driveway. Located within a pleasant area, close to Prittlewell station, and the iconic St Mary's church. Southend city centre is also in walking distance as well as bus routes.

- Semi-Detached Bungalow
- Garage To Rear
- Shower Room
- Close To Prittlewell Station
- Spacious Living
- Off Street Parking
- Two Double Bedrooms
- Double Glazing
- Gas Central Heating
- Rear Garden



Southend-on-Sea



Floor Plan

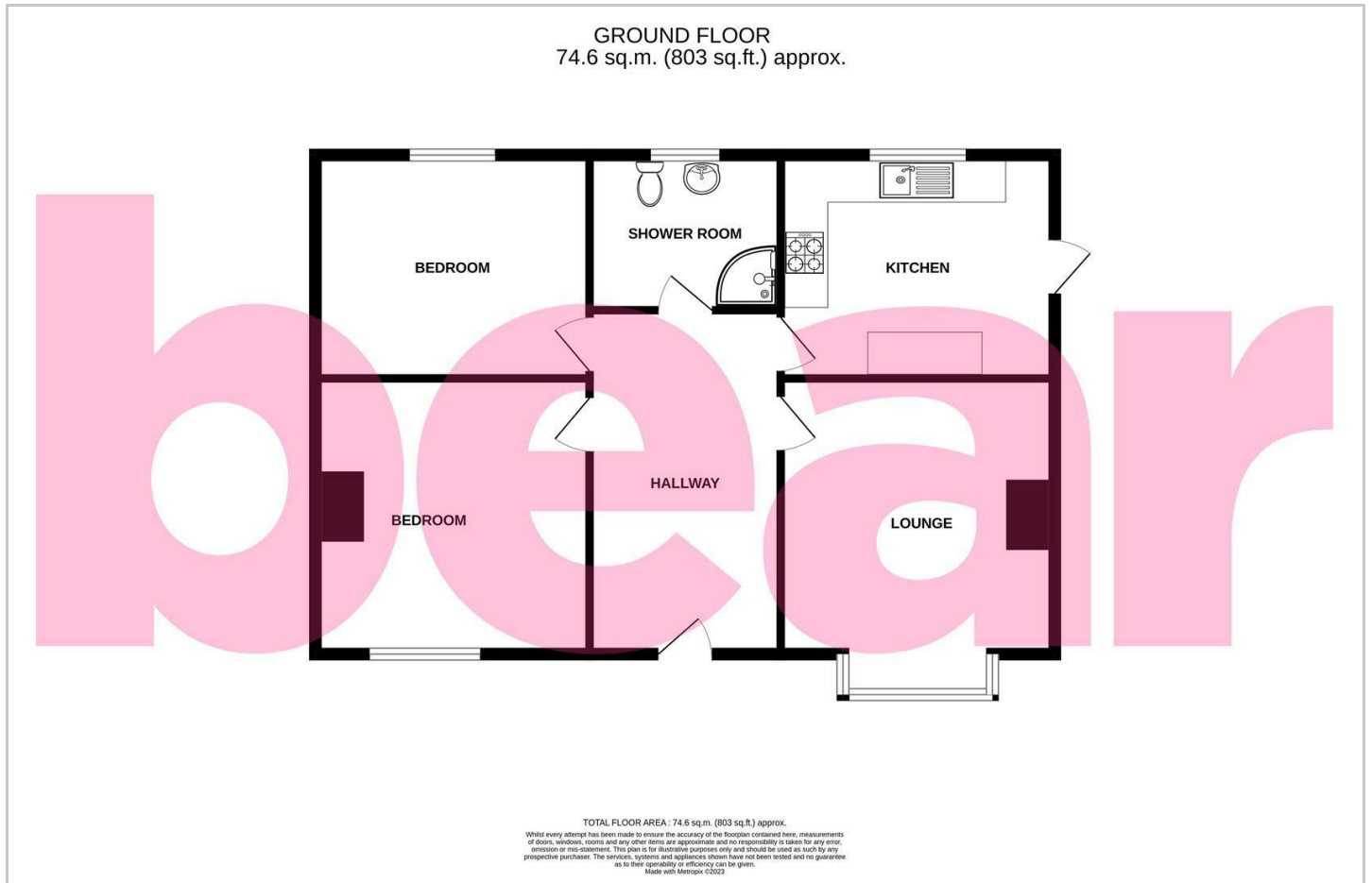

Area Map

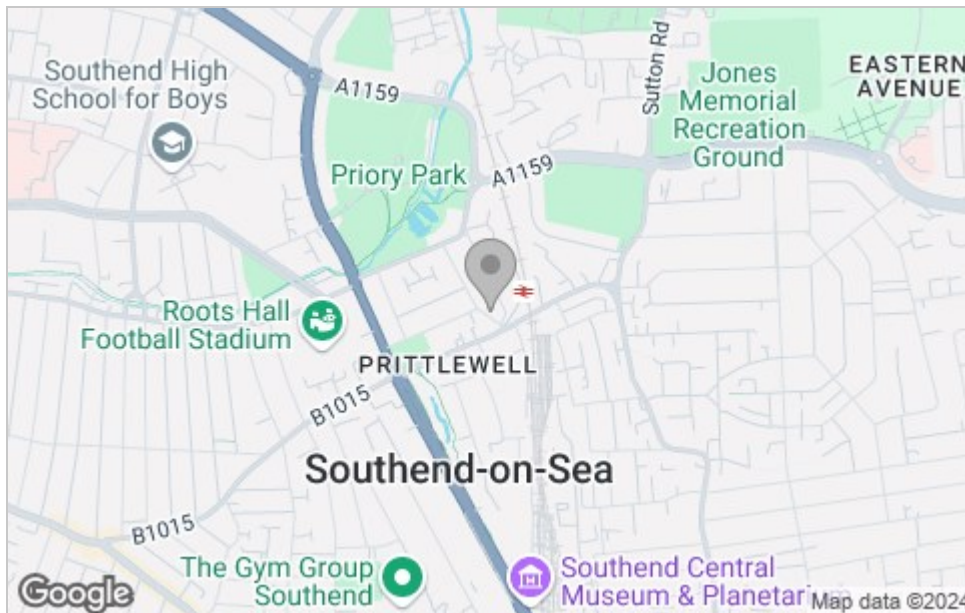

Energy Efficiency Graph

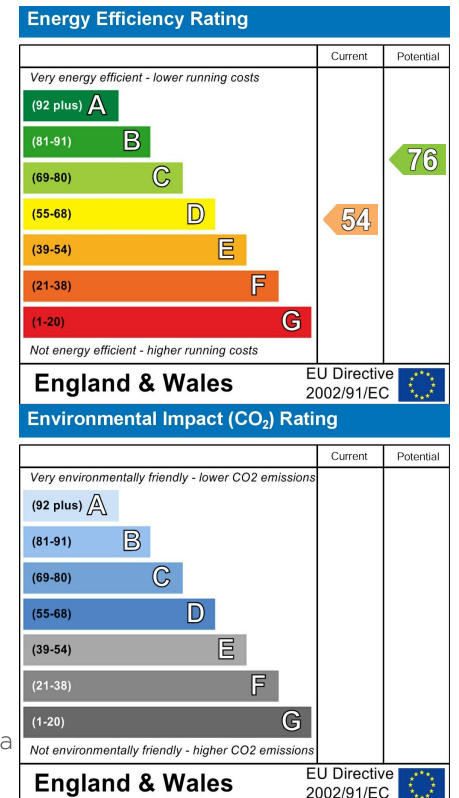

Viewing

Please contact our Southend-on-Sea Office on 01702 811211 if you wish to arrange a viewing appointment for this property or require further information.

These particulars, whilst believed to be accurate are set out as a general outline only for guidance and do not constitute any part of an offer or contract. Intending purchasers should not rely on them as statements of representation of fact, but must satisfy themselves by inspection or otherwise as to their accuracy. No person in this firm's employment has the authority to make or give any representation or warranty in respect of the property.

204 Woodgrange Drive, Southend-on-Sea, Essex, SS1 2SJ

Office: 01702 811211 info@bearestateagents.co.uk <https://www.bearestateagents.co.uk>