

# bear

*Estate Agents*



## Fairfax Drive

Westcliff-on-Sea

**£200,000**

Price Guide

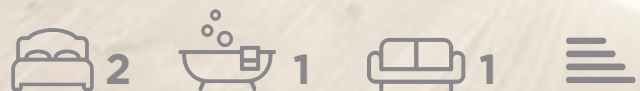

# Fairfax Drive



## Description

\* £200,000 - £225,000 \* No Onward Chain \* Newly constructed two bedroom top floor flat boasting a long lease, one off-street parking space and modern interiors. Positioned in the centre of Westcliff-on-Sea close to amenities, travel links, Southend Hospital and schools.

- Presented with No Onward Chain
- Modern Kitchen/Living Room
- Three Piece Shower Room
- Office Area in the Entrance Hall
- Electric Heating
- Newly Built Top Floor Flat
- Two Bedrooms
- Utility Cupboard
- Double Glazing
- One Off-Street Parking Space





# Floor Plan

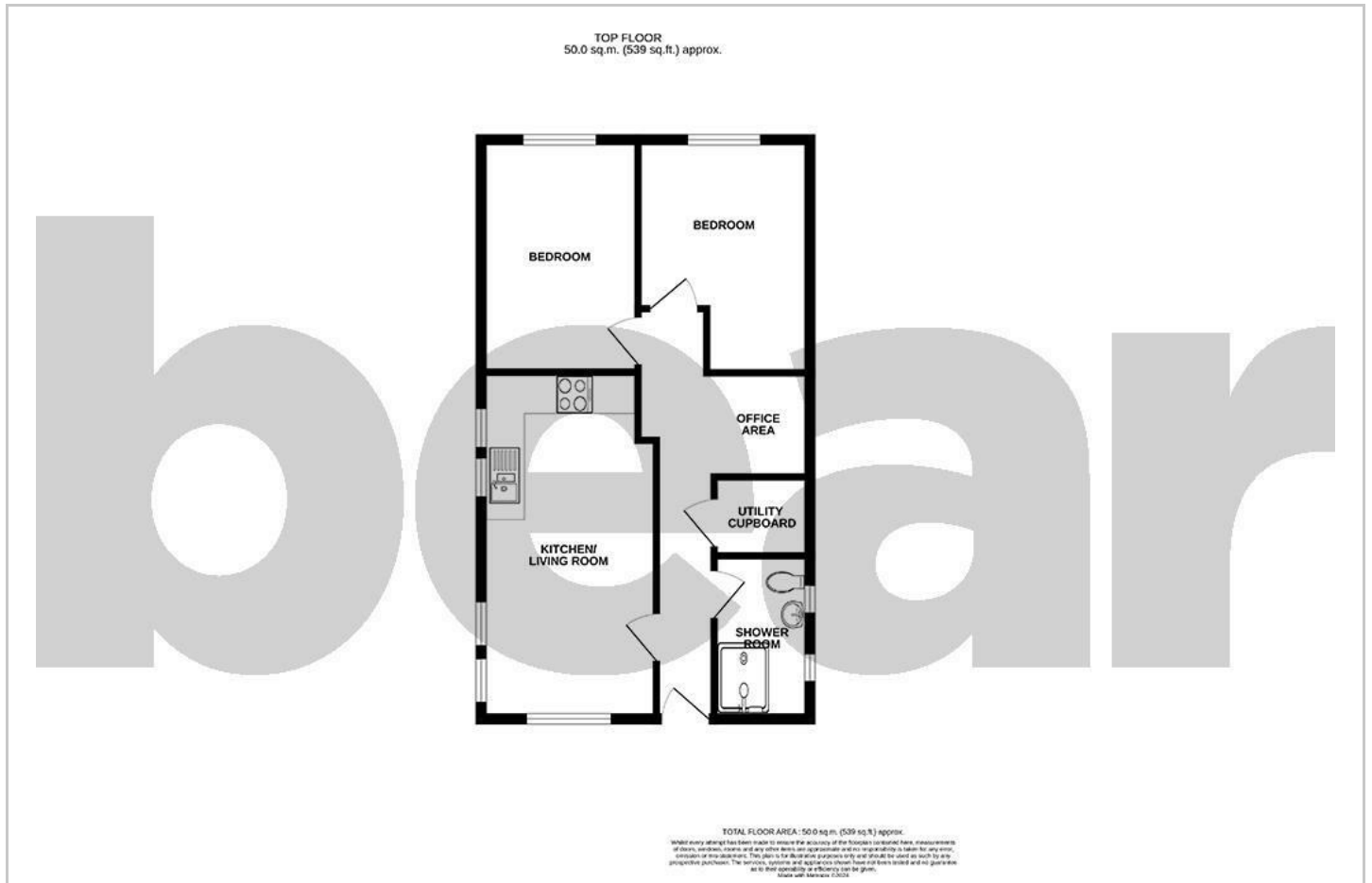

# Area Map

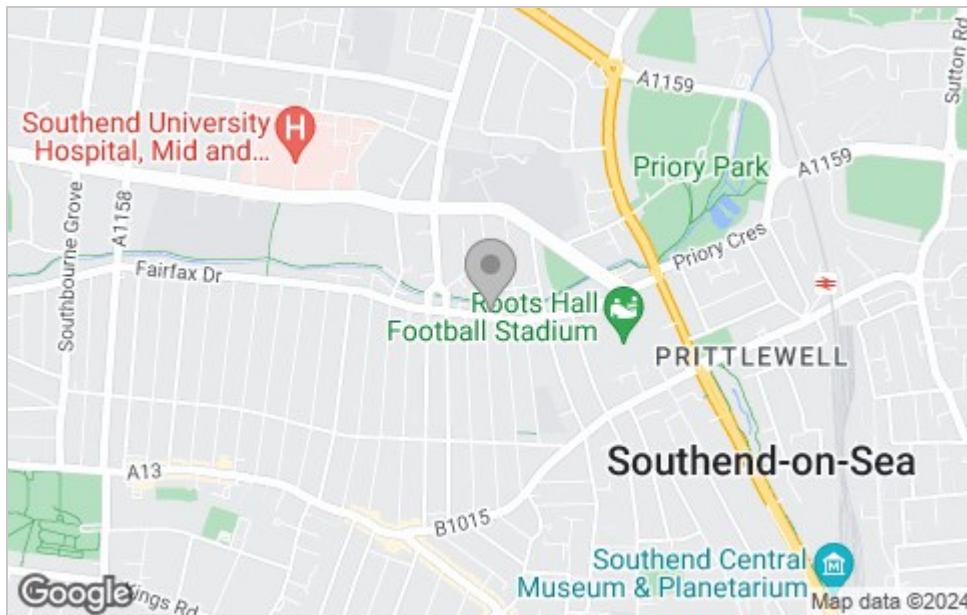

# Energy Efficiency Graph

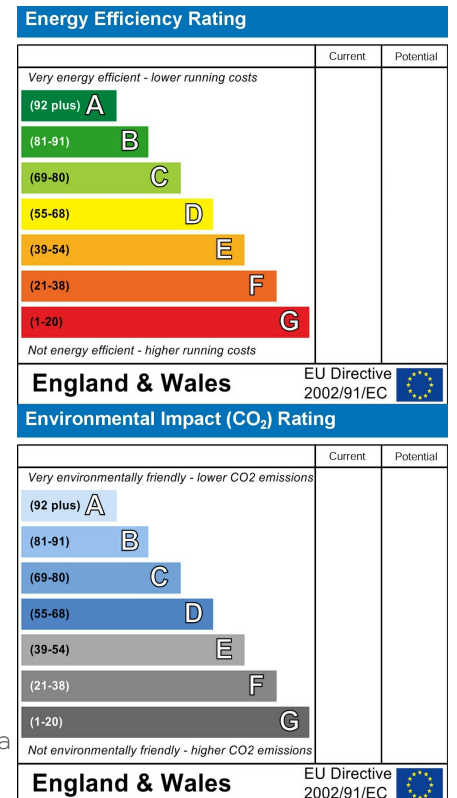

# Viewing

Please contact our Southend-on-Sea Office on 01702 811211 if you wish to arrange a viewing appointment for this property or require further information.

These particulars, whilst believed to be accurate are set out as a general outline only for guidance and do not constitute any part of an offer or contract. Intending purchasers should not rely on them as statements of representation of fact, but must satisfy themselves by inspection or otherwise as to their accuracy. No person in this firm's employment has the authority to make or give any representation or warranty in respect of the property.

204 Woodgrange Drive, Southend-on-Sea, Essex, SS1 2SJ

Office: 01702 811211 [info@bearestateagents.co.uk](mailto:info@bearestateagents.co.uk) <https://www.bearestateagents.co.uk>