



\* £240,000 - £250,000 \* One double bedroom ground floor flat in Shoeburyness offering communal off-street parking and a garden. Benefits from having a beautiful open plan living space and ample storage. Situated in the sought after Garrison close to amenities, travel links and the seafront.

- Ground Floor Flat
- Beautiful Open Plan Kitchen/Living Room
- One Double Bedroom
- Three Piece Bathroom
- Ample Storage
- Communal Garden
- Communal Parking
- Double Glazing
- Gas Central Heating
- Long Lease

## St. Georges Lane

Shoeburyness

**£240,000**

Price Guide



# St. Georges Lane



Bear Estate Agents are delighted to bring to the market, this ground floor flat, positioned on the highly sought after Garrison. Close by, you will find the award winning East Beach, along with ideal amenities and convenient travel links, including Shoeburyness Train Station which guarantees you a seat on all trains travelling to London.

The flat is beautifully presented throughout and accommodates a large, open plan kitchen/living room that benefits from having a bay window and integrated appliances, one double bedroom, ample storage and a three piece bathroom. Communal parking and gardens are an added benefit, along with double glazing and gas central heating.

## **One Bedroom Ground Floor Flat**

### **Entrance Hall**

### **Kitchen/Living Room**

19'4 x 19'0

### **Bedroom**

10'10 x 9'3

### **Bathroom**

7'3 x 6'7

### **Storage**



## Floor Plan

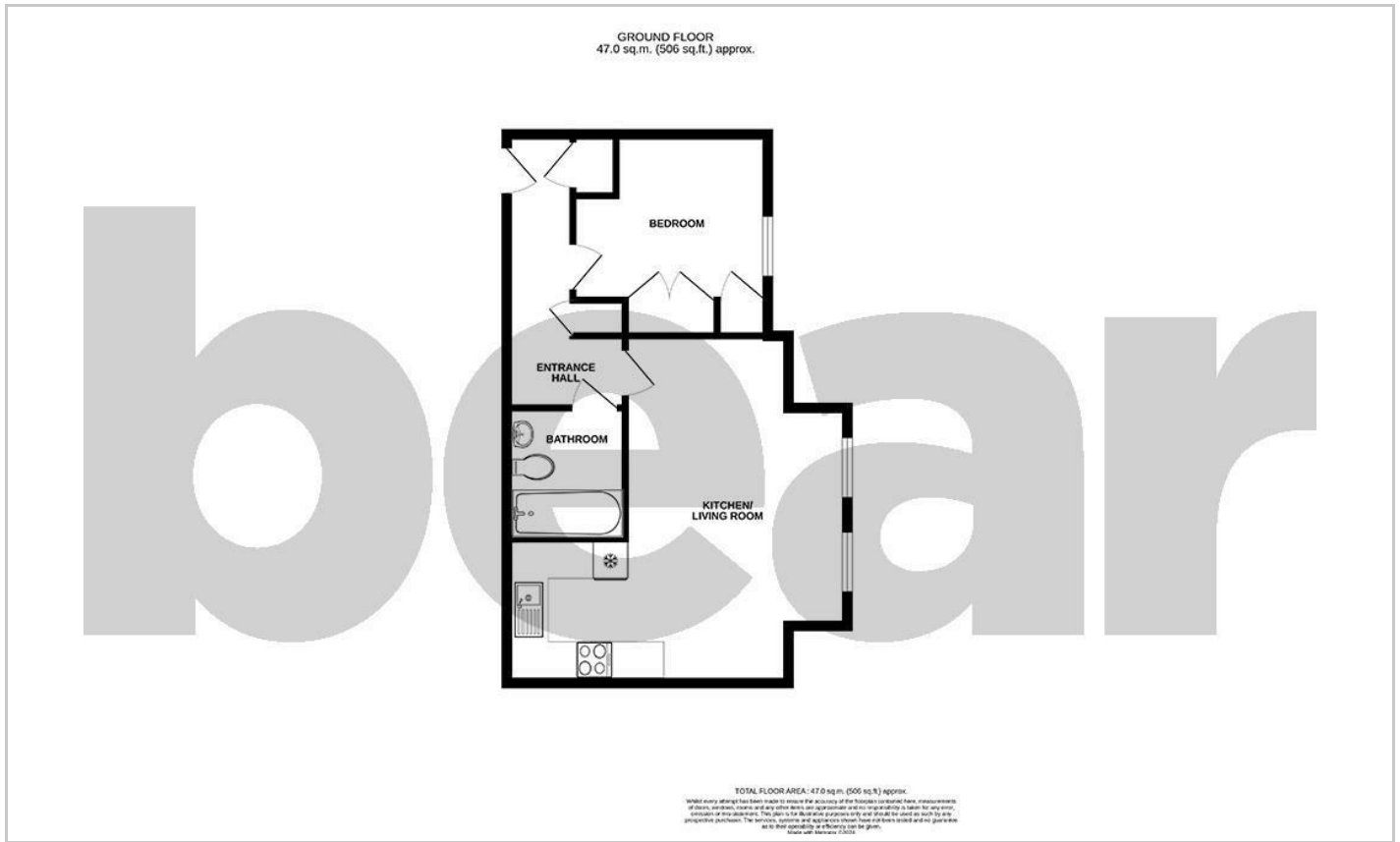

## Area Map



## Viewing

Please contact our Southend-on-Sea Office on 01702 811211 if you wish to arrange a viewing appointment for this property or require further information.

These particulars, whilst believed to be accurate are set out as a general outline only for guidance and do not constitute any part of an offer or contract. Intending purchasers should not rely on them as statements of representation of fact, but must satisfy themselves by inspection or otherwise as to their accuracy. No person in this firm's employment has the authority to make or give any representation or warranty in respect of the property.

204 Woodgrange Drive, Southend-on-Sea, Essex, SS1 2SJ

Office: 01702 811211 [info@bearestateagents.co.uk](mailto:info@bearestateagents.co.uk) <https://www.bearestateagents.co.uk>

## Energy Efficiency Graph

