



Waterloo Road

Shoeburyness

£300,000 Price Guide



* £300,000 - £325,000 * Two double bedroom semi-detached house in Shoeburyness offering a beautiful lounge, open plan kitchen/diner, a ground floor WC/utility room and a well-landscaped garden. Well-appointed within easy reach of favoured amenities and the seafront.

- Semi-Detached Family Home
- Three Piece Family Bathroom
- Beautiful Bay Fronted Lounge
- Sizeable Loft Room
- Open Plan Kitchen/Diner
- Beautifully Landscaped Rear Garden
- WC/Utility Room
- Double Glazing
- Two Double Bedrooms
- Gas Central Heating



Waterloo Road



Bear Estate Agents are excited to bring to the market, this two bedroom semi-detached home in Shoeburyness. Inside, the accommodation is well presented throughout and comprises beautiful bay fronted lounge, an open plan kitchen/diner and a WC/Utility room on the ground floor. Two double bedrooms and a three piece bathroom can be found on the first floor. Stairs from the master bedroom lead up to a sizeable loft room. To the rear, you will find a beautifully landscaped rear garden.

Waterloo Road is well-appointed within minutes of ideal amenities and convenient bus links. Both Shoeburyness and Thorpe Bay Train Stations are of equal distance, guaranteeing you a seat on all trains travelling to London. Also within the area, there are well-regarded schools, local parks and picturesque, award winning blue flag beaches.

Two Bedroom Semi-Detached House

Entrance Hall

Lounge

13'8 x 11'3

Kitchen/Diner

16'7 x 11'10

WC/Utility Room

9'10 x 3'11

Landing

Bedroom One

13'10 x 10'8

Bedroom Two

12'0 x 8'10

Three Piece Bathroom

8'10 x 8'0

Loft Room

Garden

Shoeburyness



Floor Plan

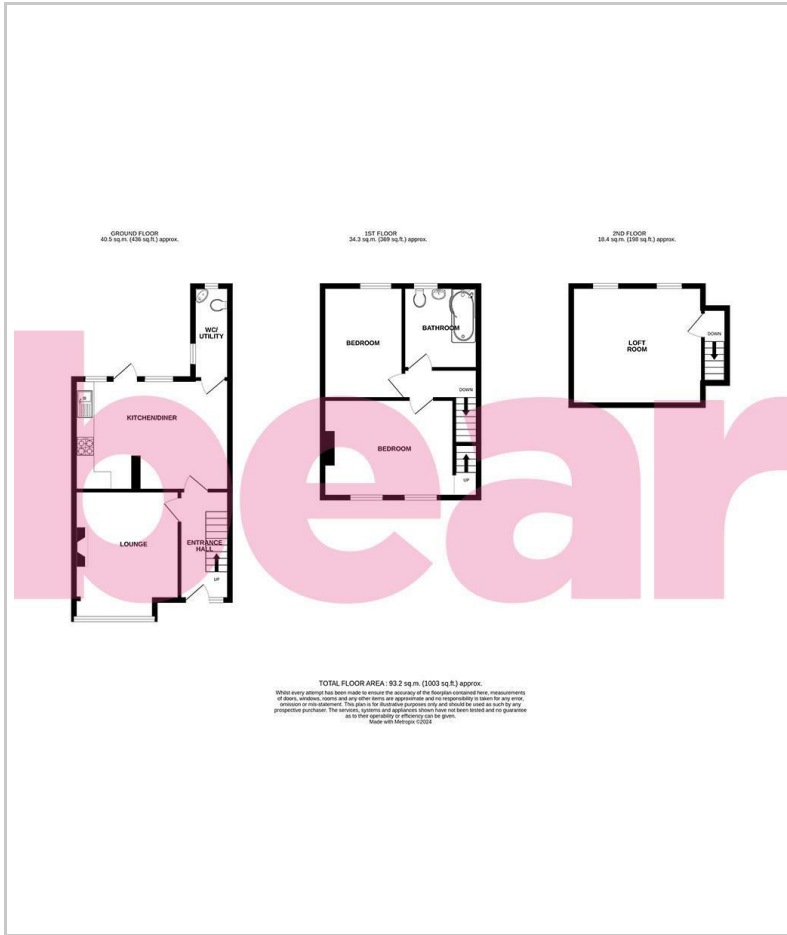

Area Map



Viewing

Please contact our Southend-on-Sea Office on 01702 811211 if you wish to arrange a viewing appointment for this property or require further information.

These particulars, whilst believed to be accurate are set out as a general outline only for guidance and do not constitute any part of an offer or contract. Intending purchasers should not rely on them as statements of representation of fact, but must satisfy themselves by inspection or otherwise as to their accuracy. No person in this firm's employment has the authority to make or give any representation or warranty in respect of the property.

204 Woodgrange Drive, Southend-on-Sea, Essex, SS1 2SJ

Office: 01702 811211 info@bearestateagents.co.uk <https://www.bearestateagents.co.uk>

Energy Efficiency Graph

