



** BRAND NEW LEASE ON COMPLETION OF SALE - GUIDE PRICE £190,000-£210,000 - GREAT LOCATION ** Two bedroom first floor flat offering a large bay fronted lounge and kitchen, as well as access to a communal rear garden. Ideally located close to ideal amenities, schools, bus links and Westcliff Train Station.

- Good-Sized First Floor Flat
- Good Condition Throughout
- Bay Fronted Lounge
- Spacious Kitchen
- Two Bedrooms
- Three Piece Bathroom
- Access to the Loft
- Communal Garden
- New Lease on Completion of Sale
- Double Glazing and Gas Central Heating

Burdett Avenue

Westcliff-on-Sea

£190,000

Price Guide



Burdett Avenue



Burdett Avenue is a quiet residential road in Westcliff-on-Sea just minutes from London Road and Hamlet Court Road, both offering an abundance of favoured shops and eateries. There are bus links close to hand, as well as Westcliff Train Station serving London Fenchurch Street Station on the C2C line. Within the area, you will also find well-regarded schools, the seafront and parks.

The flat is well presented throughout and offers a bay fronted lounge, plus a spacious kitchen. There is one double bedroom, a single bedroom and a three piece bathroom within. Further benefits include access to the loft, a communal garden, double glazing and gas central heating.

Two Bedroom First Floor Flat

Lounge

14'8 x 10'10

Kitchen

13'3 x 11'2

Bedroom One

15'10 x 12'6

Bedroom Two

8'8 x 5'10

Three Piece Bathroom

5'11 x 5'9

Storage

Loft Access

Communal Garden



Floor Plan

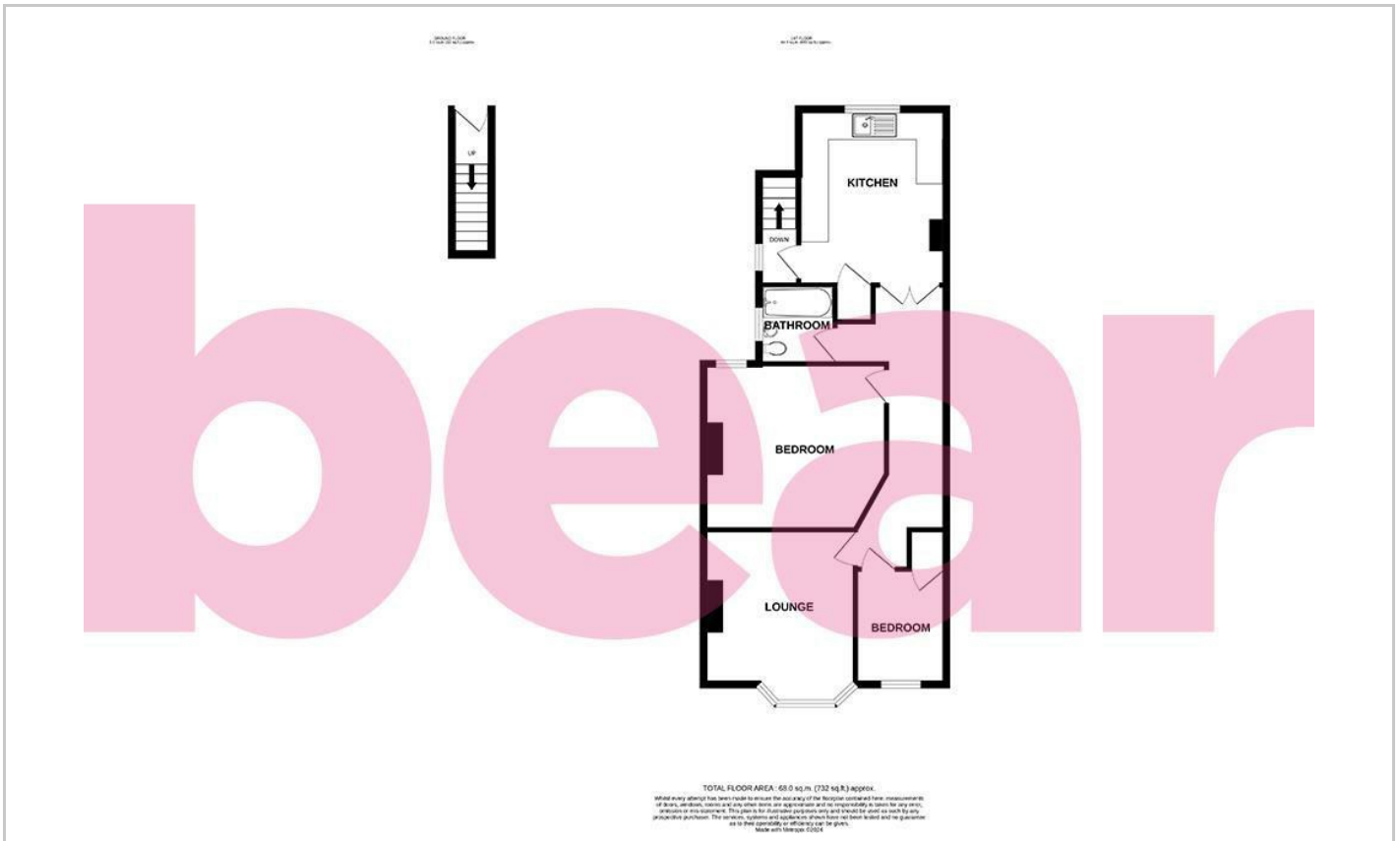

Area Map



Viewing

Please contact our Southend-on-Sea Office on 01702 811211 if you wish to arrange a viewing appointment for this property or require further information.

These particulars, whilst believed to be accurate are set out as a general outline only for guidance and do not constitute any part of an offer or contract. Intending purchasers should not rely on them as statements of representation of fact, but must satisfy themselves by inspection or otherwise as to their accuracy. No person in this firm's employment has the authority to make or give any representation or warranty in respect of the property.

204 Woodgrange Drive, Southend-on-Sea, Essex, SS1 2SJ

Office: 01702 811211 info@bearestateagents.co.uk <https://www.bearestateagents.co.uk>

Energy Efficiency Graph

