



Symonds  
& Sampson

# Vine Cottage

Wales, Queen Camel



# Vine Cottage

Wales  
Queen Camel  
Yeovil  
BA22 7PA

A detached thatched historic home, originally three cottages, dating back to the 15th century with later 18th-century additions. Showcasing period features throughout, the property has been sympathetically updated in recent years. Set within a generous plot, it benefits from a substantial barn with potential for development, subject to the necessary planning permissions.



- Grade II\* Listed detached thatch cottage
- Offering a wealth of period features throughout
- Updated throughout within its current ownership
- Sitting in a plot of 0.67 acres with stone built barns
  - No onward chain

Guide Price £760,000  
Freehold

Sherborne Sales  
01935 814488  
[sherborne@symondsandsampson.co.uk](mailto:sherborne@symondsandsampson.co.uk)





## THE DWELLING

Originally three cottages, this remarkable property is steeped in history, with the oldest section dating back to circa 1500 and later additions from the 18th century. A particularly striking feature is the spiral staircase, with elements believed to date back to around 1300, offering a rare glimpse into medieval craftsmanship. The home beautifully blends period charm with generous, characterful spaces, featuring good ceiling heights amidst exposed beams.

Set within a substantial plot backing onto the Blackmore Vale countryside, the property enjoys a wonderful sense of privacy and tranquillity. A significant addition is the large stone-built outbuilding with a tiled roof, offering approximately 1,251 sq ft of space presenting an exciting opportunity for further development, subject to the necessary planning consents.

## ACCOMMODATION

A spacious and grand central hallway sets a distinguished tone for the home, featuring exquisite plank and muntin oak panelling alongside beautiful flagstone flooring, showcasing the property's rich heritage.

The ground floor boasts two beautifully proportioned reception rooms, each positioned at either end of the property, both enjoying an abundance of natural light through dual-aspect windows adorned with charming window seats. The drawing room features a magnificent open fireplace with an imposing bressummer beam, offering a grand yet inviting focal point. A discreet secondary staircase provides direct access to the master suite, enhancing the home's unique charm.

Centrally positioned, the exquisite kitchen and dining room seamlessly blend timeless character with refined practicality. Sleek bespoke cabinetry is complemented by an electric AGA, elegantly set within a substantial inglenook, while a walk-in pantry provides additional storage. Beyond, a well-appointed utility room offers further cabinetry, ample space for white goods, and a rear access door. Completing the ground floor is a stylish shower room, thoughtfully designed for both comfort and convenience.

The first floor is accessed via a long hallway adorned with exposed beams, leading to four generously proportioned double bedrooms, as well as a convenient store and linen cupboard. Each bedroom enjoys a delightful southerly front aspect, bathing the rooms in natural light. The principal suite further benefits from a dual-aspect outlook, enhancing the sense of space and light, and features a charming open fireplace, adding to its character and warmth.

Bedroom two is further enhanced by bespoke built-in cabinetry, offering both practicality and style. The well-appointed family bathroom is conveniently located to serve all bedrooms, completing this first-floor arrangement.







## GARDENS AND OUTBUILDINGS

A charming patio area, set adjacent to the property, provides an ideal space for outdoor entertaining and relaxation. This leads onto an expansive lawned garden, enclosed by an attractive stone wall and bordered with mature shrubs. Beyond the formal garden lies a substantial barn, featuring beautiful stone elevations beneath a tiled roof, with windows on either side allowing for an abundance of natural light. An additional attached barn, with its own separate access, provides further versatility and potential. From here, the grounds extend to a further lawned area, home to a delightful orchard, which enjoys a picturesque setting backing onto the serene waters of the River Cam.

To the front of the property, a sweeping driveway sits alongside a neatly manicured lawn, enclosed by an attractive stone wall and



bordered by elegant box hedging. A charming pathway leads to the timber-framed front porch, creating a welcoming and picturesque entrance befitting this characterful home.

## MATERIAL INFORMATION

Mains electric and water.

Oil central heating and septic tank.

The oil tank and external boiler can be located within the rear garden.

Broadband - Standard broadband is available.

Mobile phone network coverage is likely inside and outside on most major networks.

(Information from Ofcom <https://www.ofcom.org.uk>)

Somerset Council

Council Tax Band: F

The property holds a Grade II\* Listed status.

Please note that while the property is situated in an area classified as low risk for flooding from rivers, the sea, and surface water, our client has advised that the property experienced flooding on 9th May 2023. This was subject to an insurance claim, more details of request.

Under the Estate Agents Act 1979 we are required to inform any prospective purchaser that this property is owned by a 'connected person' to a member of Symonds & Sampson staff.

## SITUATION

Vine Cottage is situated in the hamlet of Wales, just outside the sought-after village of Queen Camel. This desirable location combines the charm of countryside living with convenient access to local





amenities and transport links. The village of Queen Camel offers a range of amenities, including a village shop, primary school, a highly regarded health centre, post office, church, and a popular pub, fostering a strong sense of community.

The property is ideally placed for exploring the stunning Somerset countryside, with an abundance of walking and cycling routes nearby. The historic abbey town of Sherborne, approximately 6 miles away, provides a selection of shopping, leisure and cultural facilities, along with rail links to London Waterloo and Exeter.

Vine Cottage also benefits from excellent transport connections, with easy access to the A303 for routes towards London and the South West. The area is served by highly regarded schools, both state and independent, including Hazelgrove Prep, Sherborne School and Millfield.

#### DIRECTIONS

What3words - [///cotton.topples.triathlon](#)



# Wales, Queen Camel, Yeovil

Approximate Area = 2319 sq ft / 215.4 sq m (excludes void)

Limited Use Area(s) = 66 sq ft / 6.1 sq m

Outbuilding = 1251 sq ft / 116.2 sq m

Total = 3636 sq ft / 337.7 sq m

For identification only - Not to scale



FIRST FLOOR



GROUND FLOOR

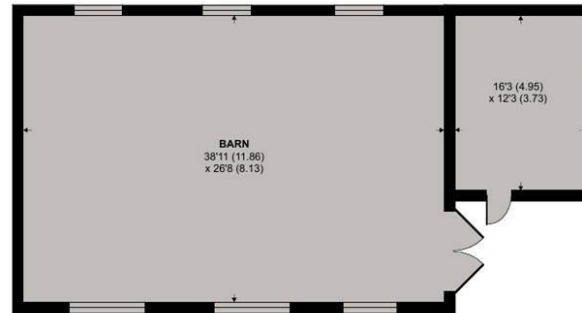

OUTBUILDING



Floor plan produced in accordance with RICS Property Measurement 2nd Edition, Incorporating International Property Measurement Standards (IPMS2 Residential). Produced for Symonds & Sampson. REF: 1241361

© nitchcom 2025.

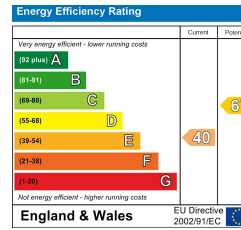

Denotes restricted head height



Sherb/KS/0225



01935 814488

sherborne@symondssandsampson.co.uk

Symonds & Sampson LLP

4 Abbey Corner, Half Moon Street,

Sherborne, Dorset DT9 3LN



Important Notice: Symonds & Sampson LLP and their Clients give notice that: 1. They have no authority to make or give any representations or warranties in relation to the property. These particulars do not form part of any offer or contract and must not be relied upon as statements or representations of fact. 2. Any areas, measurements or distances are approximate. The text, photographs and plans are for guidance only and are not necessarily comprehensive. It should not be assumed that the properties have all necessary planning, building regulation or other consents and Symonds and Sampson LLP have not tested any services, equipment of facilities. 3. We have not made any investigation into the existence or otherwise of any issues concerning pollution of the land, air or water contamination and the purchaser is responsible for making his/her own enquiries in this regard. 4. The property is sold subject to and with the benefit of all existing wayleaves, easements and rights of way whether public or private, specifically mentioned or not. The vendors shall not be required to define any such rights, privileges or advantages.

SALES | LETTINGS | AUCTIONS | FARMS & LAND | COMMERCIAL | NEW HOMES | PLANNING & DEVELOPMENT