



2

Raleigh Court, Long Street, Sherborne

# 2

Raleigh Court  
Long Street  
Sherborne  
DT9 3EQ

Situated in a highly sought-after location in Sherborne, this property offers generous accommodation across two floors, complete with the added benefits of off-street parking and a private courtyard garden.



- Two spacious double bedrooms
  - Three reception rooms
- Low maintenance courtyard garden
  - Off road parking
- Close proximity to Sherborne's amenities
  - No onward chain



Guide Price £350,000

Leasehold

Sherborne Sales  
01935 814488  
[sherborne@symondsandsampson.co.uk](mailto:sherborne@symondsandsampson.co.uk)



## THE DWELLING

Located in the heart of Sherborne, 2 Raleigh Court is part of a desirable residence, offering convenience to the town's amenities. This attractive link-detached property, with its stone elevations and tiled roof, provides unexpectedly spacious accommodation. Rarely available, the home also boasts the significant advantages of a private garden and off-street parking, making it a unique opportunity in this sought-after location.

## ACCOMMODATION

The centrally located hallway provides access to the reception rooms and a convenient shower room situated at the rear. On the left, the dining room is perfectly positioned between the well-equipped kitchen and a study, which is fitted with office furniture, the dining room includes a door providing easy access to the parking area. On the opposite side, a spacious living room opens directly onto the charming courtyard garden.

Upstairs, the first floor features two generously sized double bedrooms, with the master bedroom benefiting from extensive wardrobes that provide excellent storage space. The modern shower room is complete with a walk-in double shower, and the landing offers additional storage with an airing cupboard and access to the attic.

## GARDEN

To the side of the property, you'll find one of Sherborne's most valuable assets, off-street parking. On the opposite side of the property, a walled courtyard garden enjoys a sunny westerly aspect and provides excellent privacy.

## SITUATION

Located in the historic and highly sought-after Abbey Town of Sherborne, this property offers convenient access to local amenities, schools, and transport links. The main shopping street boasts a variety of independent shops, restaurants, and supermarkets like Waitrose and Sainsbury's. Nearby towns include Yeovil (5.5 miles) and Dorchester (18 miles).

Sherborne offers excellent educational options, including two primary schools, The Gryphon School for secondary education, and highly regarded private schools including the Sherborne schools, Leweston and Hazlegrove. The town provides a regular train service to Waterloo (2.5 hours), while a faster train to Paddington (90 minutes) is available from Castle Cary (12 miles). Bournemouth, Bristol, and Exeter Airports are easily accessible.

## DIRECTIONS

What3words - ///immune.speeded.irritated

## MATERIAL INFORMATION

Mains electric, water and drainage are connected to the property. Night storage heating.

Broadband - Ultrafast broadband is available. Mobile phone network coverage is likely outside, with limited coverage available inside. (Information from Ofcom <https://www.ofcom.org.uk>) Dorset Council

## AGENTS NOTE

Length of lease - 999 years.  
Start date - 22 August 1988  
Years remaining - 963  
Ground rent - £1  
Annual service charge - £4,128.36



Energy Efficiency Rating		Current	Potential
Very energy efficient - lower running costs			
(12 plus) A			
(91-91) B			
(69-89) C			
(55-68) D			
(39-54) E			
(21-38) F			
(1-20) G			
Not energy efficient - higher running costs			
England & Wales		EU Directive 2002/91/EC	

# Raleigh Court, Long Street, Sherborne

Approximate Area = 961 sq ft / 89.2 sq m

For identification only - Not to scale



GROUND FLOOR

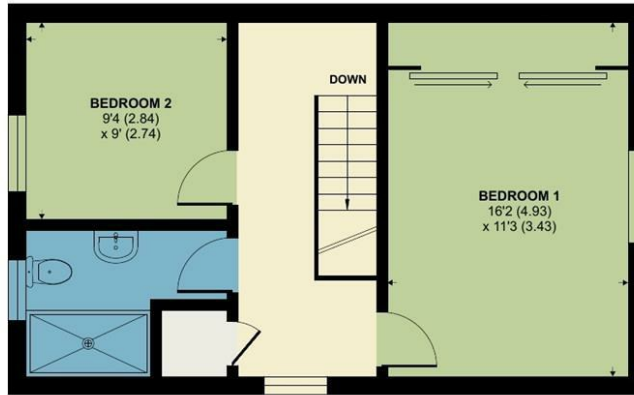

FIRST FLOOR



Floor plan produced in accordance with RICS Property Measurement 2nd Edition, Incorporating International Property Measurement Standards (IPMS2 Residential). © nichecom 2024. Produced for Symonds & Sampson. REF: 1198515



Sherb/AW/1024



01935 814488

sherborne@symondsandsampson.co.uk  
Symonds & Sampson LLP  
4 Abbey Corner, Half Moon Street,  
Sherborne, Dorset DT9 3LN



Important Notice: Symonds & Sampson LLP and their Clients give notice that: 1. They have no authority to make or give any representations or warranties in relation to the property. These particulars do not form part of any offer or contract and must not be relied upon as statements or representations of fact. 2. Any areas, measurements or distances are approximate. The text, photographs and plans are for guidance only and are not necessarily comprehensive. It should not be assumed that the properties have all necessary planning, building regulation or other consents and Symonds and Sampson LLP have not tested any services, equipment of facilities. 3. We have not made any investigation into the existence or otherwise of any issues concerning pollution of the land, air or water contamination and the purchaser is responsible for making his/her own enquiries in this regard. 4. The property is sold subject to and with the benefit of all existing wayleaves, easements and rights of way whether public or private, specifically mentioned or not. The vendors shall not be required to define any such rights, privileges or advantages.

SALES | LETTINGS | AUCTIONS | FARMS & LAND | COMMERCIAL | NEW HOMES | PLANNING & DEVELOPMENT