



Maplecroft Lane, Nazeing, Essex

  
**Reynolds Salter**  
Estate Agents





A Delightful THREE DOUBLE BEDROOM detached house superbly situated on an elevated SOUTH FACING plot within this peaceful sought after residential location with fabulous far reaching views over Nazeing Village and the surrounding countryside. This charming family home provides spacious well presented accommodation and offers tremendous scope for double and single storey extensions subject to the usual planning consents. The south facing rear garden is beautifully well established being mainly laid to lawn surrounded by various mature trees, bushes, plants and shrubs along with a paved patio/bbq area to the immediate rear of the property. The front exterior is partly laid to lawn along with a hard standing driveway which provides parking for numerous vehicles leading to the attached garage. Nazeing is a popular village providing a number of shops, a highly regarded primary school and a friendly local public house. Broxbourne Station (Liverpool Street) is approximately 2.5 miles away.

- **South Facing Elevated Plot**
- **Countryside Views**
- **Three Double Bedrooms**
- **Spacious Lounge**
- **Conservatory**
- **Study**
- **Scope For Extension (STPP)**



**Ground Floor**  
Floor area 92.0 sq. m. (990 sq. ft.) approx

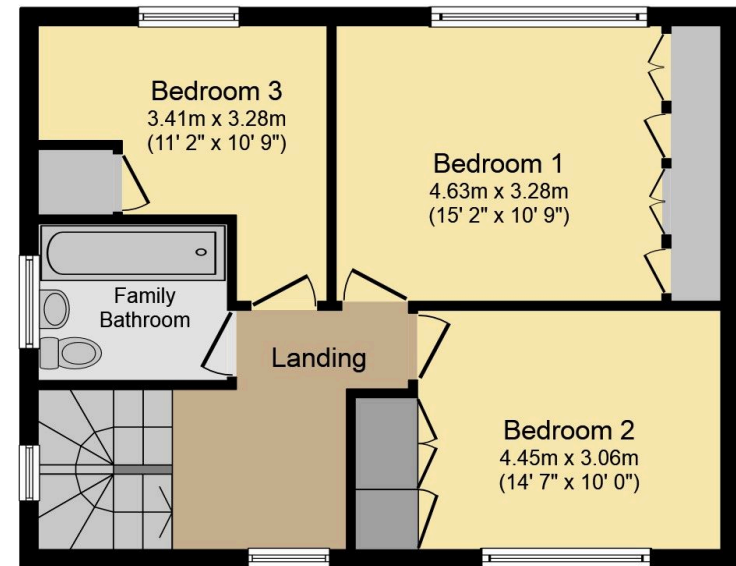

**First Floor**  
Floor area 51.0 sq. m. (549 sq. ft.) approx

Total floor area 143.0 sq. m. (1,539 sq. ft.) approx

This plan is for illustration purposes only and may not be representative of the property. Plan not to scale.

Powered by [www.keyagent.co.uk](http://www.keyagent.co.uk)

**Important notice**

1. Particulars: These particulars are not an offer or contract, nor part of one. You should not rely on statements by Reynolds Salter in the particulars or by word of mouth or in writing ("information") as being factually accurate about the property, its condition or its value. Neither Reynolds Salter nor any joint agent has any authority to make any representations about the property, and accordingly any information given is entirely without responsibility on the part of the agents, seller(s) or lessor(s). 2. Photos etc: The photographs show only certain parts of the property as they appeared at the time they were taken. Areas, measurements and distances given are approximate only. Regulations etc: Any reference to alterations to, or use of, any part of the property does not mean that any necessary planning, building regulations or other consent has been obtained. A buyer or lessee must find out by inspection or in other ways that these matters have been properly dealt with and that all information is correct. 4. VAT: The VAT position relating to the property may change without notice.