



38 Dore Road, Stratton, SN2 7QU

Guide Price £285,000

richard james



Dores Road

Stratton

Freehold | EPC Rating - D

 4
  2
  1

Richard James are delighted to offer for sale this immaculately presented and greatly improved family home, situated within the popular Stratton area of East Swindon.

The deceptively spacious accommodation has been finished to a very high standard throughout and laid out over three floors, perfect for a growing family. Which comprises; welcoming Hallway, 23' Sitting / Dining Room, a lovely refitted Kitchen with integrated appliances, modern Family Bathroom and Lobby leading out into the Rear Garden.

With Three of the double Bedroom and Ensuite to Bedroom One, to the first floor, with staircase leading up to a further double Bedroom, with Velux windows.

To the outside, there is a pleasant enclosed Rear Garden, laid to lawn with raised border and path leading to generous patio area to the rear, which enjoys a sunny aspect.

Further features include PVCu Double Glazing and Gas Radiator Heating.



Located within close proximity to reputable schooling and offering excellent access to major road links such as the A419, A420, Junction 15 of the M4 Motorway and the Great Western Hospital.











Floorplan



Approximate Area = 1036 sq ft / 96.2 sq m
 Limited Use Area(s) = 163 sq ft / 15.1 sq m
 Total = 1199 sq ft / 111.3 sq m

For identification only - Not to scale

Denotes restricted
head height

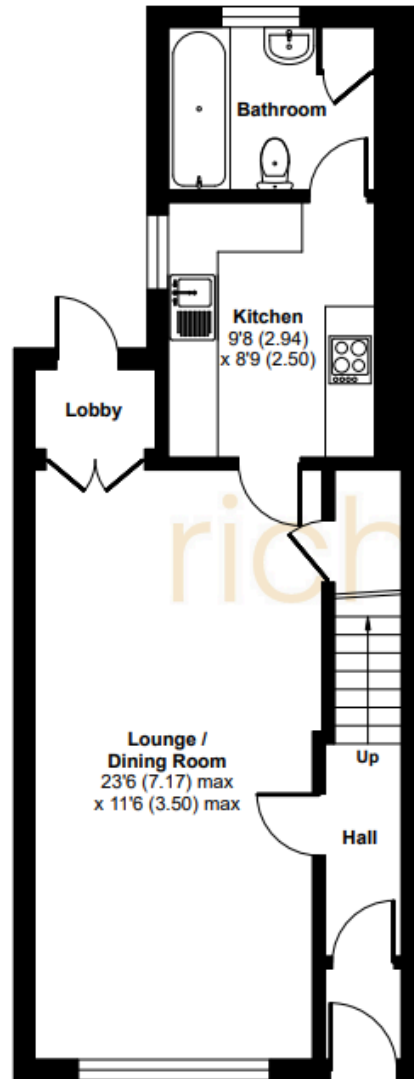

GROUND FLOOR

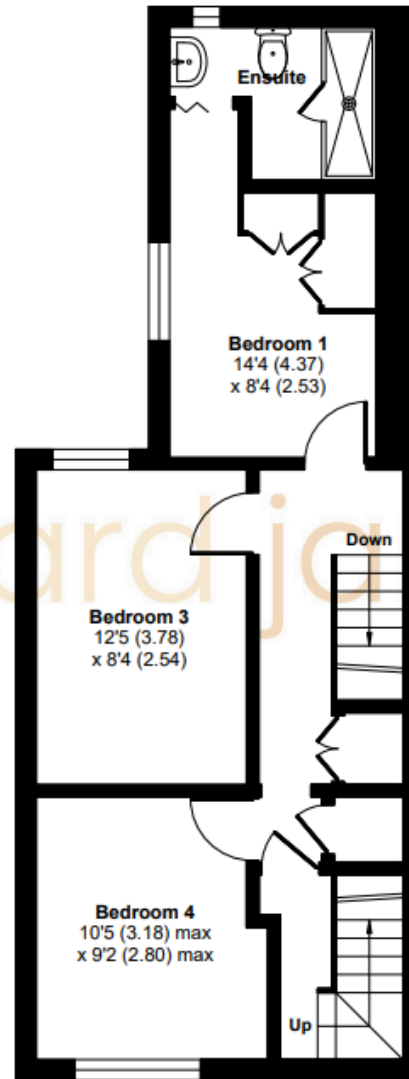

FIRST FLOOR

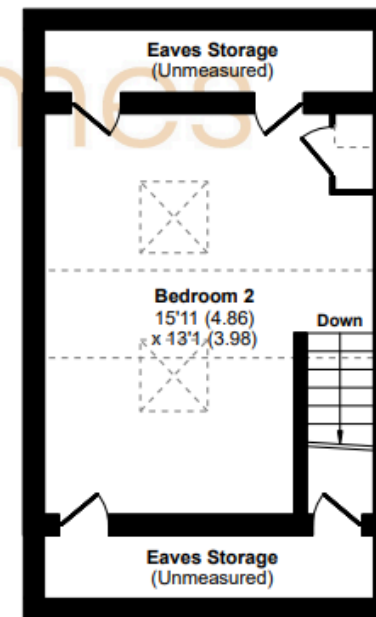

SECOND FLOOR

01793 520 720

oldtown@richardjames.uk

101 Victoria Road | Swindon | SN1 3BD

richard james

richardjames.uk