



Gate Court, Weybridge, KT13 8NW





A first floor one bedroom apartment in a purpose-built development in the heart of central Weybridge. Accommodation includes a living room with an open-plan kitchen, a bathroom with a white suite and a shower over the bath, bedroom, and storage cupboards in the entrance hallway.

The town centre location is a significant advantage, with Weybridge High Street just a few hundred yards away. The shops and Cricket Green at Temple Market, situated at the top of Monument Hill, are also within easy reach. The property further benefits from close proximity to scenic walks along the River Thames and River Wey, as well as Weybridge mainline railway station.

Offered for sale with No onward chain.

Leasehold



Approximate Area = 358 sq ft / 33.26 sq m

For identification only - Not to scale

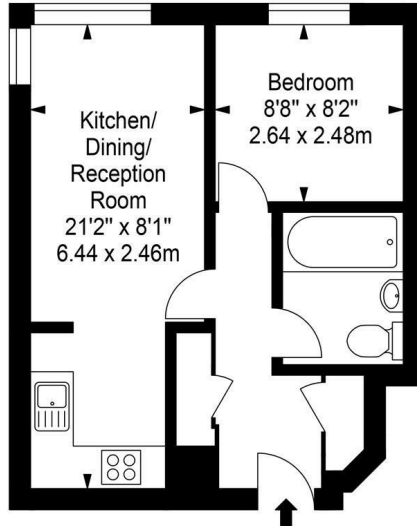

Every attempt is made to assure accuracy, however measurements are approximate and for illustrative purposes only. Not to scale.

EPC Rating: 70 C





Grants Homes 60 Church Street, Weybridge, Surrey, KT13 8DL
T: 01932 841020 E: weybridge@grantshomes.co.uk

g
GRANTS
HOMES