



Heathside, Hanger Hill, Weybridge, KT13 9YJ





Located just a short stroll from Weybridge mainline railway station, the Cricket Green, Queens Road shops, and the High Street, Heathside is a highly regarded development known for its distinctive architectural design and bright, spacious apartments.

This first-floor apartment is accessed via secure communal doors and opens into a generous central hallway that leads to all rooms. The large, light-filled reception room enjoys delightful views over the mature, well-maintained communal gardens. The kitchen features white eye and base level storage units, a tiled floor, and part tiled walls.

There are two double bedrooms, both with built-in wardrobes, and a bathroom with a white suite. Additional benefits include a garage in a nearby block, communal parking, and access to attractive shared gardens.

The property is ideally situated within a few hundred meters of the mainline train station and close to a wide range of local amenities. Offered for sale with no onward chain.

Leasehold - Share of Freehold



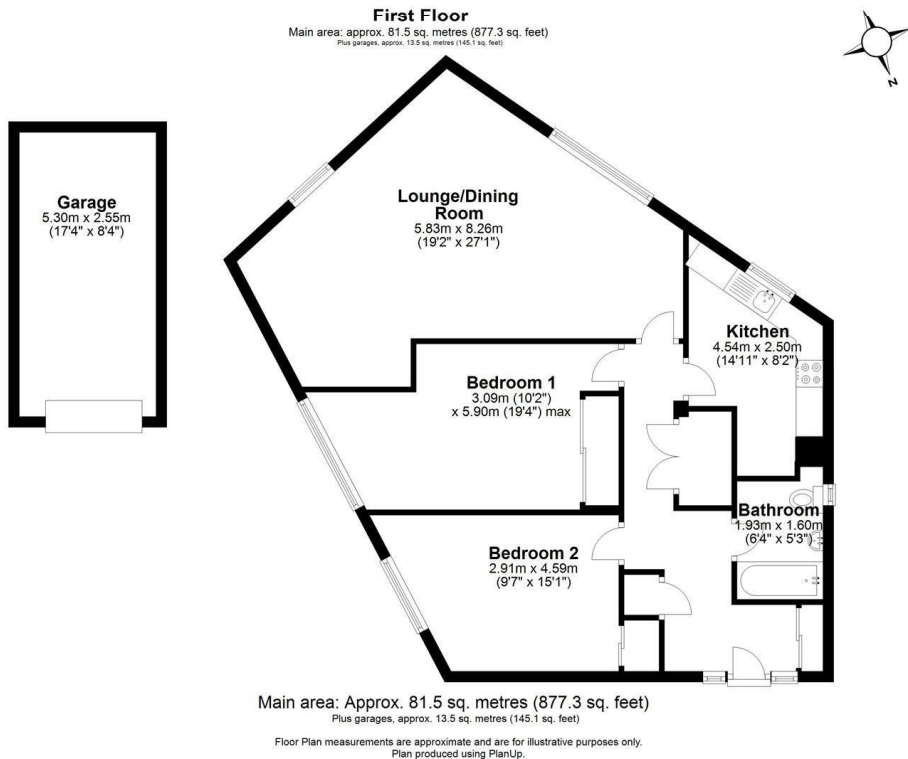

EPC Rating: 71 C



Grants Homes 60 Church Street, Weybridge, Surrey, KT13 8DL
T: 01932 841020 E: weybridge@grantshomes.co.uk

g
GRANTS
HOMES