



Heathside, Hanger Hill, Weybridge, KT13 9YH



A rare opportunity to acquire a ground-floor apartment in the highly sought-after Heathside development, just a short walk from Weybridge mainline station, Queens Road shops, Weybridge cricket green, and the High Street.

Designed to maximize space and natural light, this well-proportioned home features a generous dual-aspect reception room with views over the beautifully maintained communal gardens. The kitchen also enjoys pleasant garden views, while both spacious double bedrooms include built-in wardrobes. The bathroom is fitted with a classic white suite and part tiled walls.

Ideal for downsizers, first-time buyers, and investors alike, this apartment is offered with no onward chain and includes a garage in a nearby block. With its prime location and excellent amenities close by, this is a fantastic opportunity to secure a home in one of Weybridge's most desirable settings.

Leasehold



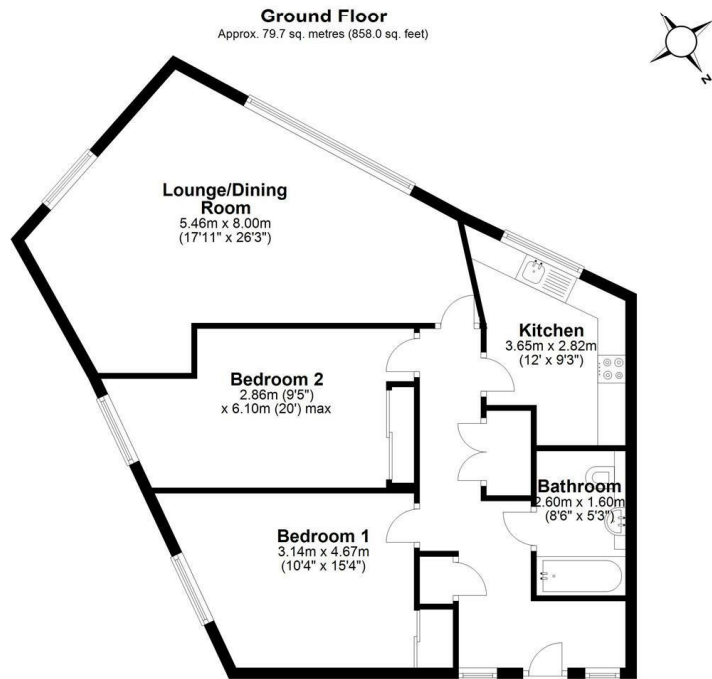

Total area: approx. 79.7 sq. metres (858.0 sq. feet)

Floor Plan measurements are approximate and are for illustrative purposes only. While we do not doubt the floor plans accuracy, we make no guarantee, warranty or representation as to the accuracy and completeness of the floor plan.
Plan produced using PlanUp.



EPC Rating: 68 D





Grants Homes 60 Church Street, Weybridge, Surrey, KT13 8DL
T: 01932 841020 E: weybridge@grantshomes.co.uk