



Meadows Leigh Close, Weybridge, KT13 8QD





Nestled quietly within a residential cul-de-sac yet conveniently located in central Weybridge, within a short walk of the High Street, this spacious three-bedroom house offers the best of both worlds. It is ideally positioned for those who enjoy scenic walks along the River Thames and River Wey, with the popular local schools just a stone's throw away. Weybridge station is just over a mile away, providing excellent transport links.

The pretty front garden is framed by a low picket fence, which leads to the welcoming front door. Upon entry, the hallway opens into a generously proportioned living room, with access to the large open-plan kitchen and dining room at the rear. Spanning the width of the house, the kitchen/dining area offers views and access to the lovely rear garden.

Upstairs, the property offers three spacious bedrooms. Two are well-sized doubles, while the third is a comfortable single that is currently used as a home office. The contemporary family bathroom boasts a sleek white suite, partially white tiled walls, a glass shower screen, an over-bath shower.

The rear garden is recently re-landscaped with two patio area at either end of the garden, new fencing, a raised border, and a brick boundary wall at the end of the garden.

Freehold



Ground Floor

Approx. 39.5 sq. metres (425.5 sq. feet)

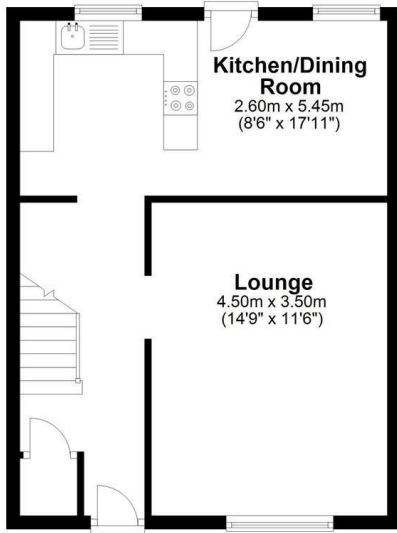

First Floor

Approx. 38.8 sq. metres (418.0 sq. feet)

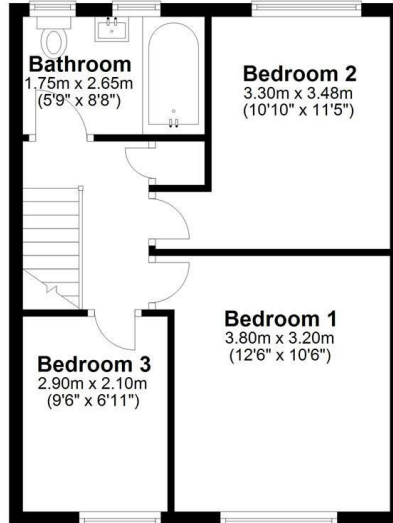

Total area: approx. 78.4 sq. metres (843.6 sq. feet)

Floor Plan measurements are approximate and are for illustrative purposes only.
Plan produced using PlanUp.



EPC Rating: 74 C





Grants Homes 60 Church Street, Weybridge, Surrey, KT13 8DL
T: 01932 841020 E: weybridge@grantshomes.co.uk

