



Arlington Lodge, Monument Hill, Weybridge, KT13  
8RD





This two bedroom ground floor maisonette is located in the heart of central Weybridge, within yards of the High Street and the local shops, restaurants, coffee shops and bars. The property is also very convenient for the Shops on Queens Road, Weybridge mainline railway station and the pleasant walks along the River Thames and River Wey.



The property has its own private entrance which leads to a hallway with a storage cupboard. The sitting room is a comfortable size and overlooks the communal gardens in the middle of the development. The kitchen has eye and base level fitted storage units and space for an oven and washing machine.



There are two bedrooms, both of which have built in wardrobes, and the bathroom is fitted with a white bathroom suite.

Ideal for a first time buyer or a buy to let investment landlord, this is an excellent opportunity to purchase a ground floor apartment in a convenient central location in Weybridge.

Leasehold



## Ground Floor

Approx. 60.5 sq. metres (651.1 sq. feet)

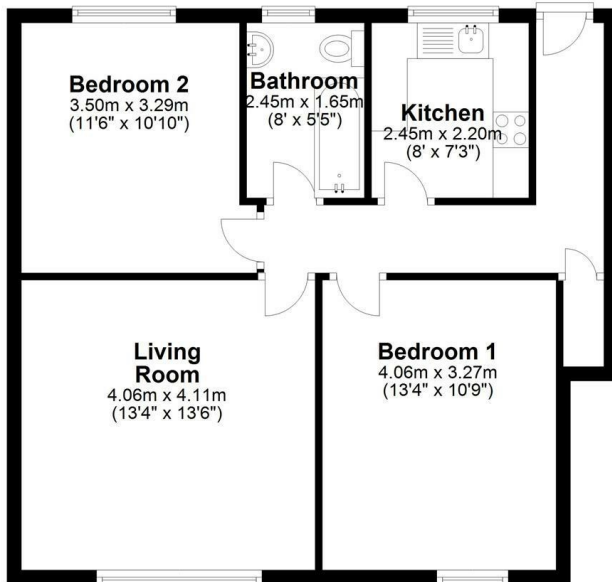

Total area: approx. 60.5 sq. metres (651.1 sq. feet)

Floor Plan measurements are approximate and are for illustrative purposes only.  
Plan produced using PlanUp.

EPC Rating: 74 C





Grants Homes 60 Church Street, Weybridge, Surrey, KT13 8DL  
T: 01932 841020 E: [weybridge@grantshomes.co.uk](mailto:weybridge@grantshomes.co.uk)