



Jasmine House,, Woburn Hill Park, KT15 2NZ



The private gated development of Woburn Hill Park is one of the areas best kept secrets! Hidden behind electric gates, a long sweeping tree lined driveway leads to the exclusive development which is set in approximately 5 acres of well-manicured communal gardens and woodland. The apartment is situated on the ground floor with a private patio area accessed from the reception room.

The apartment is well maintained and offers a large sitting room with doors opening to the patio. The kitchen is fitted with eye and base level storage units and built in appliances and there is even a separate utility room for more appliances and storage.

The master bedroom suite is fitted with a large range of built in Wardrobes, with pleasant views over the manicured lawns, and a large en suite bathroom with a bath, WC, wash basin and a shower cubicle. The second bedroom also has built in wardrobes with mirrored sliding doors. The main bathroom is fitted with bath, wash basin, heated towel rail and WC.

Outside the property has allocated parking, a garage in a nearby block and there is also ample visitors parking space available. One of the standout features for this unique development has to be the vast communal gardens with areas of lawn, woodland, water features and a greenhouse.

Woburn Hill Park is nicely tucked away in a quiet location with easy access to Weybridge and Addlestone town centres, both providing railway line stations with rail links to London Waterloo, it is also well positioned for vehicular access to the M25 and A3.



**Leasehold - Share of Freehold**

## Ground Floor

Approx. 74.7 sq. metres (804.4 sq. feet)

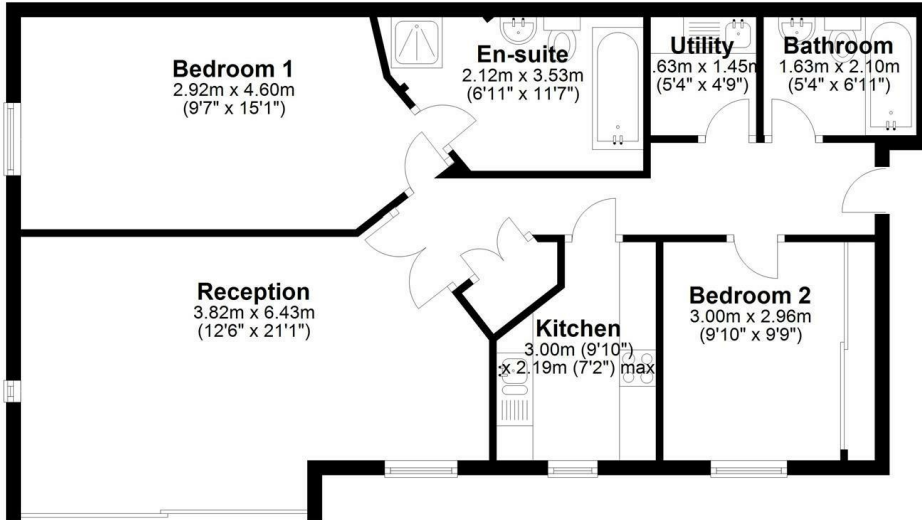

Total area: approx. 74.7 sq. metres (804.4 sq. feet)

Floor Plan measurements are approximate and are for illustrative purposes only.  
Plan produced using PlanUp.

EPC Rating: 73 C





Grants Homes 60 Church Street, Weybridge, Surrey, KT13 8DL  
T: 01932 841020 E: [weybridge@grantshomes.co.uk](mailto:weybridge@grantshomes.co.uk)