



Chelsea Creek Tower, Fulham
London SW6

GARTON JONES.COM



Chelsea Creek Tower, Fulham London, SW6

GARTON JONES.COM

11 Park Street
Chelsea Creek
London
SW6 2FS

Sales +44 (0) 20 7824 7090
paul@gartonjones.com
www.gartonjones.com

£1,096 Per Week

Highly sought after larger than average two-bedroom apartment 1255sqft (116sqm) which is on the 4th floor of the Chelsea Creek Tower which remains one of the most sought-after buildings here at Chelsea Creek. The highly impressive accommodation comprises of a spacious lounge with balcony, modern luxury fitted kitchen with integrated appliances. The master bedroom benefits from a luxury ensuite, fitted wardrobes and balcony, second bedroom also is well proportioned and has fitted wardrobe, family bathroom, the property throughout is of a high specification and well presented. The development offers a resident's gym & spa, 24-hour concierge & communal landscaped gardens. Chelsea Creek is located a short distance from the amenities of the Kings Road, and moments from Imperial Wharf over ground station which is one stop from both West Brompton station (district line) and Clapham Junction.

6 Weeks Security Deposit
12-Month Tenancy
Council Tax — London Borough Of
Hammersmith & Fulham — Band H

EPC B (87)

EPC certificate available on request.

- Highly Sought After Building Here At Chelsea Creek
- Two Double Bedrooms
- 1255sqft (116sqm)
- 4th Floor
- Open Plan Lounge And Kitchen
- Two Balconies
- Integrated Appliances
- Onsite Facilities — Gym , Swimming Pool & 24-Hour Concierge
- Parking For 1 Car
- EPC B (87)

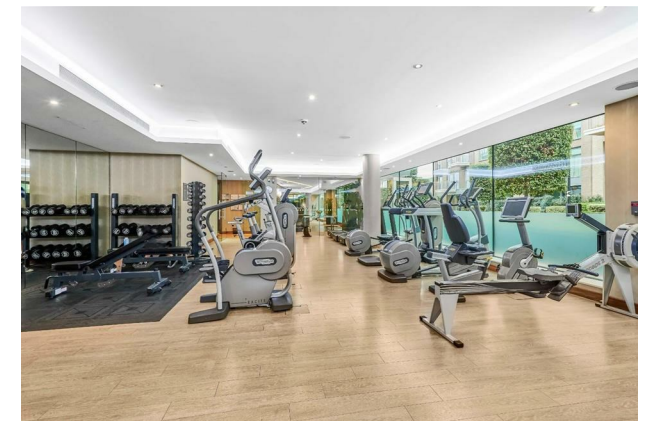

PARK STREET, SW6

TOTAL APPROX FLOORPLAN AREA 1846 SQ.FT (171.49 SQ.M)

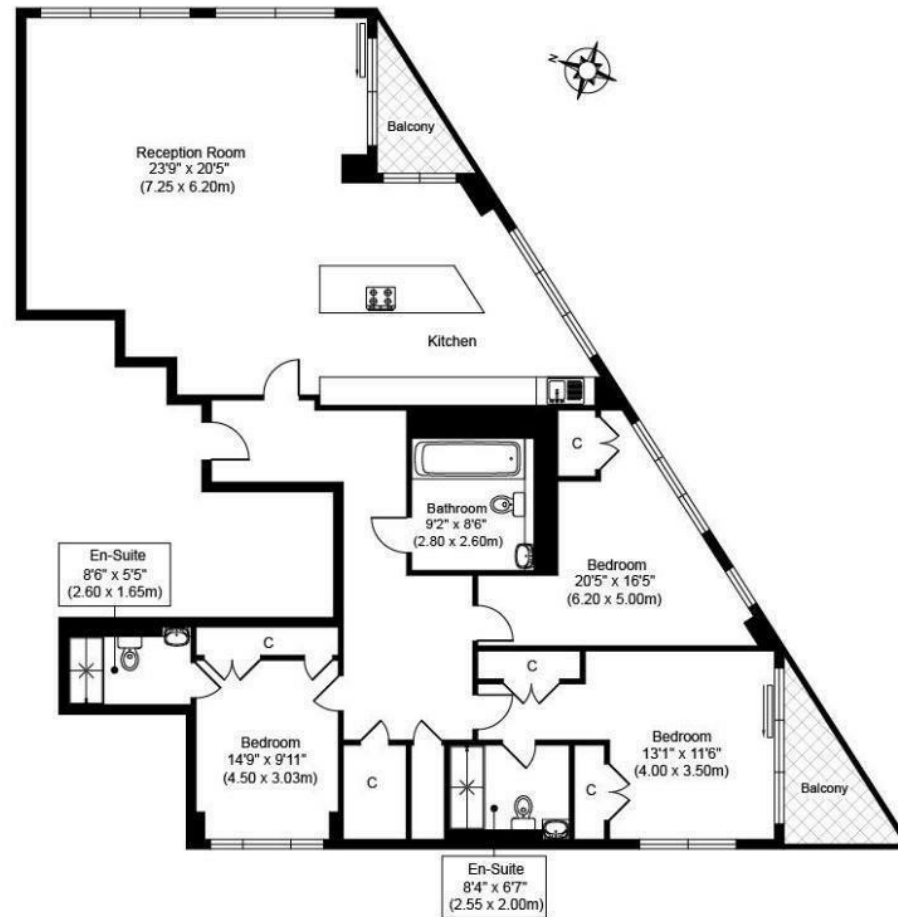

ELEVENTH FLOOR

