

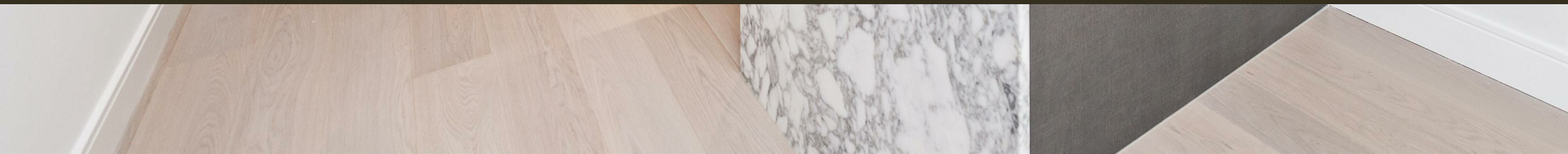

Lockside House, Chelsea Creek  
London SW6

GARTON JONES.COM



# Lockside House, Chelsea Creek London, SW6

GARTON JONES.COM

11 Park Street  
Chelsea Creek  
London  
SW6 2FS

Sales +44 (0) 20 7824 7090  
paul@gartonjones.com  
www.gartonjones.com

## £690 Per Week

SECURE PARKING AVAILABLE with this beautifully presented un-furnished ONE DOUBLE bedroom apartment to rent, located in Lockside House, one of the buildings on Chelsea Creek development in Fulham. Comprising of an open plan reception room with access to a private balcony, modern kitchen with Siemens integrated appliances including a wine cooler, induction hob, dishwasher, oven, and fridge freezer. Lockside House is situated in one of London's most elegant dockside developments, 24 HOUR CONCIERGE. Spa and fitness suite with Swimming pool. King's Road and Chelsea Harbour are easily accessible and Imperial Wharf Station is just a few minutes' walk.

**\*\*Please note furniture may differ to that shown in current photos\*\***

Deposit — 5 Weeks  
Contract — Minimum 12 Months  
Council Tax — London Borough of Hammersmith & Fulham — Band E

EPC -B (83)

EPC certificate available on request.

- 585sq.ft (54.4sq.m)
- 1 Double Bedroom
- Luxury Bathroom
- 2nd Floor
- Open Plan Reception Room
- Kitchen With Siemens Integrated Appliances
- Private Balcony
- 24 Hour Concierge
- Resident's Leisure Suite With Swimming Pool, Spa & Gymnasium
- EPC -B (83)





# Lockside House

Approximate Gross Internal Area = 585 sq ft / 54.4 sq m

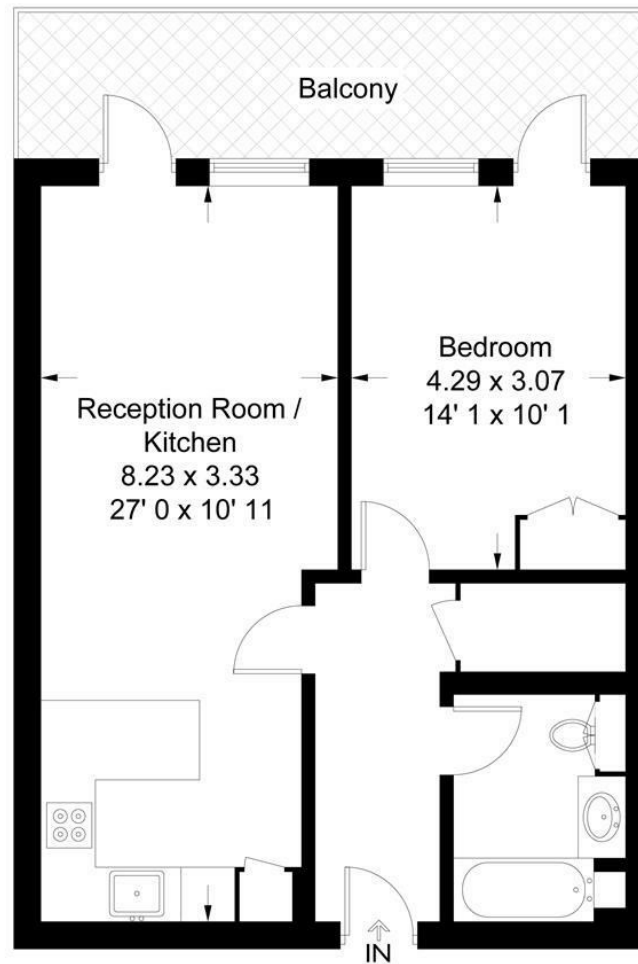

Not to scale, for guidance only and must not be relied upon as a statement of fact  
All measurements and areas are approximate only and have been prepared in  
accordance with the current edition of the RICS Code of Measuring Practice

