



Thurstan Street, London  
SW6

GARTONJONES.COM



Thurstan Street, London  
, SW6

GARTON JONES.COM

11 Park Street  
Chelsea Creek  
London  
SW6 2FS

Sales +44 (0) 20 7824 7090  
paul@gartonjones.com  
www.gartonjones.com

## £735,000 Leasehold

A larger than average one bedroom apartment 665sqft (61sqm) and INCLUDES PARKING. The property comprises of a spacious open plan living area with a modern kitchen 29'1 (8.8m) x 11'5 (3.4m) with built in appliances and access to two balconies. There is a double bedroom and bathroom. The idyllic canal side development which was built by the renowned Berkeley St George offers On-site a resident's gym, swimming pool, spa and 24-hour concierge. Chelsea Creek is located nearby to Imperial Wharf Overground station and Fulham Broadway Underground station both offering excellent links around London as well as the famous Kings Road which offers a wide range of designer boutiques, top class restaurants, bars and quaint cafes.

Service Charge - £5500  
Ground Rent - £350  
Lease 999 Years From 1st June 2010

Council Tax — London Borough Of  
Hammersmith & Fulham Council Band E

EPC B (82)

EPC certificate available on request.

- One Bedroom
- 4th Floor With Lift
- 665sqft (61sqm)
- Idyllic Dockside Location
- Open Plan Lounge — Kitchen Area
- Integrated Appliances
- High Specification
- Residents Spa — Gym & Swimming Pool
- Right To Park
- EPC B (82)

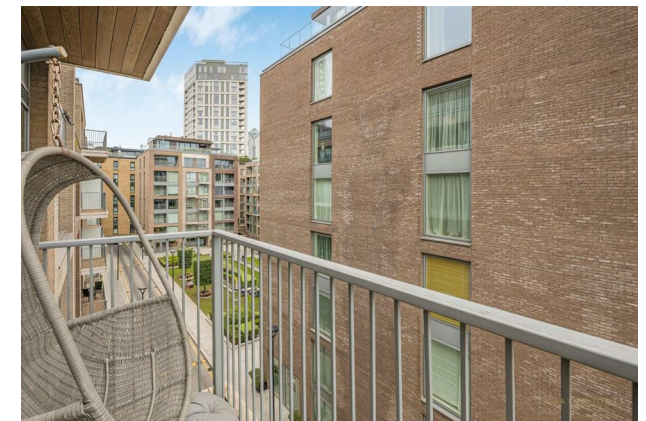



## Lockside House

Approximate Gross Internal Area = 665 sq ft / 61.8 sq m

Balcony = 64 sq ft / 6 sq m

GARTON JONES  
LONDON

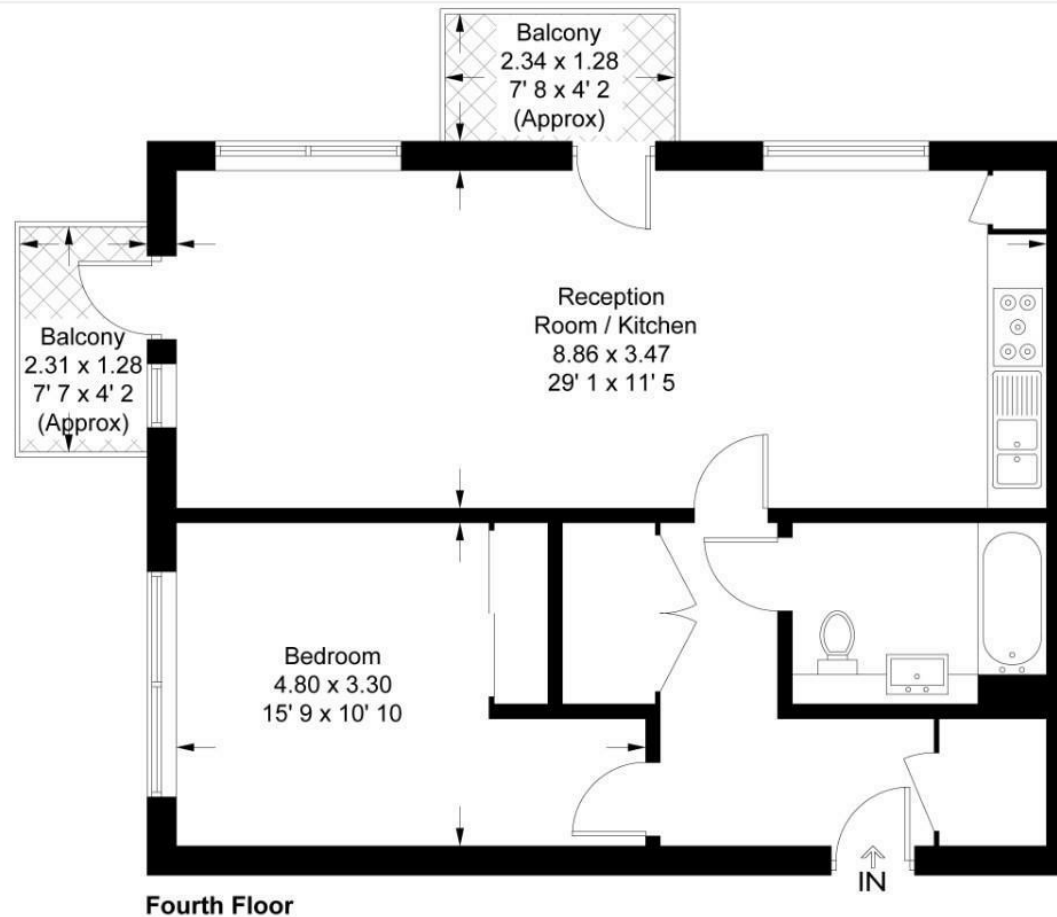

This plan is not to scale and must be used as layout guidance only. All measurements and areas are approximate and should not be relied upon to provide accurate information. This plan must not be relied upon when making property valuations, design considerations or any other such relevant decisions. We accept no responsibility or liability (whether in contract, tort or otherwise) in relation to any loss whatsoever arising from or in connection with any use of this plan or the adequacy, accuracy or completeness of it or any information within it.



