



Rock Estates



Lavender Cottage Ashfield Road, Elmswell, Bury St. Edmunds, IP30 9HG  
£475,000





## Lavender Cottage Ashfield Road, Elmswell, Bury St. Edmunds, IP30 9HG

**£475,000**

Charming property located in the popular village of Elmswell. This delightful house boasts a spacious layout with large open plan kitchen/diner and separate reception rooms all that have been beautifully renovated throughout.

This surprisingly spacious property boasts a modern open plan kitchen/ diner that over looks the rear garden, a useful utility room and separate boot room. A snug area as well as a living room. The impressive ground floor bathroom boasts a freestanding bath along with a large shower with tiled bench emulating that spa retreat. To the first floor there are three bedrooms with bathroom one benefiting from an ensuite.

The landscaped rear garden provides a tranquil outdoor space with multiple patio areas where you can relax and unwind. There is also plenty of lawned areas as well as a path connecting both patio areas, and a variety of mature flower and shrubs. There is a sizeable outbuilding currently being used as a home office and gym, with power and light connected.

Whether you're looking for a cozy family home or a peaceful retreat in the countryside, this house offers the best of both worlds. Don't miss out on the opportunity to make this charming property your own in the heart of Elmswell all within walking distance to local amenities, public houses and train line.



**Description**



**Situation**



null

Council Tax Band: C

Available:

## Floor Plans

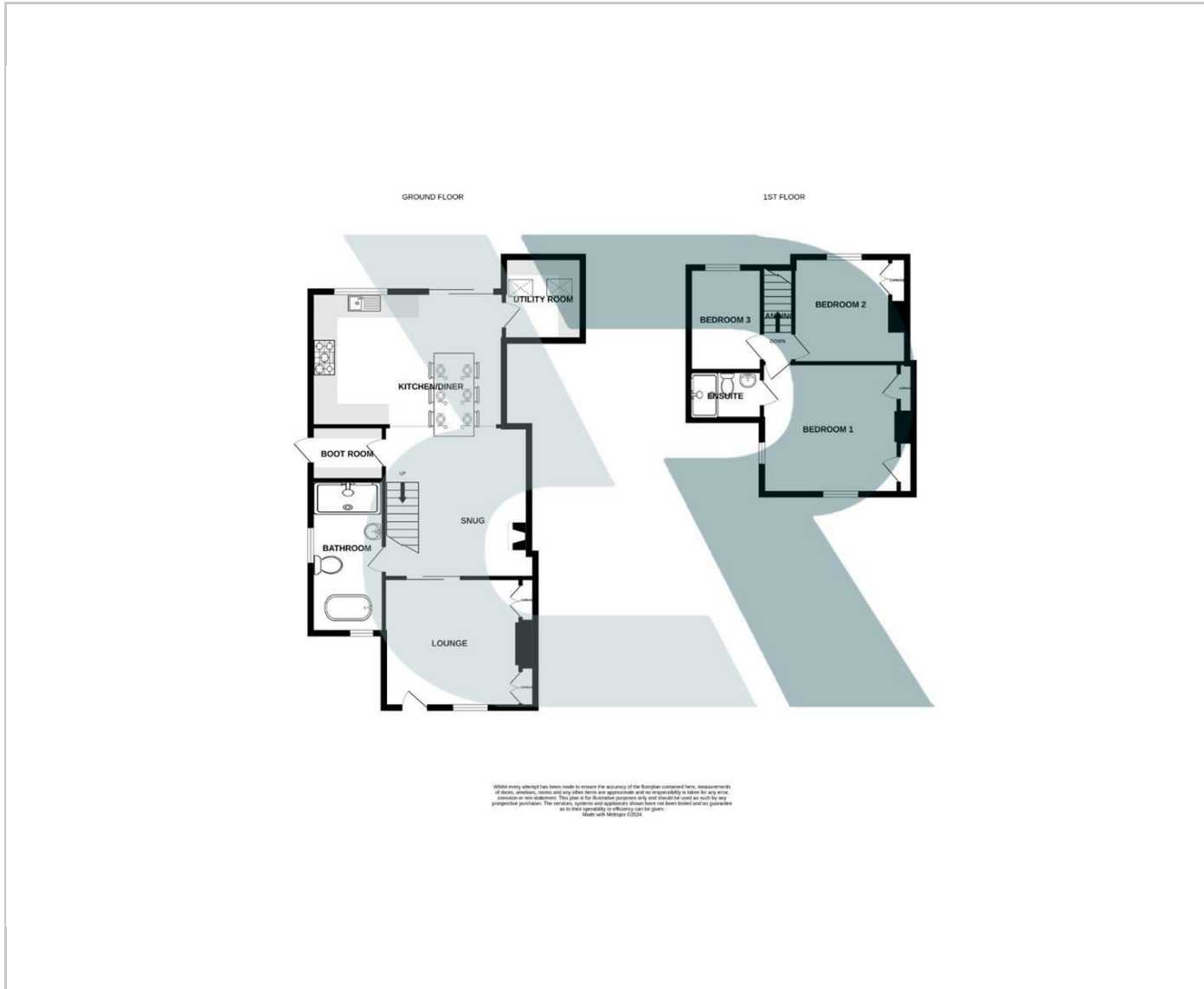

## Area Map

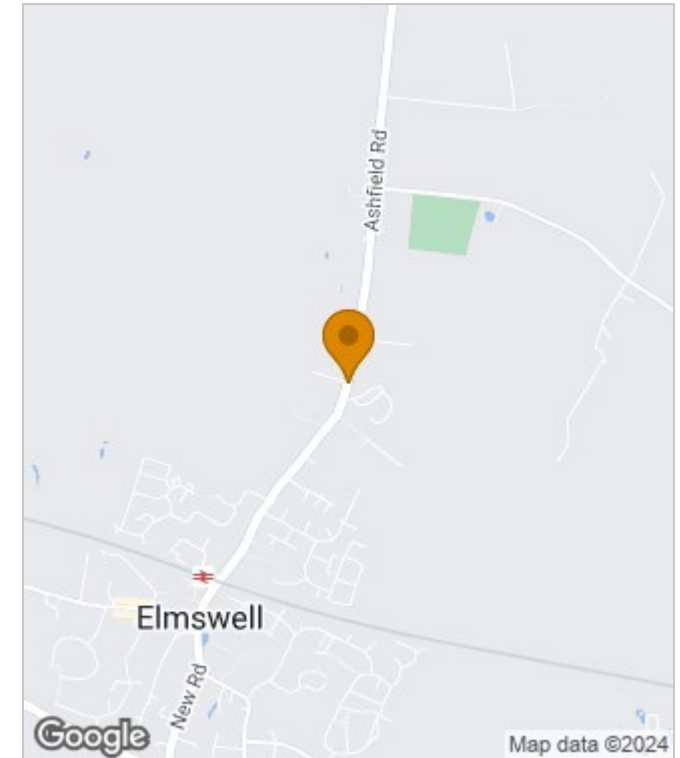

## Energy Performance Graph

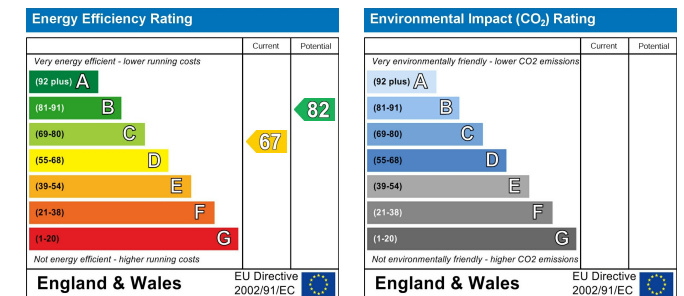

These particulars, whilst believed to be accurate are set out as a general outline only for guidance and do not constitute any part of an offer or contract. Intending purchasers should not rely on them as statements of representation of fact, but must satisfy themselves by inspection or otherwise as to their accuracy. No person in this firm's employment has the authority to make or give any representation or warranty in respect of the property.