

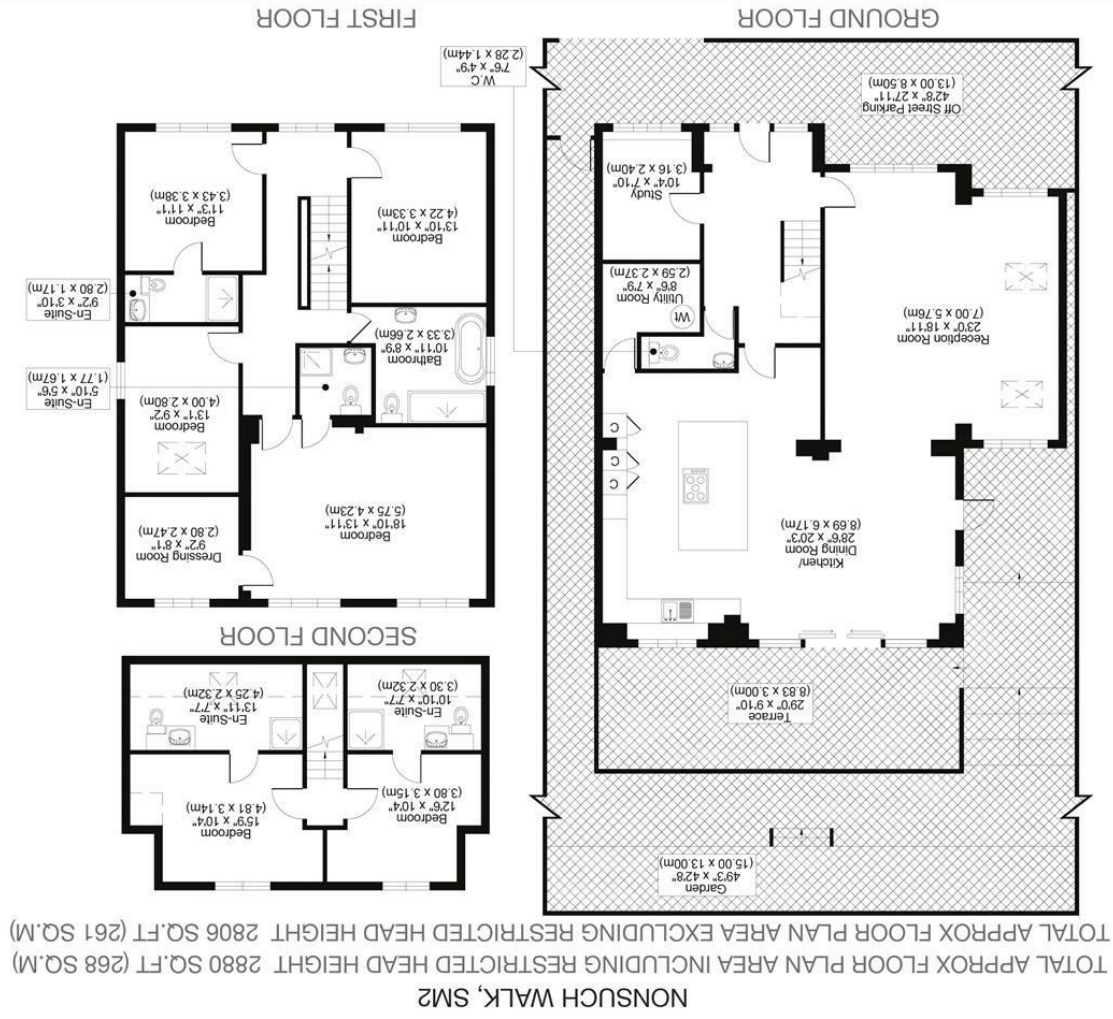

All measurements, walls, doors, windows, fittings and their appliances, their size and locations are shown conventionally and are approximate only and cannot be regarded as being a representation either by the seller or his agent.





**\*\* GUIDE PRICE £1,250,000 TO £1,500,000 \*\***

AN EXTREMELY RARE OPPORTUNITY TO PURCHASE A "KEY READY" HOUSE THAT HAS BEEN THE SUBJECT OF A MOST EXACTING AND THOROUGH PROGRAMME OF UPDATING AND EXTENSION, AND NOW OFFERS THE "DREAM HOME" THAT SO MANY BUYERS ARE CURRENTLY SEEKING. OFFERED WITH THE ADDED BENEFIT OF NO ONWARD CHAIN IT IS IDEALLY SUITED TO THOSE LOOKING FOR A QUICK MOVE. THE STUNNING ACCOMMODATION NOW INCLUDES WONDERFUL OPEN PLAN GROUND FLOOR SPACES WITH A SEPARATE FRONT FACING STUDY, AND SIX EXCELLENT DOUBLE BEDROOMS COMPLEMENTED BY FIVE EXCEPTIONAL BATHROOMS AND A MASTER SUITE THAT INCLUDES AN EN-SUITE DRESSING ROOM. SECURE GATED PARKING TO THE FRONT, AND A SECLUDED LAWNED REAR GARDEN COMPLETE THE PICTURE. A TRULY EXCEPTIONAL HOME THAT IS LOCATED CLOSE TO KEY LOCAL SCHOOLS, AND SIMPLY MUST BE SEEN IN ORDER TO BE FULLY APPRECIATED. CALL US TODAY TO RESERVE YOUR VIEWING APPOINTMENT.

- OFFERED FOR SALE WITH THE ADDED BENEFIT OF NO ONWARD CHAIN.
- SIX DOUBLE BEDROOM DETACHED HOUSE
- IMPRESSIVE ROOM SIZES ACROSS ALL THREE FLOORS
- NEWLY RENOVATED
- EPC RATING C
- COUNCIL TAX BAND G

