



Guide Price £450,000

3 Bedroom Town House for sale
5 SWANSFIELD ROAD, GREENHITHE





Overview

Guide Price £450,000 - £475,000 Welcome to this stunning 3/4 bedroom mid-terraced townhouse situated in the desirable area of Greenhithe, Kent. Boasting 3 double bedrooms and 3 bathrooms, including an ensuite to the master bedroom, this home is a spacious haven for families.



Key Features

- Call NOW 24/7 or Go Online To View
- 3/4 Bedrooms - Adaptable Living Space
- Pleasantly Quiet Location
- Perfect Family Home
- 2 Allocated Parking Spaces
- Years Remaining NHBC Warranty





Guide Price £450,000 - £475,000 Welcome to this stunning 3/4 bedroom mid-terraced townhouse situated in the desirable area of Greenhithe, Kent. Boasting 3 double bedrooms and 3 bathrooms, including an ensuite to the master bedroom, this home is a spacious haven for families.

Upon entering, you'll be impressed by the deceptive size of the property, reminiscent of a Tardis, offering more space than initially meets the eye. The ground floor features a large kitchen diner, perfect for hosting gatherings and family meals. Additionally, there's a versatile room that can serve as a study or a fourth bedroom, accommodating various lifestyle needs.

Moving to the first floor, you'll find a generously sized landing leading to the master suite, complete with its own ensuite bathroom. The living room on this floor is bathed in natural light, creating a welcoming and airy atmosphere.

Ascending to the second floor, you'll discover two further bedrooms and a spacious bathroom equipped with a 3-piece suite and a shower over the bath, ensuring convenience for all occupants.

Outside, the property boasts a good-sized garden with a patio area and artificial grass, providing ample space for outdoor activities. With rear access provided, the garden offers both privacy and convenience.

Conveniently located equidistantly from both Greenhithe and Stone Crossing train stations, commuting is made easy. Furthermore, a short drive will take you to the renowned Bluewater Shopping Centre. The property also benefits from excellent local transport links, with the M25 and A2 nearby.

In summary, this townhouse offers not only a comfortable and spacious living environment but also the convenience of its location, making it an ideal choice for families seeking a delightful home in Greenhithe, Kent.

Guide Price £450,000 - £475,000 Welcome to this stunning 3/4 bedroom mid-terraced townhouse situated in the desirable area of Greenhithe, Kent. Boasting 3 double bedrooms and 3 bathrooms, including an ensuite to the master bedroom, this home is a spacious haven for families.

Upon entering, you'll be impressed by the deceptive size of the property, reminiscent of a Tardis, offering more space than initially meets the eye. The ground floor features a large kitchen diner, perfect for hosting



gatherings and family meals. Additionally, there's a versatile room that can serve as a study or a fourth bedroom, accommodating various lifestyle needs.

Moving to the first floor, you'll find a generously sized landing leading to the master suite, complete with its own ensuite bathroom. The living room on this floor is bathed in natural light, creating a welcoming and airy atmosphere.

Ascending to the second floor, you'll discover two further bedrooms and a spacious bathroom equipped with a 3-piece suite and a shower over the bath, ensuring convenience for all occupants.

Outside, the property boasts a good-sized garden with a patio area and artificial grass, providing ample space for outdoor activities. With rear access provided, the garden offers both privacy and convenience.

Conveniently located equidistantly from both Greenhithe and Stone Crossing train stations, commuting is made easy. Furthermore, a short drive will take you to the renowned Bluewater Shopping Centre. The property also benefits from excellent local transport links, with the M25 and A2 nearby.

In summary, this townhouse offers not only a comfortable and spacious living environment but also the convenience of its location, making it an ideal choice for families seeking a delightful home in Greenhithe, Kent.

Hall

Kitchen

Bathroom

Bedroom

Bedroom (Double) with Ensuite

Bedroom

Landing

Living Room

WC

Garden

Driveway

Floorplans



Approximate total area⁽¹⁾
384.89 ft²
35.76 m²

(1) Excluding balconies and terraces

While every attempt has been made to ensure accuracy, all measurements are approximate, not to scale. This floor plan is for illustrative purposes only.

ORAPP/2360

Ground Floor

Floorplans

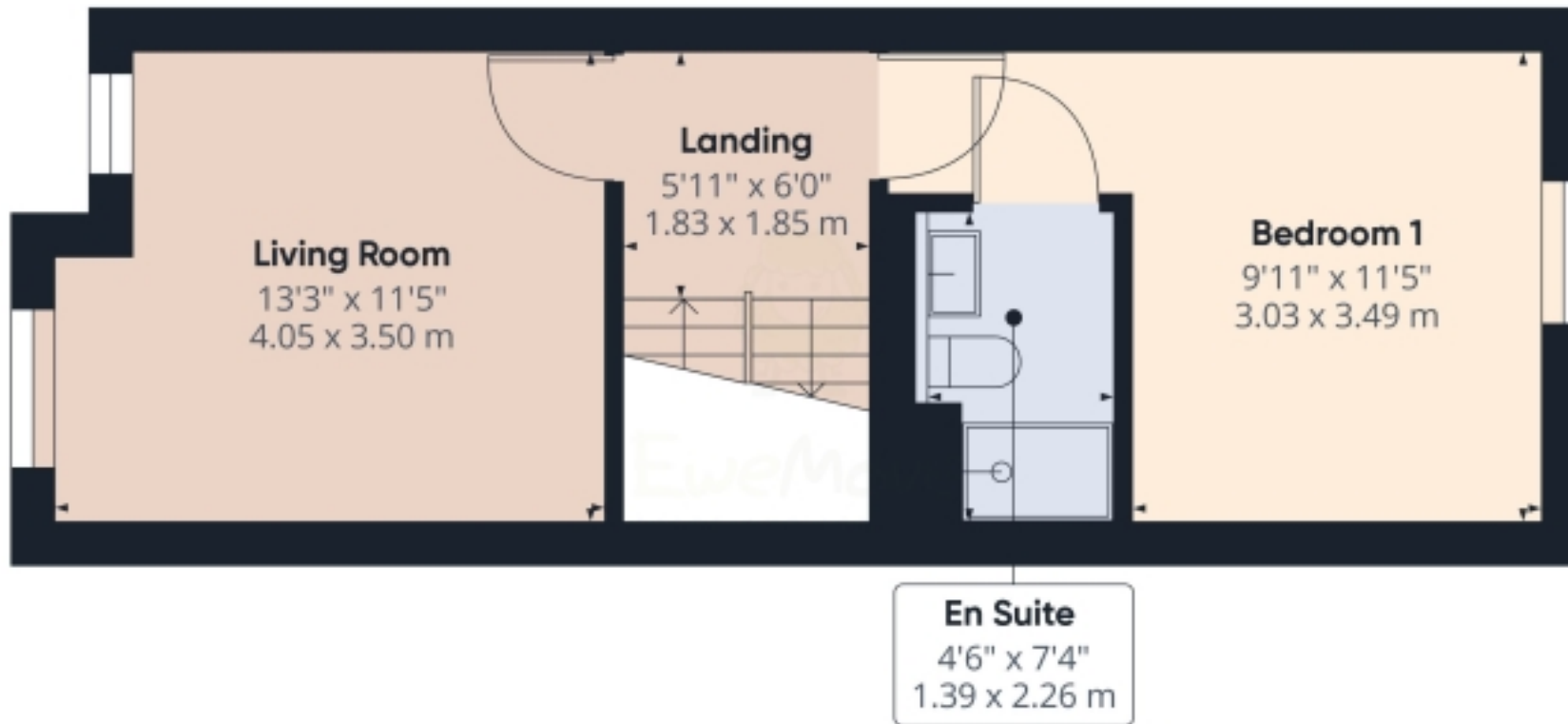

Approximate total area*
386.64 ft²
35.92 m²

(*) Excluding balconies and terraces

While every attempt has been made to ensure accuracy, all measurements are approximate, not to scale. This floor plan is for illustrative purposes only.

GIRAFFE 360

Floorplans

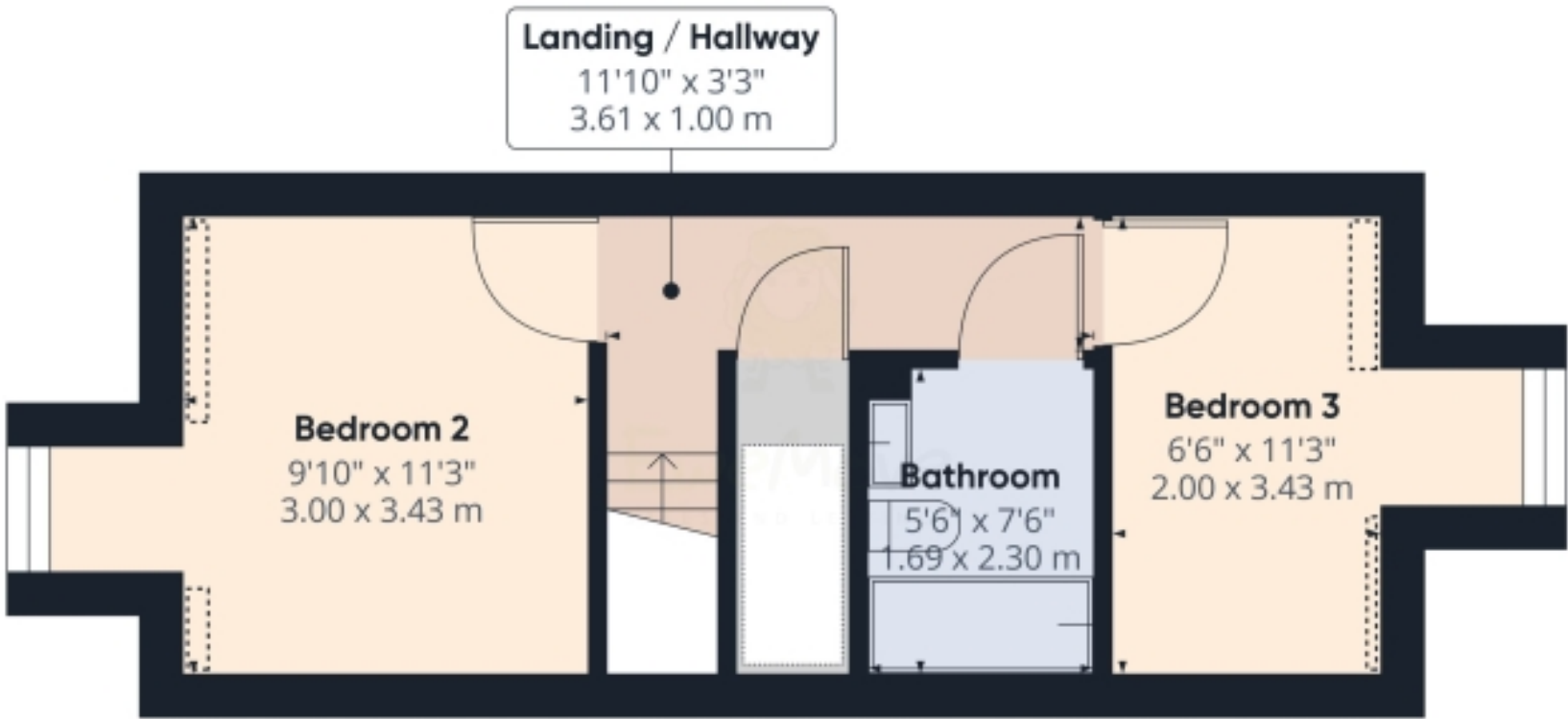

Approximate total area⁽¹⁾

302.47 ft²
28.1 m²

Reduced headroom

8.4 ft²
0.78 m²

(1) Excluding balconies and terraces

[] Reduced headroom
(below 1.5m/4.92ft)

While every attempt has been made to ensure accuracy, all measurements are approximate, not to scale. This floor plan is for illustrative purposes only.

GRAFFI 360

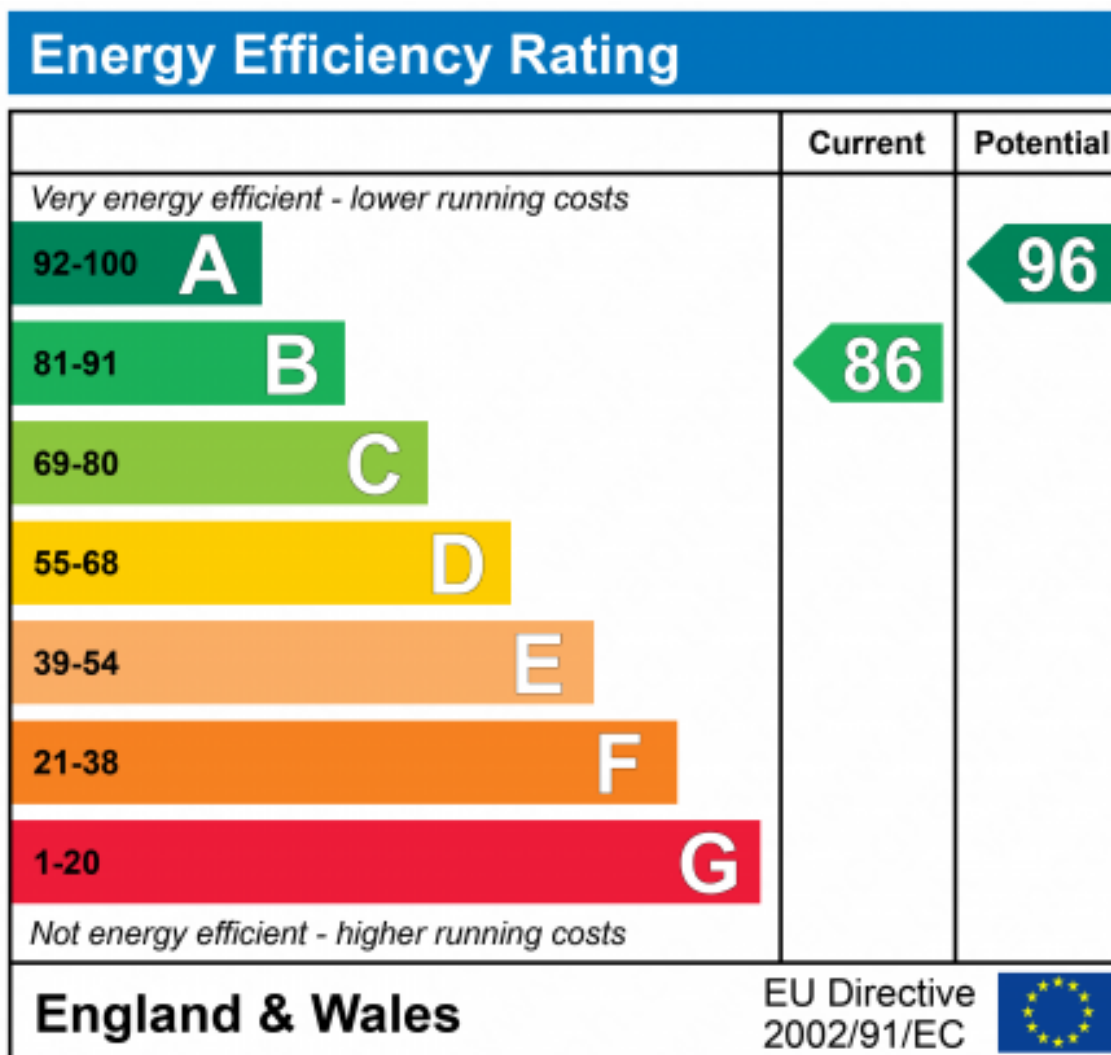



Marketed by EweMove Dartford & Greenhithe

020 3953 8023 (24/7)
dartford@ewemove.com

