



Alexander Jacob  
estate agents & company



**Mill Bridge Close**  
**Retford**

**Offers Over £70,000**

**Property & Estates Consulting**  
11 Grove Street, DN22 6JR

01777 566400  
[www.alexanderjacob.co.uk](http://www.alexanderjacob.co.uk)



# Mill Bridge Close

## Retford

Well Proportioned ONE BEDROOM Ground Floor Apartment

### Property Overview

- **\*\*INVESTOR OPPORTUNITY ONLY\*\***
- Gross Rental Yield of 6.75% if Purchased at the Asking Price
- Single Allocated Parking Space
- Located in the Heart of the Lively Market Town of Retford
- Council Tax Band: A EPC Rating: C



We are pleased to welcome this well proportioned ONE BEDROOM ground floor apartment to the market, briefly comprising of entrance hall, open plan kitchen lounge diner, bedroom and bathroom. Outside provides a single allocated parking space. Located in the heart of the lively town of Retford, the property is well within proximity of the array of amenities, leisure facilities, bars and restaurants the Georgian market town has to offer, alongside weekly open air markets on the town square.

*Road links are served by the A1 & M18 which offer greater transport links throughout the UK. Train stations are located in Retford & neighbouring towns, providing direct lines to King's Cross & Edinburgh.*



Only Floor  
46 sq m/495.13 sq ft  
Approx.

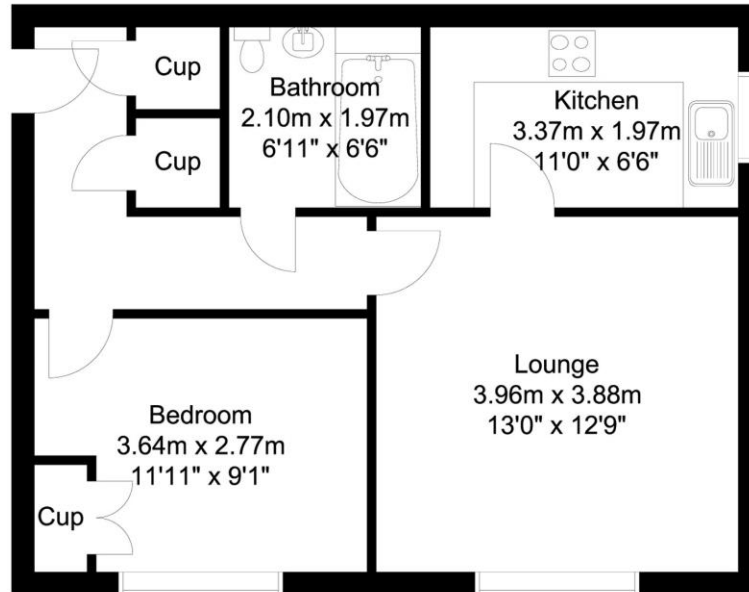

Whilst every attempt has been made to ensure the accuracy of the floor plan contained here, no responsibility is taken for incorrect measurements of doors, windows, appliances and rooms or any error, omission or misstatement. Exterior and interior walls are drawn to scale based on interior measurements. Any figure given is for initial guidance only and should not be relied on as a basis of valuation. The plans are for marketing purposes only and should only be used as such. No guarantee is given on the accuracy of the total square footage/ meterage if quoted on this plan. CP Property Services @2023

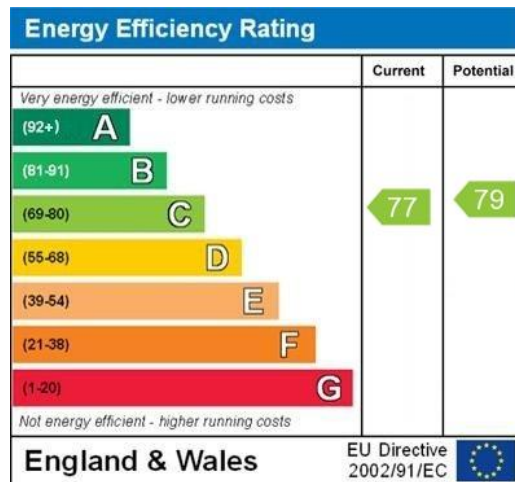

**Tenure & Charges:** Leasehold- Property to be sold with tenant on an Assured Shorthold Tenancy Agreement

## Selling your home?

If you are considering selling your home please contact us today for your no obligation free market appraisal.

Our dedicated and friendly team will assist you 6 days a week. Get in touch today!

Tel: 01777 566400



**Property & Estates Consulting**

11 Grove Street, Retford, DN22 6JR



01777 566400

[www.alexanderjacob.co.uk](http://www.alexanderjacob.co.uk)

IMPORTANT: we would like to inform prospective purchasers that these sales particulars have been prepared as a general guide only. A detailed survey has not been carried out, nor the services, appliances and fittings tested. Room sizes should not be relied upon for furnishing purposes and are approximate. If floor plans are included, they are for guidance only and illustration purposes only and may not be to scale. If there are any important matters likely to affect your decision to buy, please contact us before viewing the property.