

A HISTORIC BUILDING OFFERING CONTEMPORARY LIVING...

# St George's Mansions

*St George's Mansions* has been created by the restoration of the former St George's Hospital to form a collection of distinctive one, two and three bedroom apartments in a parkland setting close to the bustling heart of Stafford.

The development offers exciting options for all purchasers. Smaller apartments are ideal for first-time buyers or those seeking a secure investment, whilst a wide range of larger homes will appeal to those seeking more spacious and luxurious accommodation.

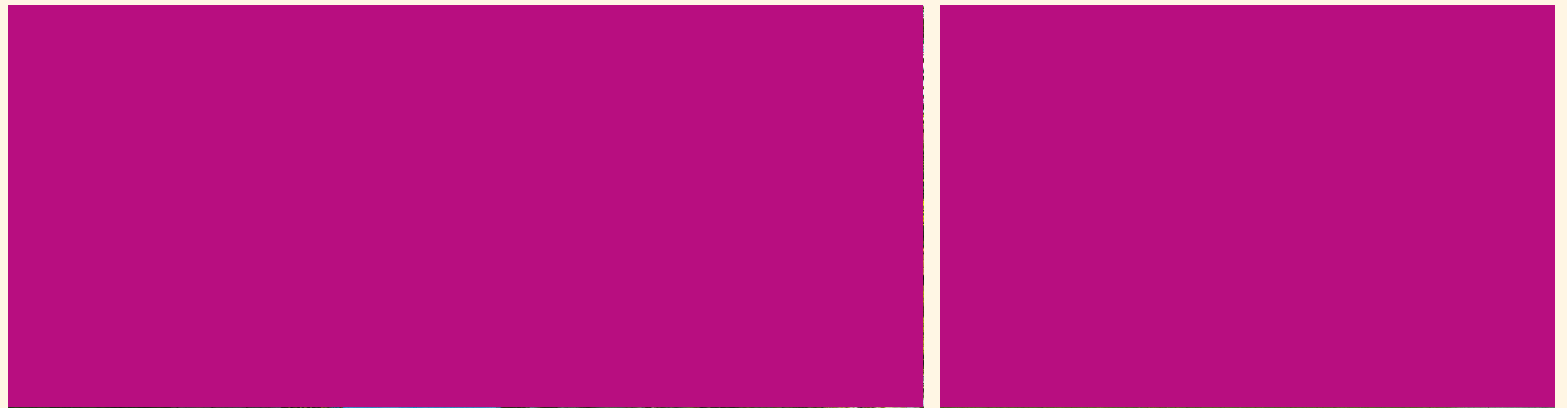

## SITE PLAN

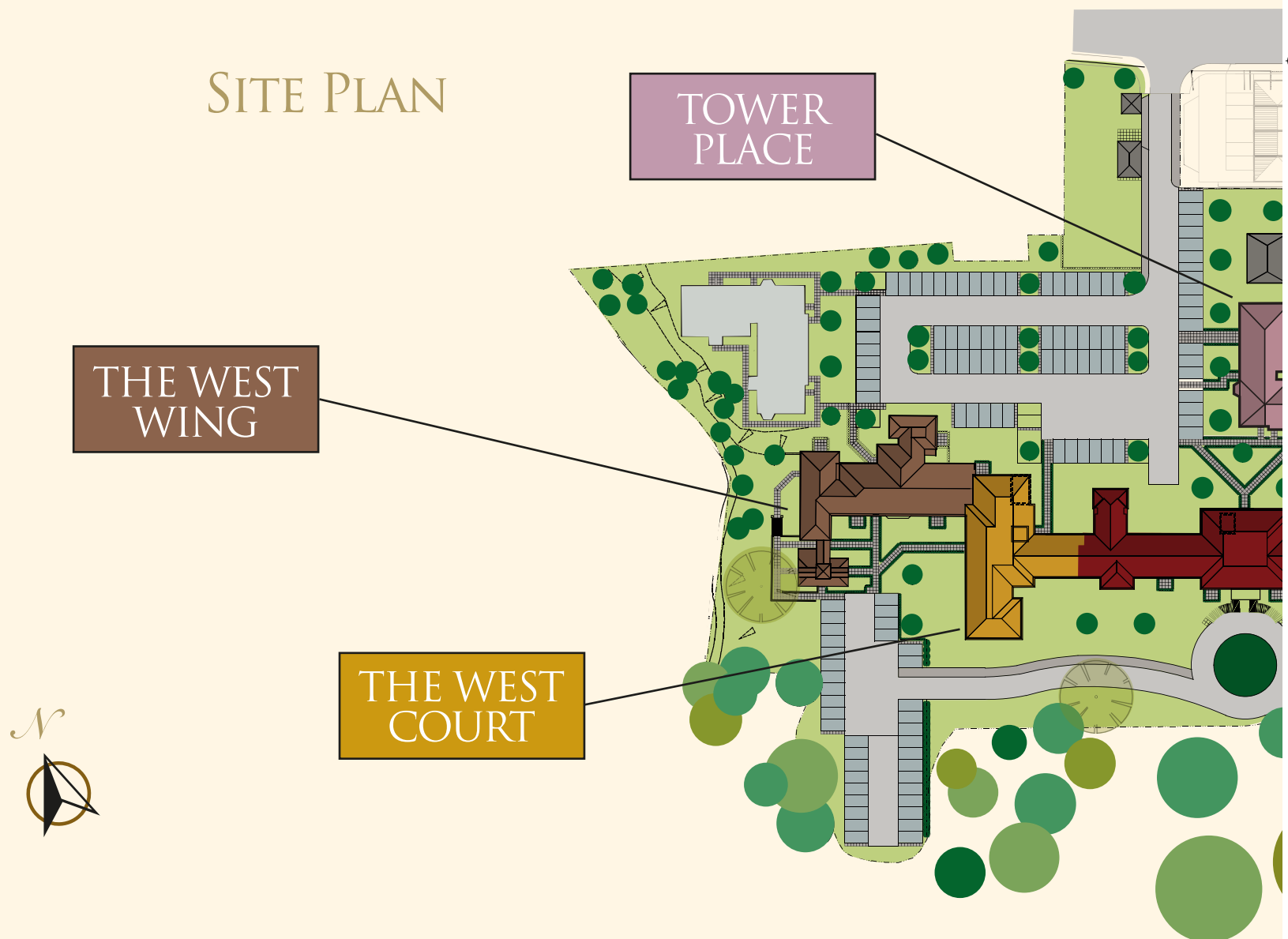

*Shropshire Homes* is an established company with a well-deserved reputation for creating homes that complement their environment. They have an impressive record of converting historic buildings into dwellings which combine the character of the past with the comfort and convenience of 21st century living.

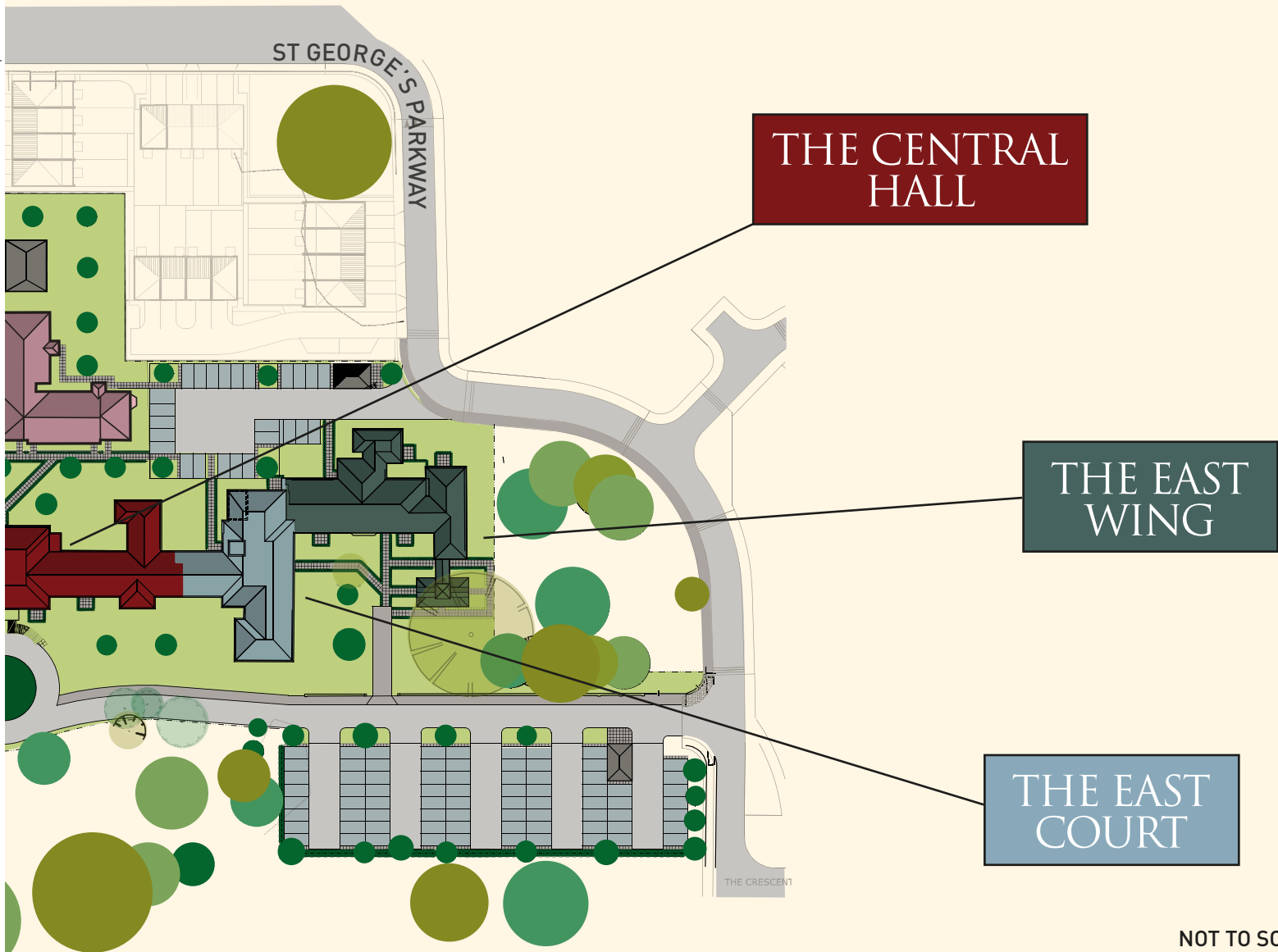
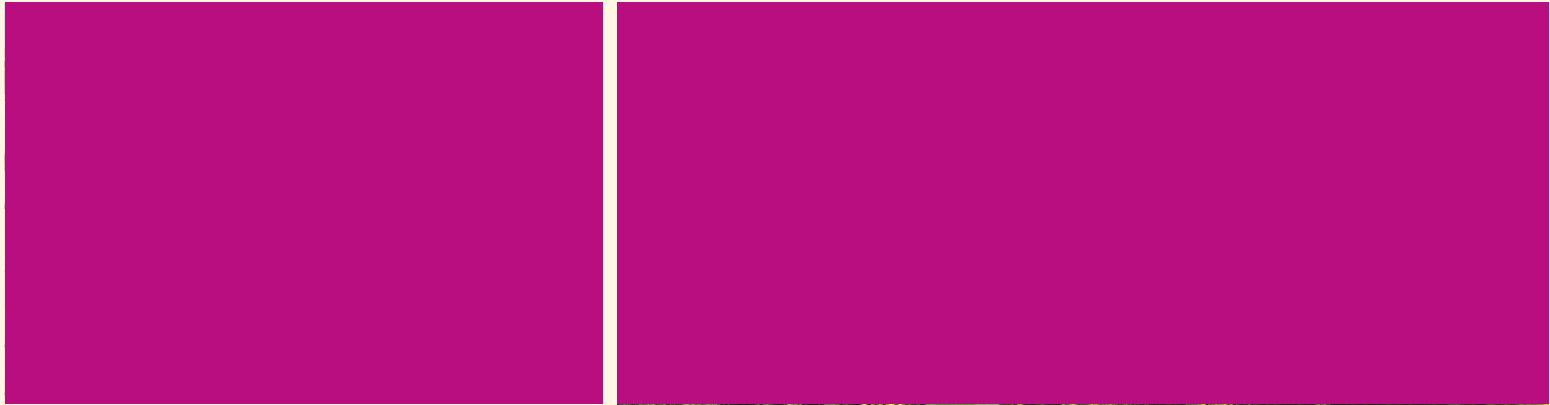
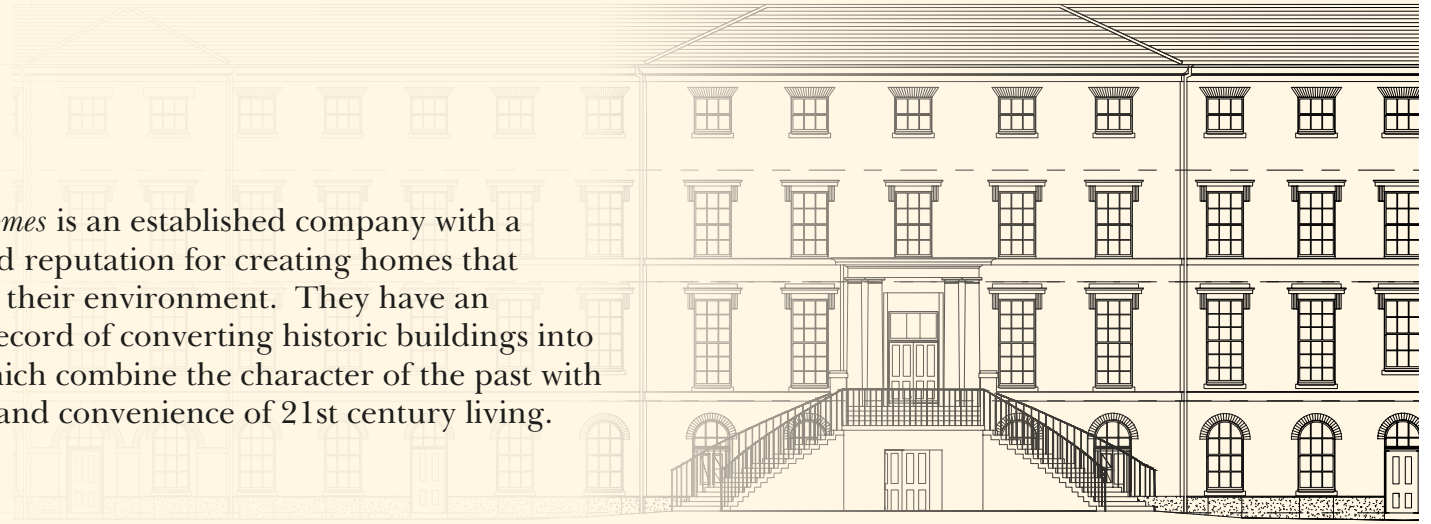

NOT TO SCALE

# SPECIFICATION

Every apartment will be finished to one of three specifications ~ silver, gold or platinum. This will allow purchasers to select an apartment that best suits their lifestyle and budget.

The Penthouse Apartments will be finished to a particularly high specification and enjoy magnificent views over Stafford and beyond.

Full details of each specification are available from our Sales Negotiator.

However the following will apply to all apartments (except where indicated):

- **NHBC Buildmark Warranty**
- **Lift access to most apartments**
- **Choice of quality kitchen with fitted appliances\***
- **Entry-phone security system**
- **Economic and efficient electric heating**
- **White bathroom suites with choice of tiles\***
- **Fitted wardrobes**
- **Allocated parking - one space for one bed apartment  
- two spaces for larger apartments, plus visitor spaces**

## TENURE

All apartments at St George's Mansions will be sold on a 199 year lease with an annual ground rent of £150 for smaller apartments and £250 for larger homes.

A service charge will be payable to cover buildings insurance, lift maintenance, lighting, cleaning and maintenance of common areas.

Please ask Sales Negotiator for full details.

\*As per specification at relevant stage