



Packington Street | Stoke | Plymouth | PL2 1HA

Guide £110,000-£115,000

A purpose built ground floor flat in Stoke Village.

A large, two double bedroom ground floor flat situated close to Stoke Village and all facilities, the property benefits from Upvc windows, gas central heating, fitted kitchen, far reaching views and an outside shed.

The property is currently let under an Assured Shorthold Tenancy at £7,500 per year with a potential to increase to £9,000 per year giving a gross potential yield of 8.1%.

- Two Double Bedrooms
- Ground Floor Flat
- Far Reaching Views To Rear
- Living Room
- Fitted Kitchen
- Proven Rental Income
- Popular Location



GROUND FLOOR

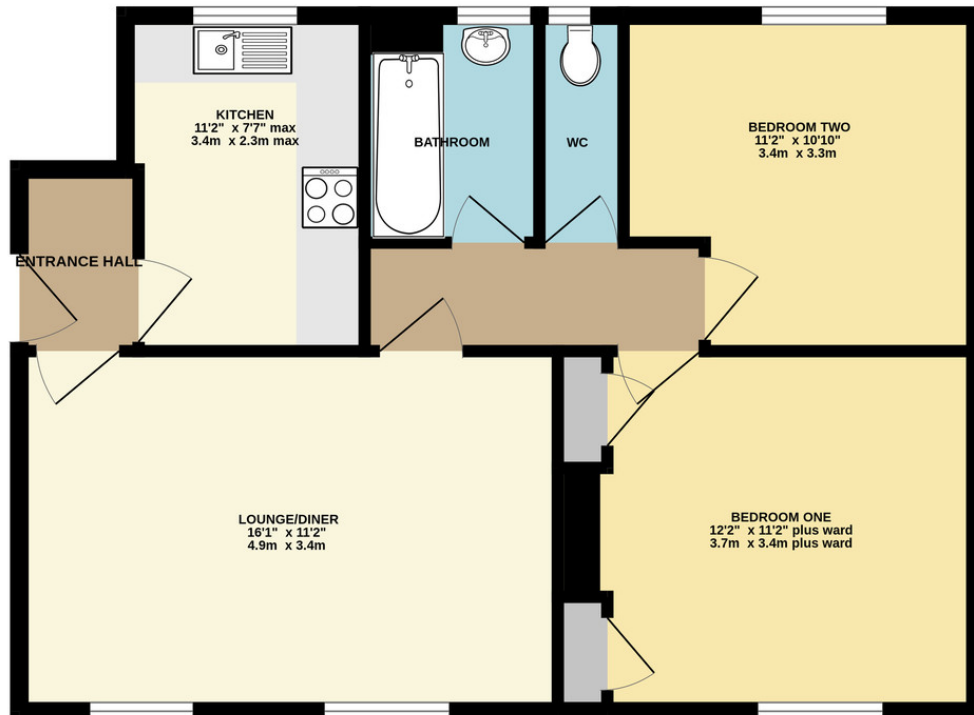

Contact Details

48 Ebrington Street
Plymouth
Devon
PL4 9AD

www.athomelettings.com
info@athomeproperty.co.uk
01752 777070

Energy Efficiency Rating

	Current	Potential
<i>Very energy efficient - lower running costs</i>		
(92+) A		
(81-91) B		
(69-80) C	71	74
(55-68) D		
(39-54) E		
(21-38) F		
(1-20) G		
<i>Not energy efficient - higher running costs</i>		
England & Wales	EU Directive 2002/91/EC	

Agents Note: Whilst every care has been taken to prepare these sales particulars, they are for guidance purposes only. All measurements are approximate are for general guidance purposes only and whilst every care has been taken to ensure their accuracy, they should not be relied upon and potential buyers are advised to recheck the measurements