



Carr Road Deepcar Sheffield S36 2UA
Guide Price £60,000

Carr Road

Sheffield S36 2UA

Guide Price £60,000

GUIDE PRICE £60,000-£65,000 ** NO CHAIN ** Located on the first floor is this well presented, one bedroom apartment which enjoys an attractive outlook and benefits from communal off-road parking and uPVC double glazing.

Ideally located with excellent public transport links with connections to Sheffield City Centre and Barnsley Interchange along with motorway links, good local schools and the Leisure Centre. There are fantastic amenities in Stocksbridge itself including supermarkets including Co-op, Lidl and Aldi as well as Fox Valley Shopping Centre. There is easy access to beautiful country walks in the Peak District and surrounding areas.

The property has been modernised in recent years and the living accommodation briefly comprises a private uPVC door opens into the entrance hall with access into the living area. An open doorway leads into the kitchen which has a range of units with a contrasting worktop which incorporates the sink and drainer. Integrated appliances include an electric oven and an induction hob along with housing and plumbing for an washing machine. From the living area, access into the inner lobby with a storage cupboard which houses the hot water tank and access into the double bedroom and the bathroom. The bathroom has a white three piece suite including bath with electric shower, WC and wash basin.

- SPACIOUS ONE BEDROOM APARTMENT
- FIRST FLOOR
- OPEN PLAN LIVING AREA
- KITCHEN
- THREE PIECE SUITE BATHROOM
- WELL-KEPT COMMUNAL GARDENS
- COMMUNAL OFF-ROAD PARKING
- FOX VALLEY SHOPPING CENTRE
- AMENITIES, LOCAL SCHOOLS & PUBLIC TRANSPORT LINKS
- EASY ACCESS TO SHEFFIELD & MOTORWAYS





OUTSIDE

Well-kept communal areas. Communal off-road parking.

LOCATION

Ideally located with excellent public transport links with connections to Sheffield City Centre and Barnsley Interchange. Motorway links. Good local schools. Stocksbridge Leisure Centre. Fantastic amenities in Stocksbridge itself including supermarkets including Co-op, Lidl and Aldi. Fox Valley Shopping Centre. Beautiful country walks in the Peak District and surrounding areas.

Funding of £24.1m has been unlocked to support a host of projects in Stocksbridge. The approval means that the Towns Fund projects – including the proposed £14.6m transformation of Stocksbridge town centre – can now move to the next stage in terms of planning and phasing the projects. The plans for the town include a transformation of Manchester Road with a new Library and Community Hub building at its heart. The development will house managed workspace as well as new community facilities. Investment in new paving and public realm in the town centre is also planned, as well as proposals for a shop front grant scheme to transform and regenerate the town's retail area. Other projects include improvements to sports, education and outdoor infrastructure.

MATERIAL INFORMATION

The property is Leasehold with a term of 999 years running from the 9th October 1982.
The property is currently Council Tax Band A.

VALUER

Greg Ashmore MNAEA

Whilst we endeavour to make our sales particulars fair, accurate and reliable, they are only a general guide to the property. If there is any point which is of particular importance to you, please contact the relevant office. The Agents have not tested any apparatus, equipment, fittings or services and so cannot verify they are in working order. The buyer is advised to obtain verification. All plans, floor plans and maps are for guidance purposes only and are not to scale. Please note all measurements are approximate and should not be relied upon as exact. Under no circumstances should they be relied upon as exact or for use in planning carpets and other such fixtures, fittings or furnishings. YOUR HOME IS AT RISK IF YOU DO NOT KEEP UP REPAYMENTS ON A MORTGAGE OR OTHER LOAN SECURED ON IT.

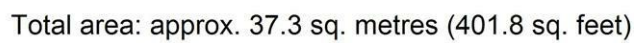
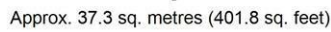

All measurements are approximate and to max vertical and horizontal lengths
Plan produced using PlanUp.

245 Crookes, Sheffield S10 1TF
82 Middlewood Road, Sheffield S6 4HA
462 Manchester Road, Sheffield S36 2DU

T: 0114 266 8365
T: 0114 231 6055
T: 0114 287 0112

