



Bocking Hill Stocksbridge Sheffield S36 2AL
Asking Price £469,995

Bocking Hill

Sheffield S36 2AL

Asking Price £469,995

Offering a harmonious blend of modern design and versatility, The Loxley provides four bedrooms, three bathrooms, and a single garage to provide the flexibility and luxury you deserve. The open-plan split-level living area with patio doors add an extra layer of sophistication to your everyday life.

Willow Heights is a brand new development of just 14 executive detached homes brought to you by Woodall Homes. Nestled amongst the picturesque landscape of Stocksbridge, North of Sheffield City Centre, this bespoke development harmoniously blends the natural beauty of the area, with each home constructed from local stone to create timeless architecture that lasts.

All homes at Willow Heights have been crafted with care ensuring each house embodies the essence of contemporary living and boasts an abundance of space and comfort. Finished to the highest standard throughout, homes at Willow Heights are welcoming and bright with impressive open-plan living areas. From exceptional integrated kitchen diners to generously-proportioned bedrooms, each room has been expertly designed, with a range of fantastic finishes and optional upgrades to choose from (subject to early reservation).

- CONTEMPORARY FOUR BED DETACHED FAMILY HOME
- EXCLUSIVE NEW DEVELOPMENT: WILLOW HEIGHTS, 14 EXECUTIVE DETACHED HOMES
- TIMELESS ARCHITECTURE: CONSTRUCTED FROM LOCALLY SOURCED STONE
- PICTURESQUE & CONVENIENT LOCATION: NESTLED IN THE SCENIC LANDSCAPE OF STOCKSBRIDGE AND CLOSE BY TO AMENITIES
- HIGH-QUALITY FINISHES: FINISHED TO THE HIGHEST STANDARD THROUGHOUT WITH BUYER CHOICES AVAILABLE
- CONTEMPORARY LIVING: PROVIDING SPACIOUS AND COMFORTABLE INTERIORS, OPEN-PLAN LIVING
- LANDSCAPED REAR GARDENS: PERFECT FOR RELAXATION AND OUTDOOR ENJOYMENT
- AWARD WINNING DEVELOPER: BROUGHT TO YOU BY WOODALL HOMES, NHBC WARRANTY
- COMPLETION: SPRING - SUMMER 24
- GARAGE & DRIVEWAY



OUTSIDE

Each property is finished with a beautifully landscaped rear garden, ready for you to enjoy the second you move in. Private and secluded, the garden is an extension to your home with patio or bi-fold doors providing access directly from the dining area. Whether you need a space for children to play or a fabulous entertaining spot - these homes provide everything you could need all in one space, complete with driveway and garage.

DISCLAIMER

Please note that we have endeavoured to portray a reasonable account of the properties we are advertising. However, images used are for illustrative purpose only. The floor plans are for guidance only and may be subject to change. Properties may be "handed" or mirror images of the plans shown.

Whilst we endeavour to make our sales particulars fair, accurate and reliable, they are only a general guide to the property. If there is any point which is of particular importance to you, please contact the relevant office. The Agents have not tested any apparatus, equipment, fittings or services and so cannot verify they are in working order. The buyer is advised to obtain verification. All plans, floor plans and maps are for guidance purposes only and are not to scale. Please note all measurements are approximate and should not be relied upon as exact. Under no circumstances should they be relied upon as exact or for use in planning carpets and other such fixtures, fittings or furnishings. YOUR HOME IS AT RISK IF YOU DO NOT KEEP UP REPAYMENTS ON A MORTGAGE OR OTHER LOAN SECURED ON IT.

Ground Floor

Approx. 54.0 sq. metres (580.9 sq. feet)

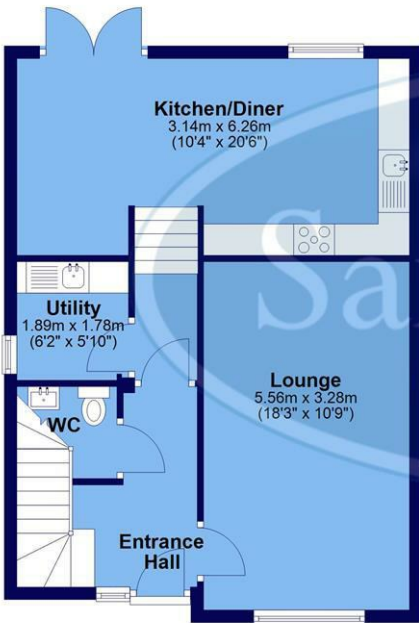

First Floor

Approx. 54.0 sq. metres (580.9 sq. feet)

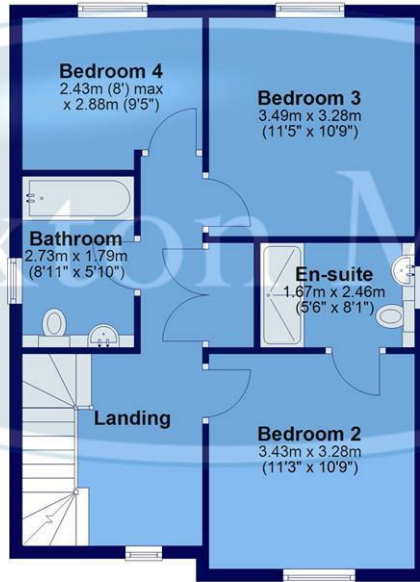

Second Floor

Approx. 47.1 sq. metres (507.3 sq. feet)

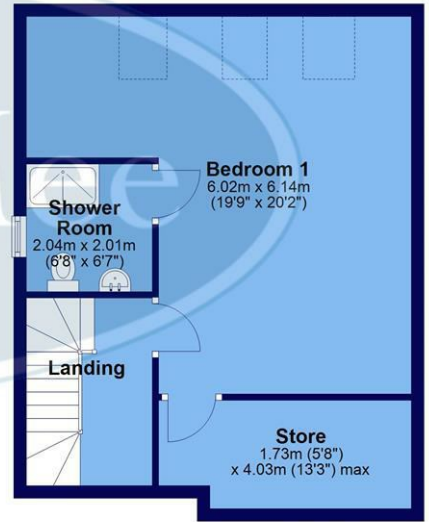

Total area: approx. 155.1 sq. metres (1669.1 sq. feet)

All measurements are approximate and to max vertical and horizontal lengths
Plan produced using PlanUp.

Crookes 245 Crookes, Sheffield S10 1TF T: 0114 266 8365
Hillsborough 82 Middlewood Road, Sheffield S6 4HA T: 0114 231 6055
Stocksbridge 462 Manchester Road, Sheffield S36 2DU T: 0114 287 0112

www.saxtonmee.co.uk

