



Rudston Road, Childwall

£270,000 Council Tax Band C EPC Rating D

 3  1  2



A lovely family home! This three bedroom semi detached home should be of particular interest to families who are ready to create many happy memories; whether that be enjoying meals together in the stunning open plan dining/living area, or hosting family BBQs in the south facing rear garden over the summer! Interior: hallway, dining room, living room and kitchen to the ground floor. Upstairs are three bedrooms and the family bathroom. Exterior: lovely sunny rear garden, and a good-sized double driveway to the front. Viewing of this superb abode is essential!

Key Features

- Three Bedroom Semi Detached
- Double Driveway
- EPC Rating D
- South Facing Rear Garden
- Council Tax Band C

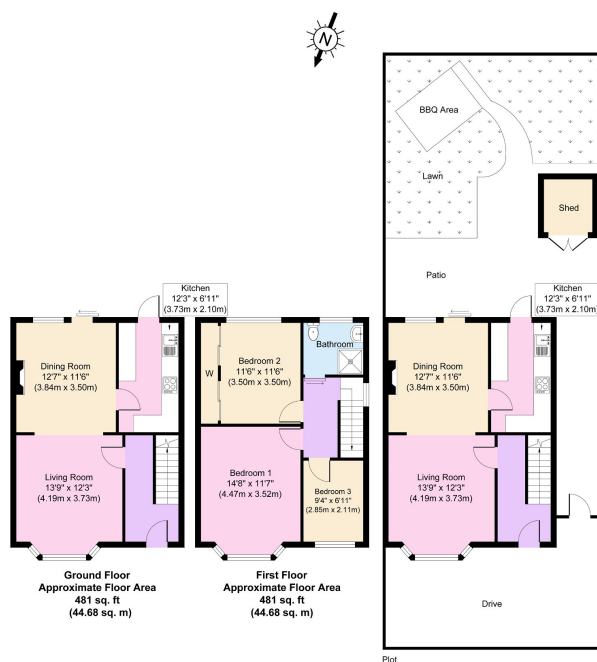

Copyright V360 Ltd 2023 | www.houseviz.com