



11 Tobin Street

£189,950 Council Tax Band B EPC Rating C

 3  1  2



Set on an elevated position only a stones throw to Egremont promenade and offering fantastic river views this lovely \freshly decorated three-bedroom semi-detached house is one not to be missed! A real loving and welcoming feel throughout with front and rear garden, along with electric roller shutter meaning you can park in your back garden if required. Interior: porch, inviting hallway, dining room, living room, and kitchen on the ground floor. Off the first-floor landing there are the three bedrooms and family bathroom. Complete with uPVC double glazing and gas central heating. Exterior: sunny rear garden with roller shutter access and front garden with pond and pathway to the promenade. Be quick to view!

Key Features

- Three Bed Semi Detached
- Sunny Front and Rear Gardens
- EPC Rating C
- River Views Over To Liverpool
- Council Tax Band B
-
-
-

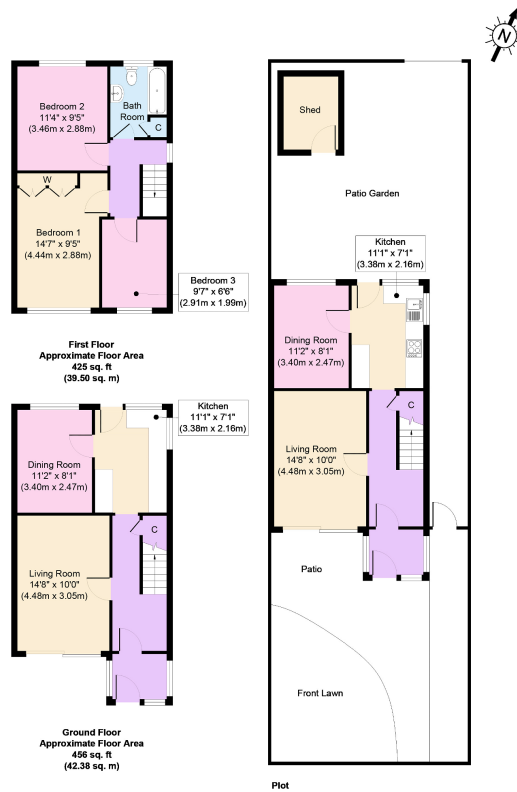

Copyright V360 Ltd 2021 | www.houseviz.com