





Welcome to this charming property located on Dock Head Road in the picturesque town of Gillingham, Medway. This delightful house boasts a cosy reception room, perfect for relaxing after a long day. With one spacious bedroom, you'll have plenty of room to unwind and recharge.

This luxury one bed apartment is situated on the the ground floor at The Quays in Chatham Maritime. Offered as a furnished property with a tenant in situ benefitting from a yield of 6.91% or as as chain freeze with vacant possession.





- White high gloss kitchen
- Onsite gym, cinema, retail shopping and restaurants
- Fitted wardrobes
- Allocated parking
- Ground Floor
- Commutable Location to London



THE AGENT ON THE QUAYS

Company Reg Number: 08789210 - Registered Office: 12, Station Court, Station Approach, Wickford, Essex, SS11 7AT

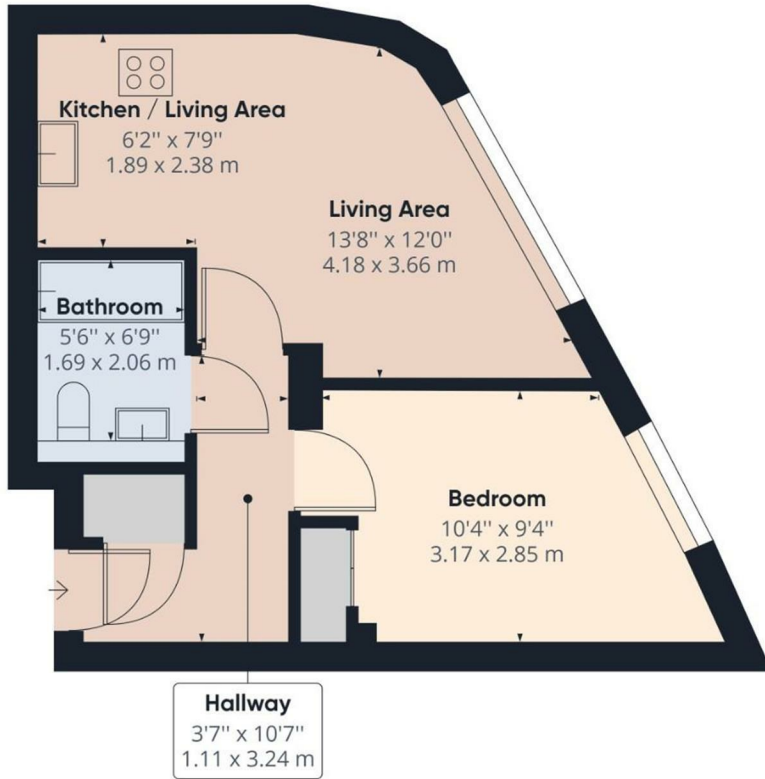

Approximate total area⁽¹⁾

417.51 ft²
38.79 m²

(1) Excluding balconies and terraces

While every attempt has been made to ensure accuracy, all measurements are approximate, not to scale. This floor plan is for illustrative purposes only.

GIRAFFE 360