



Ashurst Close, Anerley

Offers In Excess Of £275,000



Property Summary

Bought As Seen!

Propertyworld offers to the Sales Market, this modern build, two bedroom, purpose built flat to the Sales market. In need of complete modernisation - which has been reflected in the asking price, this apartment has a lot to offer!

Surrounded by beautifully LANDSCAPED LAWNS, residents enjoy leafy TRANQUIL VIEWS from every aspect, combining modern living requirements within a quiet yet, convenient cul-de-sac location.

Allocated on the top floor of small modern build block, the lounge boasts dual aspect views with a large window area, exaggerating the lawned views. The kitchen leads off the lounge and ready for you to create a kitchen designed by you!

Both bedroom generously sized - being one double and one single.

In the bathroom, there's a three piece suite -ready to be modified to your individual taste

Additional benefits include double glazing, allocated parking and entry phone security.

This quiet and spacious flat, surrounded by greenery, makes it hard to believe how easily you can access the hustle and bustle of city life.

With the Crystal Palace Triangle close by, there are many bars and restaurants to be enjoyed at your leisure. Located in the upper part of Penge, this property is just a short walk from Anerley train station. It also has easy access to both Crystal Palace and Penge East stations, offering a number of options for an easy commute into town.

Penge Sales

020 8659 1005

www.propertyworlduk.net

Property Summary

- Two bedrooms
- Purpose built Flat
- In need of complete modernisation throughout
- Top floor accommodation
- Lounge in excess of 16ft x 10ft
- Gorgeous surround landscaped lawns
- No onward chain
- Leasehold Tenure with long lease term
- Epc rated D
- Council Tax band C

Our Vendor Loves...

This is a great flat. When you are here, its hard to believe you are in Penge. The flat is so bright and airy and the block is well maintained.





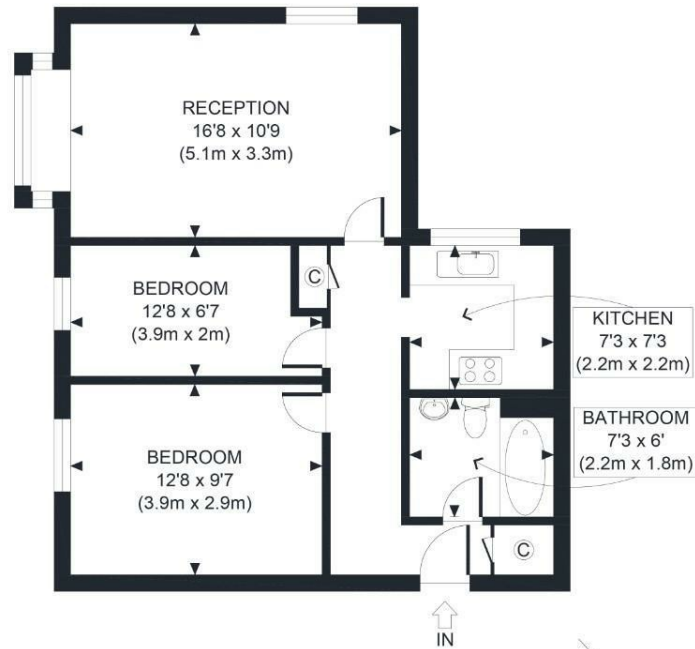

GROUND FLOOR
GROSS INTERNAL
FLOOR AREA 602 SQ FT

APPROX. GROSS INTERNAL FLOOR AREA 602 SQ FT / 56 SQM

Disclaimer: Floor plan measurements are approximate and are for illustrative purposes only. While we do not doubt the floor plan accuracy and completeness, you or your advisors should conduct a careful, independent investigation of the property in respect of monetary valuation

Ashurst close

date 12/05/25

photoplan

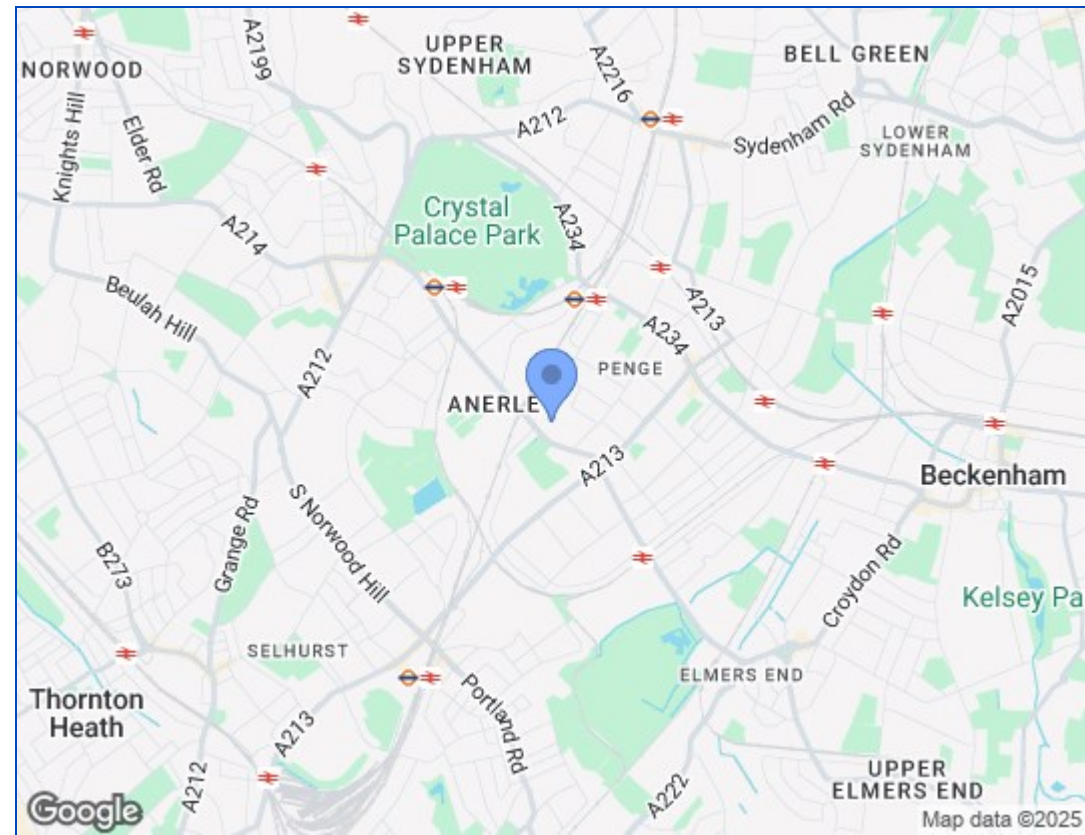

Energy Efficiency Rating		
	Current	Potential
Very energy efficient - lower running costs		
(92 plus) A		
(81-91) B		
(69-80) C		
(55-68) D		
(39-54) E	63	71
(21-38) F		
(1-20) G		
Not energy efficient - higher running costs		
England & Wales	EU Directive 2002/91/EC	

These particulars, whilst believed to be accurate are set out as a general outline only for guidance and do not constitute any part of an offer or contract. Intending purchasers should not rely on them as statements of representation of fact, but must satisfy themselves by inspection or otherwise as to their accuracy. No person in this firm's employment has the authority to make or give any representation or warranty in respect of the property.

