



A TWO DOUBLE BEDROOM APARTMENT located in an ART DECO BUILDING, CLOSE TO THE CITY CENTRE, SEAFRONT and BRIGHTON STATION. The accommodation comprises, LOUNGE/DINING ROOM, FITTED KITCHEN, BATHROOM, EN-SUITE SHOWER ROOM, COMMUNAL ROOF GARDEN, EPC D.

- CONTEMPORARY CITY APARTMENT
- ART DECO BUILDING
- CLOSE TO CITY CENTRE
- SPACIOUS LIVING
- FULLY FITTED KITCHEN
- TWO DOUBLE BEDROOMS
- EN SUITE SHOWER
- MODERN BATHROOM
- COMMUNAL ROOF GARDEN
- PASSENGER LIFT





FIRST FLOOR

ENTRANCE HALL

Ceiling spotlights, video entry phone, laminate wood flooring, electric radiator.

LOUNGE/DINING ROOM

East aspect double glazed windows, recessed downlighting, storage cupboard housing water cylinder, laminate wood flooring, electric radiator, open to:

KITCHEN

Fitted with units comprising eye level wall cupboards and base cupboard and drawer units with corian working surfaces over, inset stainless steel one and a quarter bowl sink units with mixer tap, integrated appliances to include electric oven, four ring electric hob with extractor fan over, microwave, fridge/freezer, dishwasher, washer dryer, recessed downlighting, laminate wood floor.

BEDROOM 1

East aspect double glazed windows, fitted wardrobe, electric radiator, door to:

EN SUITE SHOWER ROOM

Fitted with white suite comprising, tiled shower cubicle, pedestal wash hand basin with mixer tap, WC with concealed cistern, recessed downlighting, tiled walls, tiled floor, chrome ladder style heated towel rail, extractor fan.

BEDROOM 2

East aspect double glazed windows, recessed downlighting, electric radiator.

BATHROOM

Fitted with white suite comprising panel bath with mixer tap and shower attachment, screen to side, pedestal wash hand basin with mixer tap, WC with concealed cistern, recessed downlighting, tiled walls, tiled floor, chrome ladder style heated towel rail, extractor fan.

EXTERNAL

COMMUNAL ROOF TERRACE

Accessed from communal hallway, wooden decking, split levels.

ADDITIONAL INFORMATION

Lease - 150 years

Maintenance - Variable

Ground Rent - £250

Council Tax Band C - £2,182.92



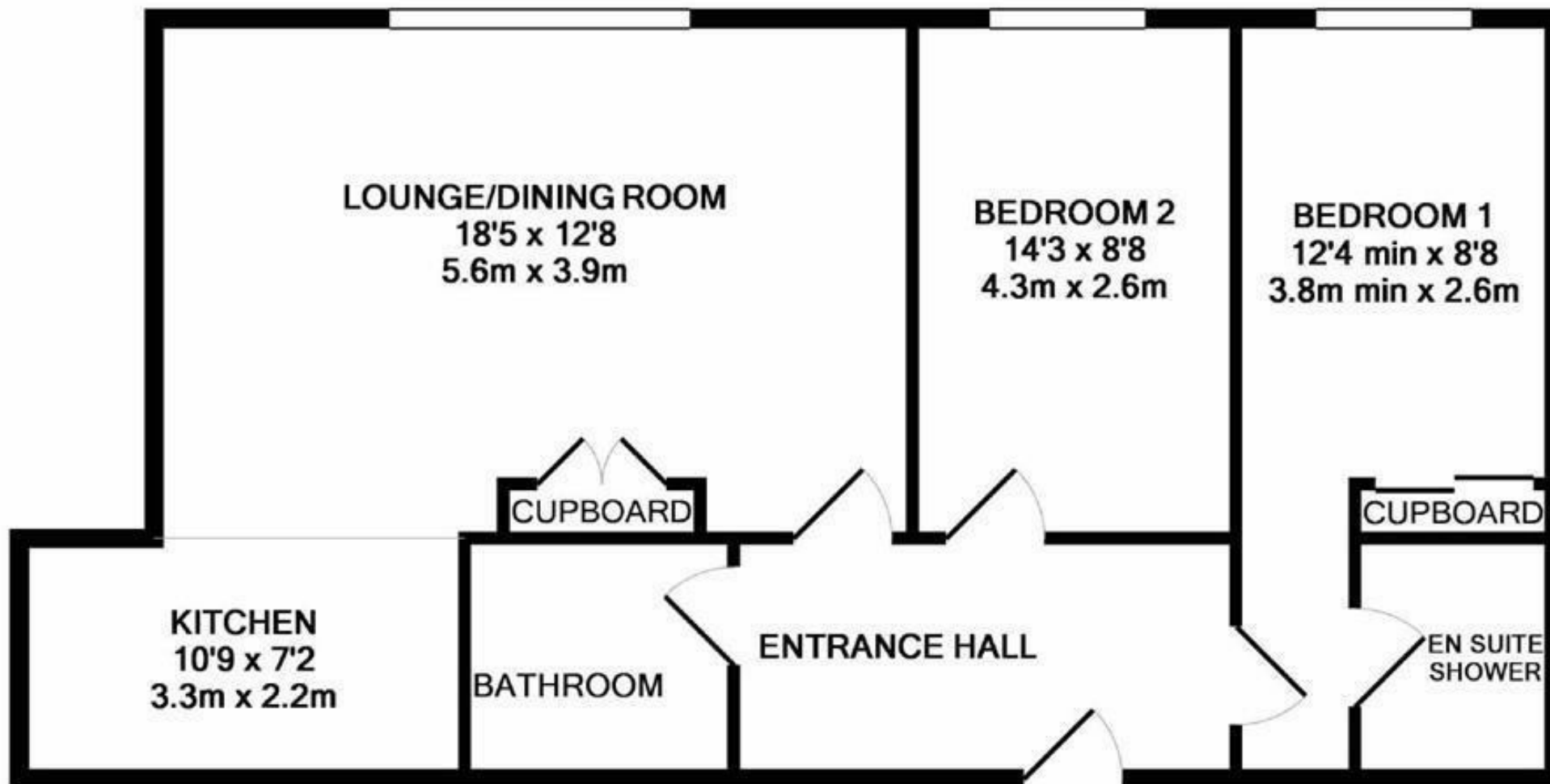

TOTAL APPROX. FLOOR AREA 775 SQ.FT. (72.0 SQ.M.)

Whilst every attempt has been made to ensure the accuracy of the floor plan contained here, measurements of doors, windows, rooms and any other items are approximate and no responsibility is taken for any error, omission, or mis-statement. This plan is for illustrative purposes only and should be used as such by any prospective purchaser. The services, systems and appliances shown have not been tested and no guarantee as to their operability or efficiency can be given

Made with Metropix ©2017



ENERGY PERFORMANCE CERTIFICATE (EPC)

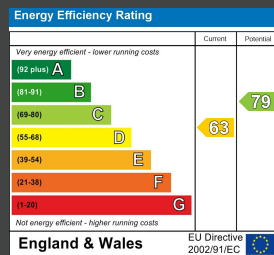

Council Tax Band: C

Maintenance: n/a

Lease Length: n/a

Ground Rent: n/a

Tel: 01273 323000

Email: sales@brices.co.uk

www.brices.co.uk

DISCLAIMER

Money Laundering Regulations 2007: Intending purchasers will be asked to produce identification documentation upon acceptance of any offer. We would ask for your cooperation in producing such in order that there will not be a delay in agreeing the sale. General: Whilst we endeavour to make our sales particulars fair, accurate and reliable they are only a general guide to the property and accordingly if there is any point which is of particular importance to you please contact the office and we will be pleased to check the position for you. Buyers must check the availability of any property and make an appointment to view, before embarking on any journey to see a property. Items shown in photographs are NOT included unless specifically mentioned within the sales particulars. They may however be available by separate negotiation. Measurements: These approximate room sizes are only intended as general guidance. You must verify the dimensions carefully before ordering carpets or any built in furniture. Services: Please note we have not tested any apparatus, equipment, fixtures and fittings or services and so cannot verify that they are in working order or fit for the purpose. A Buyer is advised to obtain verification from their Solicitor or Surveyor. References to the Tenure of a Property are based on information supplied by the Seller. The Agent has not had sight of the title documents. A Buyer is advised to obtain verification from their Solicitor. These particulars are issued in good faith but do not constitute representations of fact or form part of any offer or contract.

360°
brices
VIRTUAL VIEWINGS

brices
sales & lettings