



BRIDGE  
HOUSE

CHURCH ROAD • FLEET • HAMPSHIRE

A NAME YOU CAN TRUST



Blue Prior, Church Crookham



Equinox Place, Farnborough



Cliddesden Place, Basingstoke

T A Fisher has a tradition and heritage that are difficult to match. You will find our values reflected in every home created – quality, excellence, craftsmanship and value are guaranteed. Don't take our word for it – we have already proved our reputation many times over with stunning local developments throughout the Thames Valley.

In more recent years we have gained a reputation for revitalising and reforming older buildings and effectively instilling a new lease of life. Examples can be found in Camberley, Bracknell, Crowthorne and several in Reading town centre.

DESIGN EXCELLENCE

**T A FISHER**  
CREATING VALUE IN PROPERTY



Fleet Station



Fleet High Street



Fleet Pond



Waitrose at Hart Shopping Centre



Hart Shopping Centre

**Fleet is in the heart of the Blackwater Valley, 40 miles south west of Central London, 17 miles south east of Reading and 15 miles west of Guildford.**

Thanks to its fantastic transport links, desirable countryside surroundings, good local schooling and low crime rates, Fleet has been **voted the best place to live in the UK** by the Halifax Quality of Life Study every year since 2011.

**Bridge House is perfectly located on Church Road**, a short walk from many high street amenities. There is everything you need on your doorstep including coffee shops, restaurants and beauty salons.

Fleet offers a range of **shopping** from big supermarkets to a regular farmers market packed with freshly picked, bottled and baked goods.

The **Hart Shopping Centre** is a busy retail destination located in the heart of Fleet. It is anchored by a 30,000 sq ft Waitrose Supermarket. The town centre is also home to a number of national multiples including WH Smith, Argos, Boots, The Works and Clarks.

Excellent **leisure** facilities include Fitness First, Hart Leisure Centre, Hart Squash Club, North Hants Golf Club, The Spa at Four Seasons Hotel, Isvara Yoga and Avondale Lawn Tennis Club.

**Vue** Farnborough is a convenient state-of-the art multiscreen cinema.

There are **many outdoor spaces** to enjoy in the spectacular Hampshire countryside, including nearby Fleet Pond and the Basingstoke Canal.

The town has fourteen Ofsted 'Outstanding' **primary and secondary schools** nearby.

For the **commuter**, Bridge House could not be better situated. Fleet station is positioned a 12 minute walk away, giving you easy access to London Waterloo in under 45 minutes, Basingstoke in 12 minutes, Woking in 16 minutes and Winchester in 29 minutes.

Fleet is only 3 miles from Junction 4a of the **M3 motorway** which connects to the M25 and provides access to Heathrow Airport in 31 minutes.



Bridge House combines stylish residential apartments with High Street convenience.

Bridge House is the latest property to benefit from T A Fisher's skills and green approach to development.

The upper floors of Bridge House will comprise a selection of stylish studios and appealing one and two bedroom apartments. Designed and equipped for 21st century living including electric heating, fully fitted kitchens, contemporary bathrooms and a generous provision of fitted wardrobes which are so important for apartment living. It's not just the interiors that will look smart and stylish – the external elevations are being uplifted so that Bridge House stands out in the High Street as being a very attractive proposition.

These superb apartments will appeal to buyers looking to get onto the housing ladder and serious property investors alike.





A HOME ON THE HIGH STREET



## THE DEVELOPMENT

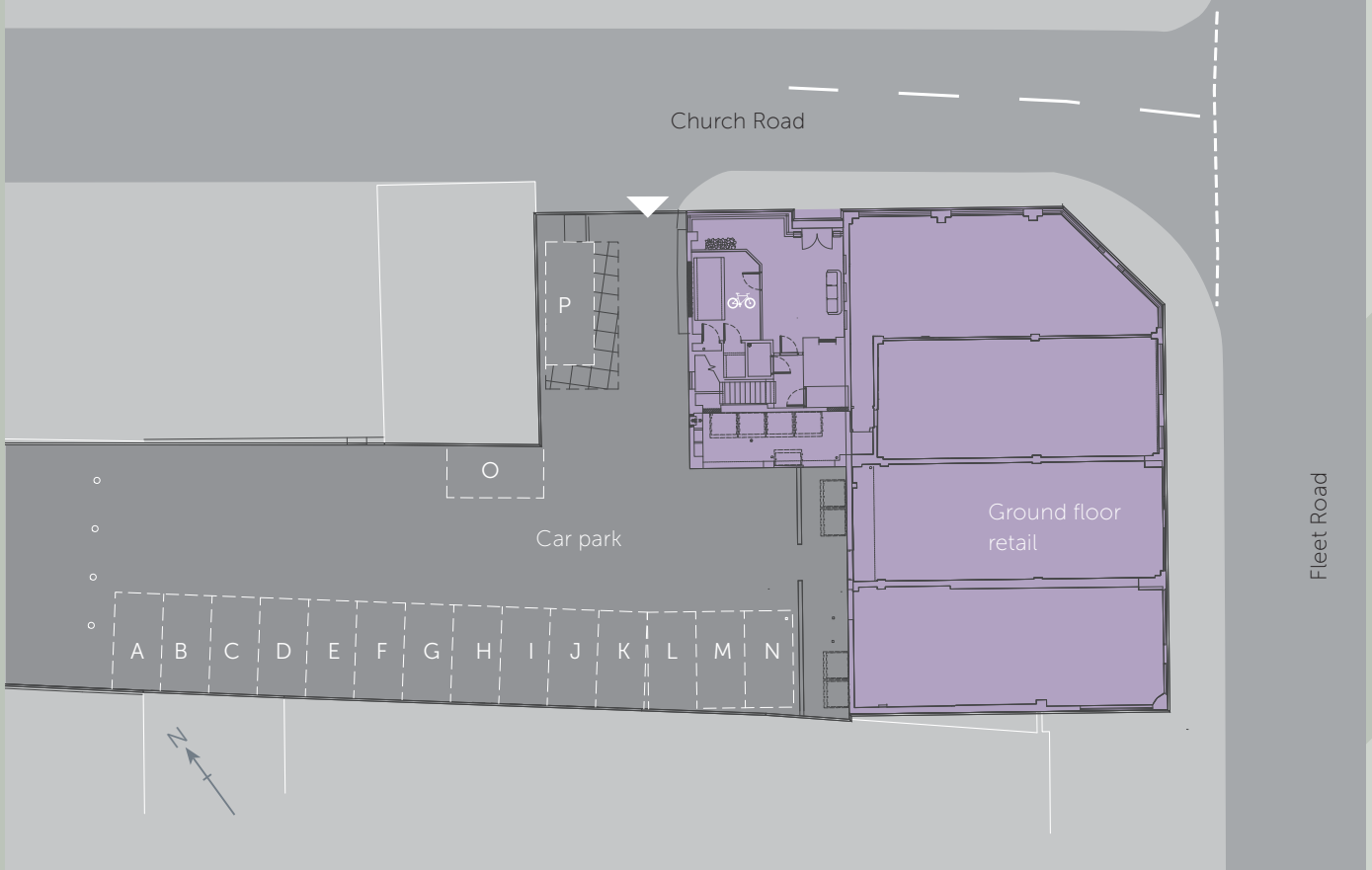

Apartment	Size sq ft	mm	ft
<b>1</b>	435		
Kitchen/dining/living		6630 x 3125	21'9 x 10'3
Bedroom		3243 x 2925	10'7 x 9'7
Bathroom		2290 x 1563	7'6 x 5'1
<b>2</b>	418		
Kitchen/dining/living		5075 x 3775	16' 7 x 12'4
Bedroom		3360 x 2725	11'0 x 8'11
Bathroom		2457 x 1900	8'0 x 6'2
<b>3</b>	485		
Kitchen/dining/living		5758 x 5400	18'10 x 17'8
Bedroom		3425 x 2739	11'3 x 8'11
Bathroom		2224 x 1654	7'3 x 5'5
<b>4</b>	401		
Kitchen/dining/living		6010 x 3191	19'8 x 10'5
Bedroom area		2876 x 2704	9'5 x 8'10
Bathroom		2225 x 1600	7'3 x 5'2

Apartment	Size sq ft	mm	ft
<b>5</b>	383		
Kitchen/dining/living		6473 x 2799	21'2 x 9'2
Bedroom area		2890 x 2421	9'5 x 7'11
Bathroom		2250 x 1613	7'4 x 5'3
<b>6</b>	381		
Kitchen/dining/living		6010 x 2901	19'8 x 9'6
Bedroom		3192 x 2958	10'5 x 9'8
Bathroom		2240 x 1613	7'4 x 5'3
<b>7</b>	491		
Kitchen/dining/living		7715 x 3377	25'4 x 11'1
Bedroom area		3293 x 3191	10'10 x 10'6
Bathroom		2250 x 1613	7'4 x 5'3
<b>8</b>	594		
Kitchen/dining/living		6698 x 3911	21'11 x 12'9
Bedroom 1		3537 x 3191	11'7 x 10'5
Bedroom 2		3732 x 2328	12'2 x 7'7
Bathroom		2250 x 1613	7'4 x 5'3

## FIRST FLOOR

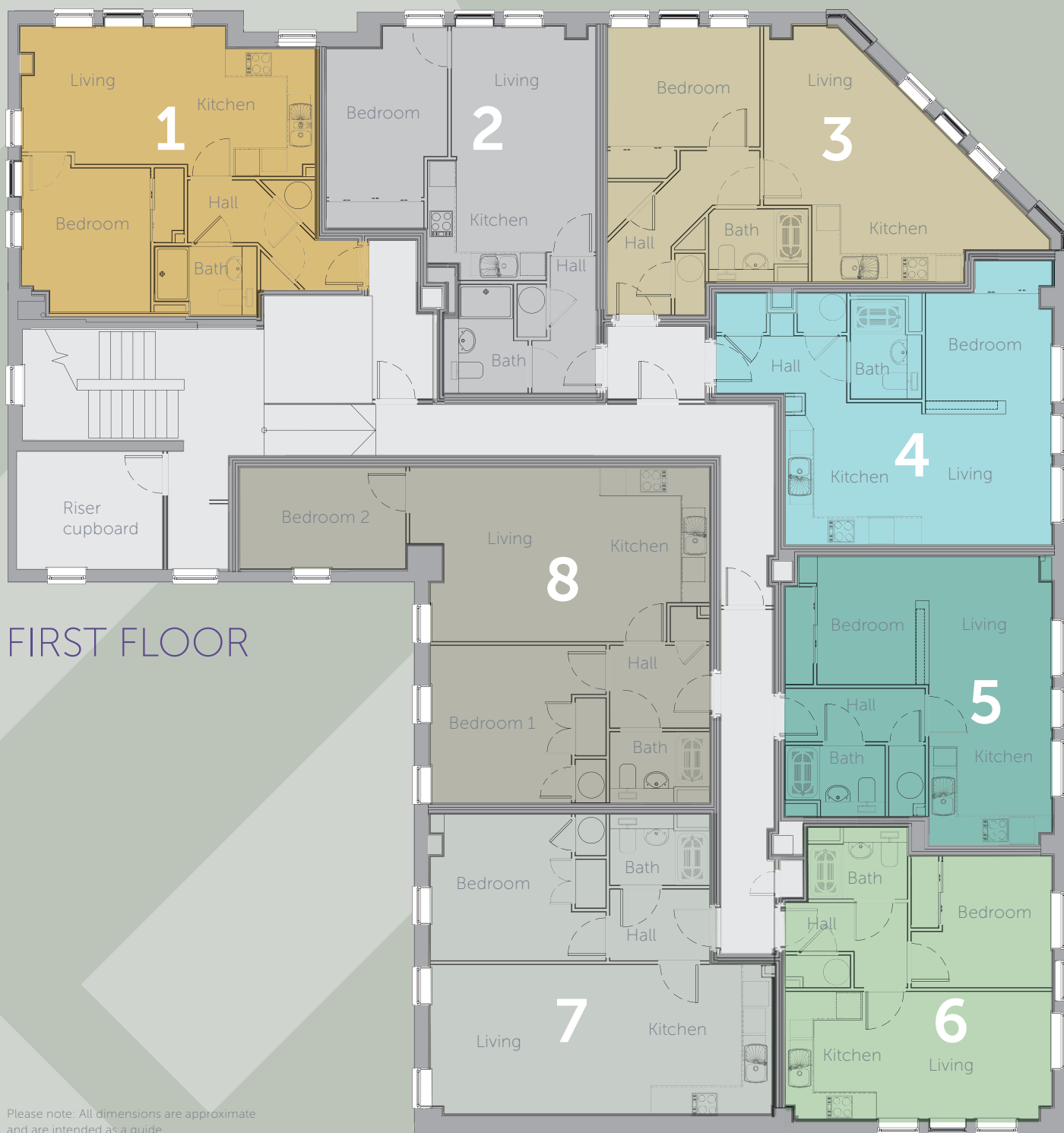

## FIRST FLOOR

Please note: All dimensions are approximate and are intended as a guide.

Dimensions should not be used for carpet sizes or items of furniture.

We operate a policy of continuous product development and individual features such as windows may vary from time to time.

Apartment	Size sq ft	mm	ft
<b>9</b>	436		
Kitchen/dining/living		6110 x 3583	20'1 x 11'9
Bedroom		3488 x 2581	11'5 x 8'6
Bathroom		2250 x 1596	7'5 x 5'3
<b>10</b>	429		
Kitchen/dining/living		6150 x 3623	20'2 x 11'11
Bedroom		3497 x 3081	11'6 x 10'1
Bathroom		2241 x 16130	7'4 x 5'4
<b>11</b>	509		
Kitchen/dining/living		6050 x 5265	19'10 x 17'3
Bedroom		4100 x 3650	13'5 x 12'0
Bathroom		2442 x 1438	8'10 x 4'9
<b>12</b>	474		
Kitchen/dining/living		5555 x 4019	18'2 x 13'2
Bedroom		3100 x 2900	10'2 x 9'6
Bathroom		2535 x 1613	8'3 x 5'3

Apartment	Size sq ft	mm	ft
<b>13</b>	402		
Kitchen/dining/living		5560 x 3394	18'2 x 11'1
Bedroom		3916 x 2802	12'10 x 9'2
Bathroom		2240 x 1613	7'4 x 5'3
<b>14</b>	497		
Kitchen/dining/living		7715 x 3497	25'3 x 11'5
Bedroom		3293 x 3191	10'9 x 10'5
Bathroom		2250 x 1643	7'4 x 5'4
<b>15</b>	598		
Kitchen/dining/living		6698 x 3911	21'11 x 12'9
Bedroom 1		3357 x 3191	11'0 x 10'5
Bedroom 2		3732 x 2328	12'2 x 7'7
Bathroom		2250 x 1614	7'4 x 5'3



Typical T A Fisher apartment interiors





## SECOND FLOOR

Please note: All dimensions are approximate and are intended as a guide.

Dimensions should not be used for carpet sizes or items of furniture.

We operate a policy of continuous product development and individual features such as windows may vary from time to time.



### Kitchens

- Individually designed
- Inset single bowl sink and drainer with matching mixer taps
- Duropol' worktops
- Under unit lighting



### Appliances included

- Electric fan oven
- Induction hob and telescopic cooker hood
- Integrated dishwasher
- Integrated Fridge/freezer (studios have a fridge with an ice box)
- Integrated washer/dryer



### Decorative finishes

- Moulded architraves and skirtings painted white
- Interior walls will be decorated with Dulux emulsion
- American Oak Veneer internal doors throughout
- Fitted wardrobes, where indicated on the floor plans



### Flooring

- Karndean flooring finish to all apartments



### Bathrooms

- Contemporary classic white fitted Roca bathroom furniture
- Fully tiled walls to showers, half tiled walls above sanitary ware
- Chrome ladder style heated towel rail
- Fitted mirror
- Fully fitted vanity units



### Electrical and heating

- Generous amount of power sockets
- Light fittings include downlighters in the kitchen, bathrooms and en-suite, plus additional under lighting in the kitchen
- Economical heating is provided by fully programmable Dimplex electric panel heaters
- Hot water is provided by an electric hot water cylinder with a seven day programmer



### Safety and security

- For peace of mind, mains electricity powered smoke alarm systems have been fitted to all floors, which have a battery back up in case of a power failure



### Televisions and telephone

- TV/SAT points are fitted to the living room and to all bedrooms
- Master telephone point fitted to the cylinder cupboard plus point to living room



### Communal areas

- There is also a bin store and internal cycle store
- Communal areas will be landscaped in accordance with plans approved by the local authority



### Car parking

- Each of the properties has one allocated parking space



### Tenure

- Each property is sold leasehold, 150 years

### Warranty



- 10 Year ICW



Backed by  
HM Government



Typical T A Fisher apartment interiors



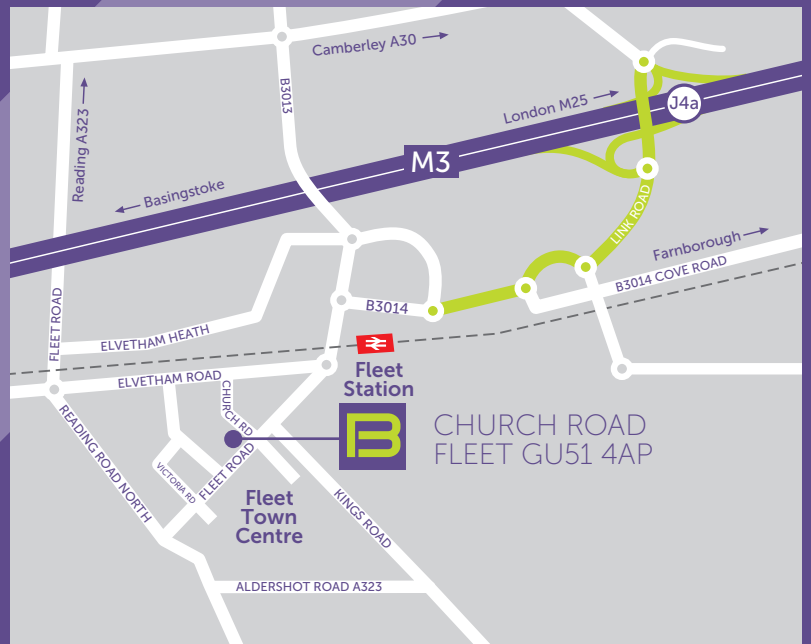

T A Fisher  
Theale Court, 11-13 High Street  
Theale RG7 5AH