



Connells

Boxberry Gardens
Walnut Tree Milton Keynes



Property Description

Two bedroom property in the sought after area of Walnut Tree. Terraced home with allocated parking to the rear with the front garden offering the option for additional parking for two vehicles. In brief the property comprises of an Entrance porch, Lounge, Kitchen/Dining room, two bedrooms and family bathroom. The property also benefits from an allocated parking space.

The property is situated within the Walnut Tree area with it's good school catchment for primary and secondary education, easy access to local amenities including Kingston shopping centre and main road links. Viewing is highly recommended call 01908 691606 now.

Ground Floor

Entrance Porch

Enter via wooden door to front aspect. Large storage cupboard.

Lounge

14' 8" x 13' (4.47m x 3.96m)

Double glazed window to front aspect. Wall mounted radiator. Stairs rising to first floor. Understairs storage cupboard.

Kitchen/Dining Room

13' 6" x 8' 6" (4.11m x 2.59m)

Range of wall and base level units with work surfaces over incorporating a stainless steel

sink unit. Electric oven, gas hob, plumbing for washing machine, space for fridge/freezer. Wall mounted central heating boiler. Wall mounted radiator. Double glazed window to rear aspect. Double glazed door to rear.

Landing

Stairs from ground floor. Airing cupboard. Doors to both bedrooms and bathroom.

Bedroom One

13' 6" max x 11' 4" max (4.11m max x 3.45m max)

Two double glazed windows to front aspect. Wall mounted radiator.

Bedroom Two

12' 1" max x 7' 5" max (3.68m max x 2.26m max)

Double glazed window to rear aspect. Wall mounted radiator.

Bathroom

Suite comprises of low level WC and wash hand basin, single panelled bath and electric shower over. Fully tiled, wall mounted radiator, frosted double glazed window to rear aspect.

Outside

Front Garden

Pathway leading to front door. Mature hedges. Lawned area.

Rear Garden

Mainly laid to lawn with patio area. Shed. Enclosed by wood panelled fence. Rear gated access to alleyway that leads to allocated parking space.







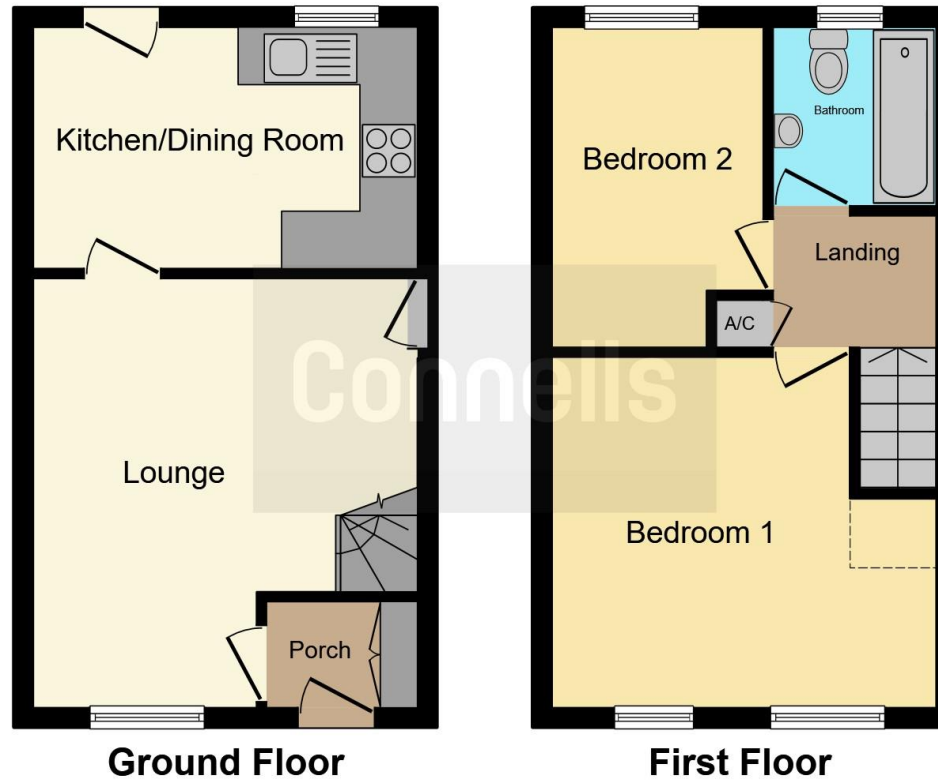

This floor plan is for illustrative purposes only. It is not drawn to scale. Any measurements, floor areas (including any total floor area), openings and orientation are approximate. No details are guaranteed, they cannot be relied upon for any purpose and they do not form part of any agreement. No liability is taken for any error, omission or misstatement. A party must rely upon its own inspection(s). Powered by www.focalagent.com

To view this property please contact Connells on

T 01908 691606
E walnuttree@connells.co.uk

26A Fyfield Barrow The Walnut Tree Local Centre Walnut Tree
 MILTON KEYNES MK7 7AN

EPC Rating: C

view this property online connells.co.uk/Property/WNT306877

Tenure: Freehold



1. MONEY LAUNDERING REGULATIONS Intending purchasers will be asked to produce identification documentation at a later stage and we would ask for your co-operation in order that there will be no delay in agreeing the sale. 2. These particulars do not constitute part or all of an offer or contract. 3. The measurements indicated are supplied for guidance only and as such must be considered incorrect. Potential buyers are advised to recheck measurements before committing to any expense. 4. We have not tested any apparatus, equipment, fixtures, fittings or services and it is in the buyers interest to check the working condition of any appliances.

Connells Residential is registered in England and Wales under company number 1489613, Registered Office is Cumbria House, 16-20 Hockliffe Street, Leighton Buzzard, Bedfordshire, LU7 1GN. VAT Registration Number is 500 2481 05.

See all our properties at www.connells.co.uk | www.rightmove.co.uk | www.zoopla.co.uk

Property Ref: WNT306877 - 0005