



View of block





**£265,000**

This spacious two double bedroom first floor maisonette, located on the sought after Grove side of Tring, is welcomed to the market offering lounge/dining room, kitchen, family bathroom and roof garden.

# Property Description

## **ENTRANCE**

Door to:

## **ENTRANCE HALL**

Stairs to first floor.

## **LOUNGE**

Double glazed sliding door to roof terrace. Wall mounted electric heater.

## **KITCHEN**

Double glazed window to front aspect. Wall mounted and floor standing units with work surface over, one and a half bowl stainless steel sink with mixer tap, built in oven and hob with extractor fan over, integrated dishwasher, washing machine and fridge/freezer, breakfast bar, spotlights.

## **LANDING**

Double glazed window to rear aspect. Wall mounted electric heater.

## **BEDROOM ONE**

Double glazed window to rear aspect. Wall mounted electric heater.

## **BEDROOM TWO**

Double glazed window to rear aspect. Built in wardrobe, wall mounted electric heater.

## **BATHROOM**

Double glazed window to rear aspect. Low level w.c., ,pedestal wash hand basin, panelled bath with shower over, heated towel rail.

## **OUTSIDE**

## **PARKING**

Parking to rear (not allocated).

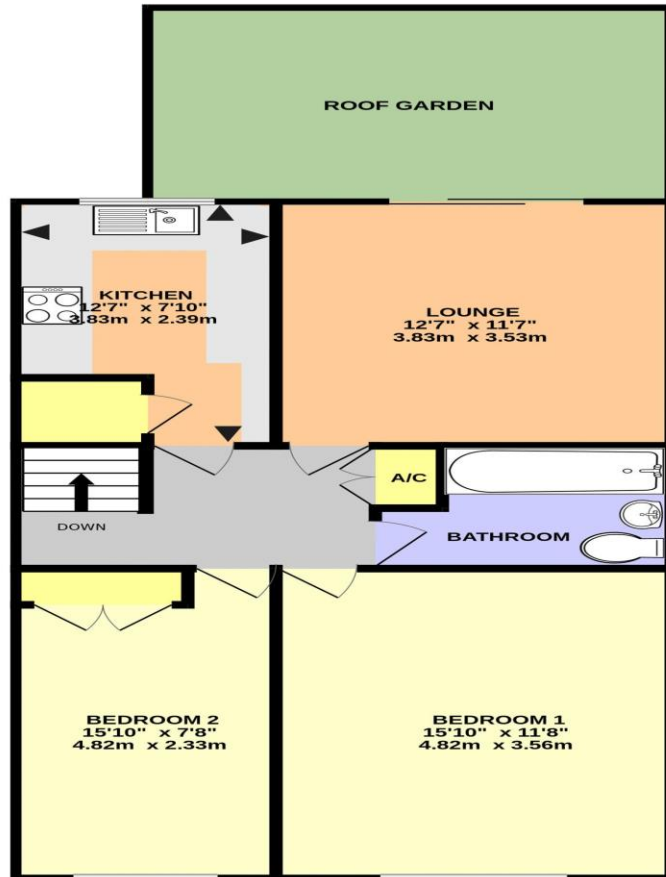

CHILTERN WAY, TRING HP23 5JY (PRODUCED FOR MICHAEL ANTHONY)

TOTAL FLOOR AREA : 670 sq.ft. (62.2 sq.m.) approx.

No accuracy to this image, text or measurements is guaranteed  
Made with Metropix ©2024

MONEY LAUNDERING REGULATIONS 2017 intending purchasers will be asked to produce identification and proof of financial status when an offer is received. We would ask for your co-operation in order that there will be no delay in agreeing the sale.

THE CONSUMER PROTECTION REGULATIONS 2008 The Agent has not tested any apparatus, equipment, fixtures and fittings or services and so cannot verify that they are in working order or fit for the purpose. A Buyer is advised to obtain verification from their Solicitor or Surveyor. References to the Tenure of a Property are based on information supplied by the Seller. The Agent has not had sight of the title documents. A Buyer is advised to obtain verification from their Solicitor. You are advised to check the availability of this property before travelling any distance to view. We have taken every precaution to ensure that these details are accurate and not misleading. If there is any point which is of particular importance to you, please contact us and we will provide any information you require. This is advisable, particularly if you intend to travel some distance to view the property. The mention of any appliances and services within these details does not imply that they are in full and efficient working order. These particulars are in draft form awaiting Vendors confirmation of their accuracy. These details must therefore be taken as a guide only and approved details should be requested from the agents

79 High Street Tring Herts HP23 4AB

01442 891177 | [tring@maea.co.uk](mailto:tring@maea.co.uk)