



Building Plot Beech Grove

Rear of 11 Lime Grove, Louth, LN11 0BN

M A S O N S
— Celebrating 175 Years —



Building Plot, Beech Grove

Rear of 11 Lime Grove, Louth
LN11 0BN

A superb opportunity for a developer or buyer seeking to self-build a brand new, individual house in a residential area of Louth market town. This single building plot has full planning permission to erect a three-bedroom house with detached garage which will provide well-designed accommodation featuring living kitchen diner with patio doors to rear garden, utility and cloaks WC and central hallway, whilst to the first floor are three bedrooms and family bathroom.

MOVEWITHMASONS.CO.UK
01507 350500



The Plot

A flat, level plot currently laid to lawn with hedged and fenced boundaries with access to be created by the purchaser via Beech Grove, by the removal of the front hedge and dwarf brick walls. The plot measures approximately 9.5m wide x 18.2m deep.

The Proposed House

An artist's impression of the proposed dwelling is shown in these details. However, earlier revision of the plans does suggest a wider house with integral garage, providing large upstairs accommodation. Any other designs then shown in these particulars according to revision A, must seek further amendments with the council. However, it does suggest alternative designs could be considered once the plot has been purchased. The design shows a simple pitched roof with a ground floor rear extension to provide the lounge area, with matching detached garage design. The house is set to the side of the plot with driveway access down the side with garage at the rear and rear garden space provided for. Access will be via Beech Grove. Internally, the property opens into the hallway with staircase to first floor and cloaks cupboard, with door through to the living kitchen diner with units situated at the front and a large family open plan space towards the rear with patio doors leading to the garden. A door gives access to the utility room which, in turn, gives access to the WC. To the first floor, the landing gives access to two double bedrooms and a third single or office, with family bathroom at the rear.

Planning

Full planning permission was granted on the 9th May 2022 for the erection of a house with detached single garage on the site of an existing garden with vehicular access via Beech Grove which is to be created by the purchaser. The new rear boundary fence for the plot has been erected by the sellers.

The planning permission has been granted in accordance with application number N/105/02501/21 and the Decision Notice and accompanying documentation can be viewed on the planning portal of the East Lindsey District Council website <https://publicaccess.e-lindsey.gov.uk/online-applications/> or copy documents can be emailed as pdf's on request if preferred.

The planning permission is subject to conditions in respect of the timescale within which the development must be commenced, construction to be in accordance with the approved plans and approval of proposed materials for the building and hard surfaced areas by the local planning authority. The precise wording of the Planning Decision Notice and the relevant conditions should be considered in detail by a prospective purchaser in accordance with the approved plans.

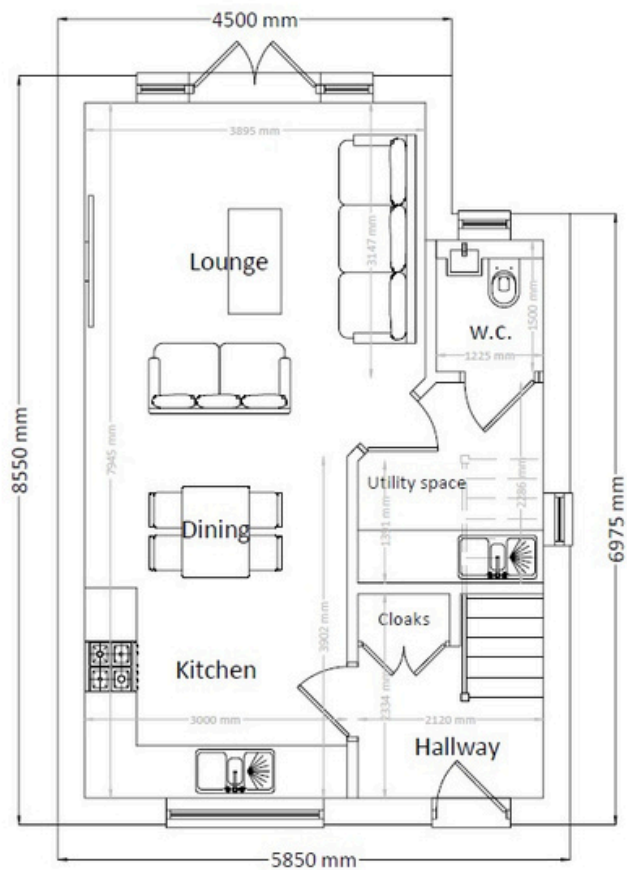

GROUND FLOOR

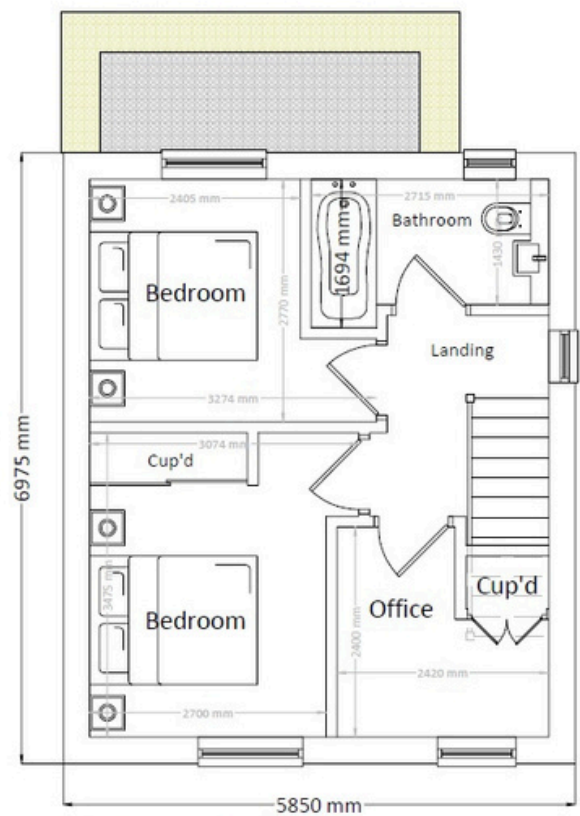

FIRST FLOOR



This floorplan is only for illustrative purposes and is not to scale. Measurements of rooms, doors, windows, and any items are approximate and no responsibility is taken for any error, omission or mis-statement. Icons of items such as bathroom suites are representations only and may not look like real items.

Approximate room dimensions are shown on the floor plans which are indicative of the room layout and not to specific scale.

Louth

Vibrant Living in the Wolds

Known as the Capital of the Wolds, Louth is a vibrant and picturesque market town celebrated for its three bustling weekly markets and a year-round calendar of seasonal and specialist events. The town centre offers an impressive selection of cafés, restaurants, wine bars, and traditional pubs, perfect for relaxing and socialising. With its wealth of independent shops, a thriving theatre, and a cosy cinema, Louth provides a delightful blend of culture, entertainment, and local charm.

For those seeking an active lifestyle, Louth is perfectly positioned on the edge of the Lincolnshire Wolds, offering access to scenic country walks, bridleways, and rolling hills. The town is well-equipped with sports and leisure facilities, including a modern sports and swimming complex. Additionally, Louth boasts a tennis academy, bowls club, football club, golf club, and equestrian centre.

There are many highly regarded primary schools and academies including the King Edward VI Grammar which makes Louth perfect for growing families.

Just seven miles to the east lies the picturesque Lincolnshire coast, featuring nature reserves to the north and south. For business and commerce, the region is well-connected, with the main hubs located in Lincoln, 35 miles away, and Grimsby, just 24 miles to the north.



Viewing

By appointment through the agent.

Council Tax

The property is not recorded on the East Lindsey District Council website for council tax purposes but any residential occupation such as that for which permission has been granted would alter this position.

Method of Sale

The Plot is offered for sale freehold with vacant possession on completion.

Directions

From St. James' church travel south for a short distance on Upgate and turn left along Mercer Row. Follow the road through the town centre as far as the two mini roundabouts and at the second of these, turn left along Ramsgate. At the next mini roundabout take the second exit along Ramsgate Road and then turn second left into Victoria Road. Follow the road to the crossroads and take the right turn onto Keddington Road. Follow the road then turn left into Lime Grove, continue for a short distance, take the next left turning into Beech Grove and follow the road around the left hand bend and the front boundary to the plot will be found on the left hand side. Please note, to gain access to the plot it is necessary to walk through the garden of 11 Lime Grove and therefore, accompanied viewings are necessary for this site.

The particulars of this property are intended to give a fair and substantially correct overall description for the guidance of intending purchasers. No responsibility is to be assumed for individual items. Plans/maps and highlighted images are not to specific scale, are based on information supplied and subject to verification by a solicitor at sales stage against the sale contract plans. Site dimensions have been measured to apparent boundaries on site and should be verified against the contract plans when these have been completed. Applicants should satisfy themselves as to the precise position and accessibility of services and take note of the requirements within the planning permission. BL

M A S O N S

EST. 1850

Cornmarket,
Louth, Lincolnshire
LN11 9QD

01507 350500



Important Notice

Masons Louth for themselves and for vendors or lessees of this property whose agents they are given notice that:

(i) The particulars are set out as a general outline only for the guidance of intended purchasers or lessees, and do not constitute, nor constitute part of, an offer or contract; (ii) All descriptions, dimensions, reference to condition and necessary permissions for use and occupation, and other details are given without responsibility and any intending purchasers or tenants should not rely on them as statements or representations of fact but must satisfy themselves by inspection or otherwise as to the correctness of each of them; (iii) No person in the employment of Masons Louth has any authority to make or give any representation or warranty whatever in relation to this property; (iv) No responsibility can be accepted for any costs or expenses incurred by intending purchasers or lessees in inspecting the property, making further enquiries or submitting offers for the property.

