

Home 2 Sell

Quality Service For Less



26 Ladywell Views, Springwood Gardens

Belper, DE56 1RT

£104,995



Home2sell are delighted to offer for sale this one bedroomed apartment for the over 55's which enjoys a truly stunning location with panoramic views. Offering a superb opportunity for the discerning purchaser to acquire a one bedroom apartment within a retirement development which is located with in walking distance of Belper Town Centre. The facilities include a communal residents lounge and laundry facilities. Access via secure electric doors for wheelchair or mobility scooter access, lift to all floors and the opportunity to tailor make a bespoke care package to suit all needs. Viewing Essential. DRAFT DETAILS SUBJECT TO CHANGE AND VENDOR APPROVAL.



Kitchen

7'2" x 10'3" (2.20m x 3.14m)

Having a range of base wall and matching drawer units with roll top work surface over incorporating a stainless steel sink drainer unit, space for a fridge freezer, integrated electric oven with electric hob and stainless steel extractor canopy over. Wood grain effect flooring and storage cupboard housing the domestic hot water tank.

Open Plan Lounge Dining Room

6'6" extending 9'10" x 15'3" (1.99m extending 3.02m x 4.65m)

Having double glazed doors to the rear elevation with Juliet Balcony enjoying a most pleasant aspect with fine panoramic views that can only be truly appreciated when viewed. Wall mounted electric heater, television point and ceiling light.

Bedroom

18'4" x 9'7" reducing 6'1" (5.60m x 2.93m reducing 1.87m)

Having a double glazed window to the rear elevation with fine aspect and views, two wall lights and wall mounted electric heater.

Shower Room

Having a three piece suite comprising of a close couple WC, pedestal hand wash basin and a shower cubicle with thermostatically controlled shower. Complimentary splash back tiling, Wall mounted heater, extractor fan and wood grain effect flooring.

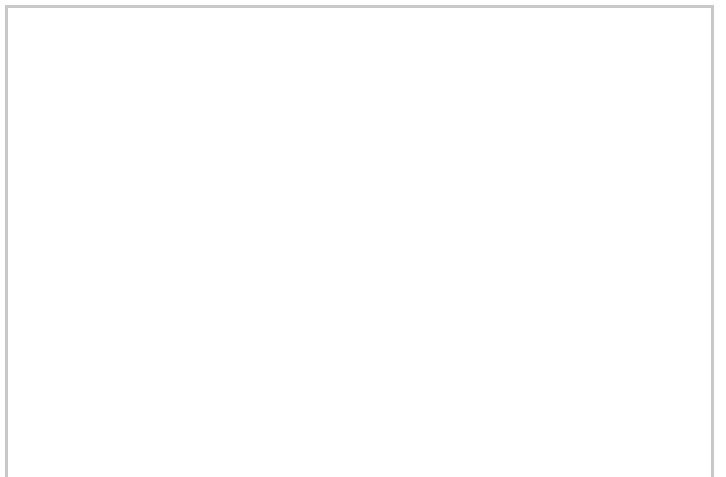
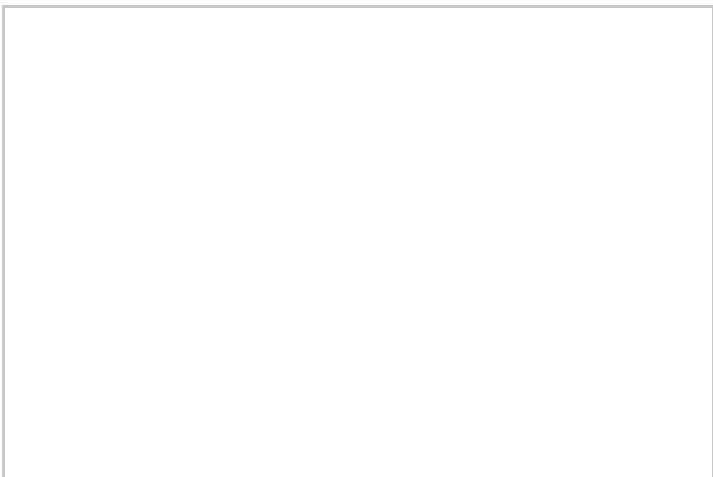

Road Map

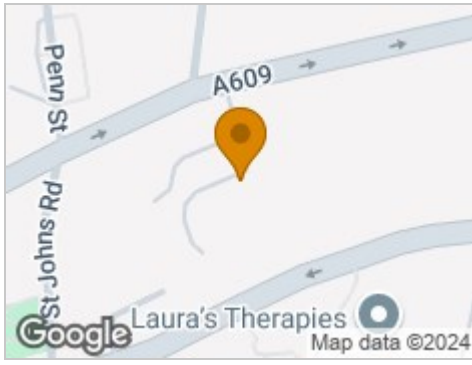

Hybrid Map



Terrain Map

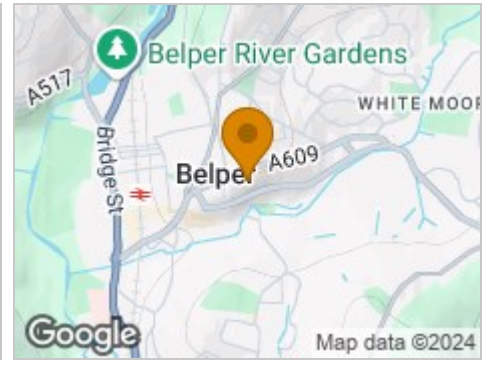

Floor Plan

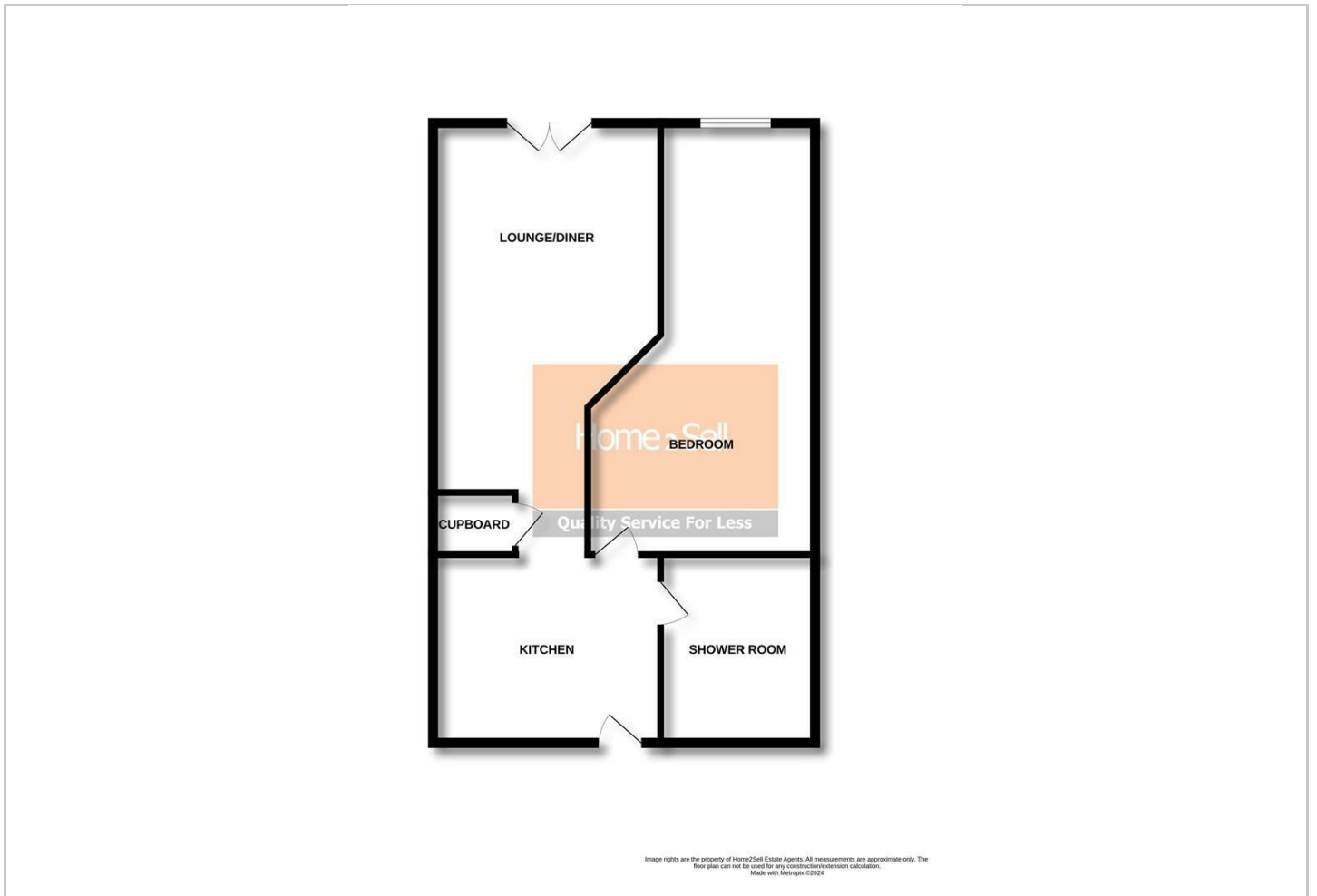

Viewing

Please contact our Belper Sales Office on 01773 823 200 if you wish to arrange a viewing appointment for this property or require further information.

Energy Efficiency Graph

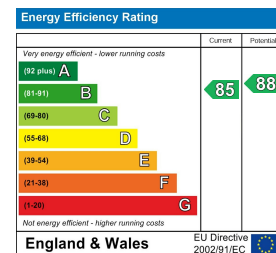

These particulars, whilst believed to be accurate are set out as a general outline only for guidance and do not constitute any part of an offer or contract. Intending purchasers should not rely on them as statements of representation of fact, but must satisfy themselves by inspection or otherwise as to their accuracy. No person in this firm's employment has the authority to make or give any representation or warranty in respect of the property.