



 Jan Forster



 Jan Forster



- Semi Detached Home
- Two Double Bedrooms
- Front and Rear Gardens
- Great Transport Links
- Viewing Essential
- Well Presented
- No Onward Chain
- Excellent Amenities Nearby
- Freehold
- Call For More Information



 Jan Forster



 Jan Forster



**** 360° Tour | <https://www.madesnappy.co.uk/tour/1gfd7g22e1e> ****

This attractive two-bedroom semi-detached home is ideally situated on Nelson Avenue in Coxlodge. A fantastic opportunity for first-time buyers, downsizers, or investors, the property is offered for sale with the benefit of no onward chain.

Conveniently placed for easy access to excellent public transport links and a wide range of local amenities, including shops, supermarkets, a gym and swimming pool, library, and well-regarded schools. Additional amenities can be found in nearby Central Gosforth, Kingston Park, and Newcastle City Centre - making this a highly desirable and well-connected location.

The accommodation briefly comprises an entrance lobby, bright and airy lounge and a kitchen dining room complete fitted units and access to the rear. To the first floor, the landing leads to two double bedrooms- both with built in storage, and there is a modern three-piece family bathroom WC with shower over the bath. The property further boasts double glazing and gas central heating.

Externally there is an easy to maintain garden to the front and there is also a split-level garden to the rear with a lawn and patio areas to each side, along with raised rock planters. A great space to relax in the warmer weather.

For more information or to book a viewing, please, call our Gosforth office on 0191 236 2070.

Tenure

The agent understands the property to be freehold. However, this should be confirmed with a licenced legal representative.

Council Tax Band: A



Approx Gross Internal Area
67 sq m / 718 sq ft

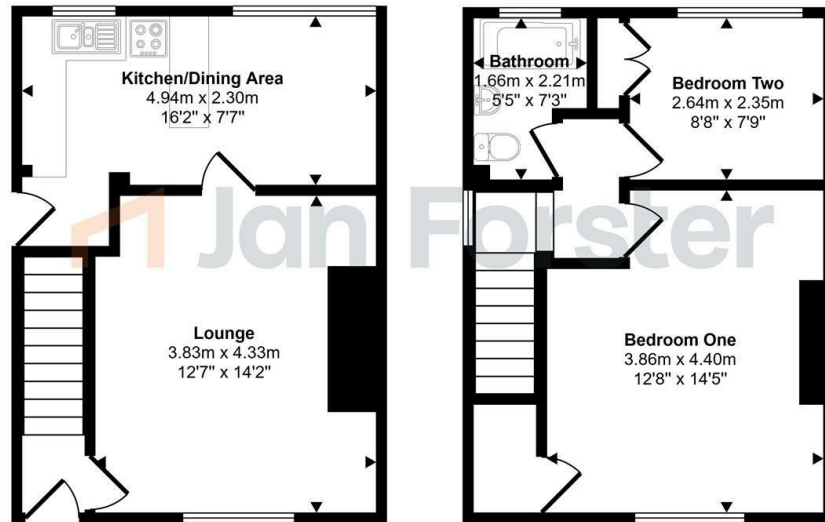

This floorplan is only for illustrative purposes and is not to scale. Measurements of rooms, doors, windows, and any items are approximate and no responsibility is taken for any error, omission or mis-statement. Icons of items such as bathroom suites are representations only and may not look like the real items. Made with Made Snappy 360.

Lounge 12'6" x 14'2" (3.83 x 4.33)

Kitchen Dining Room 16'2" x 7'6" (4.94 x 2.30)

Bedroom One 12'7" x 14'5" (3.86 x 4.40)

Bedroom Two 8'7" x 7'8" (2.64 x 2.35)

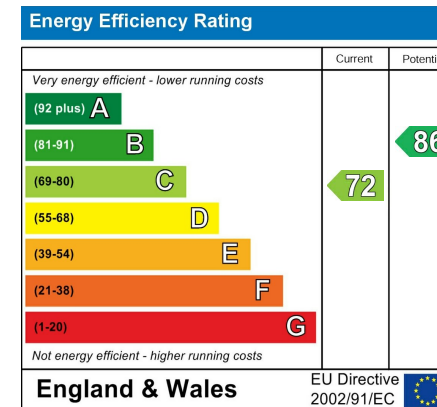

The difference between house and home

You may download, store and use the material for your own personal use and research. You may not republish, retransmit, redistribute or otherwise make the material available to any party or make the same available on any website, online service or bulletin board of your own or of any other party or make the same available in hard copy or in any other media without the website owner's express prior written consent. The website owner's copyright must remain on all reproductions of material taken from this website.



www.janforsterestates.com

Gosforth
High Heaton
Tynemouth

Property Management Centre

0191 236 2070
0191 270 1122
0191 257 2000
0191 236 2680

