







3



1



1

- Popular Residential Estate
- Two Double Bedrooms
- Front and Rear Gardens
- Freehold
- Viewing Recommended
- Semi Detached Home
- Off Street Parking
- Close To Metro
- Council Tax Band \*B\*
- Call For More Information







**\*\* Video Tour on our YouTube Channel | <https://youtu.be/9JI-u1XakLg> \*\***

This charming, two-bedroom which was once a three bedroom, semi-detached home is located in the popular Hardwick Court, Gateshead. This property will appeal to a variety of buyers including first time, downsizers and buy to let investors.

The property is close to excellent transport links to Newcastle city centre, via the Metro and regular bus routes, and is also within easy reach of an abundance of local amenities.

Internally the property briefly comprises to the ground floor: - entrance hallway, lounge and a well-appointed kitchen with fitted units and access to the rear garden. To the first floor there are two double bedrooms (the second bedroom has been opened into what was originally the third bedroom and could be converted back) and there is a three-piece family bathroom/w.c. with shower over the bath. Further benefits include gas central heating, double glazing.

Externally, there is a garden and driveway to the front and also a garden to the rear with a patio area and lawn.

Early viewings come highly recommended. To book yours or for more information, please, call our Gateshead office on 0191 487 0800.

#### Tenure

The agent understands the property to be freehold. However, this should be confirmed with a licensed legal representative.

Council Tax band **\*B\***

**Ground Floor**

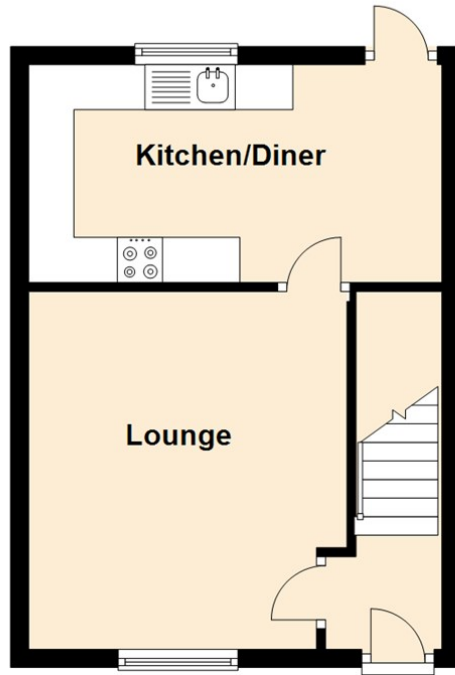

**First Floor**

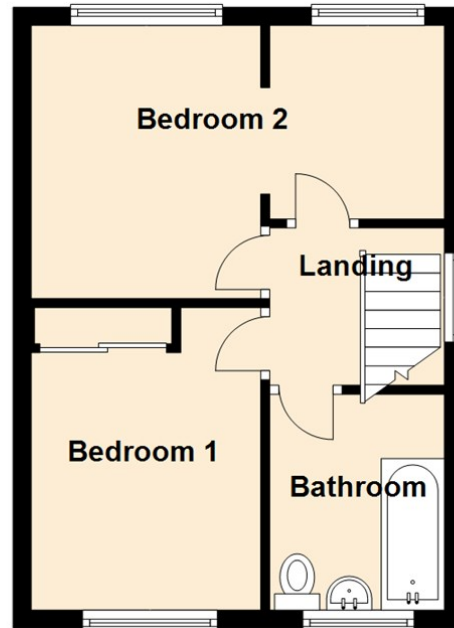

Lounge 13'0" x 11'7" (3.97 x 3.54)

Kitchen 15'0" x 7'11" (4.59 x 2.42)

Bedroom One 8'4" x 11'0" (2.56 x 3.37)

Bedroom Two 15'0" x 8'4" (4.59 x 2.56)

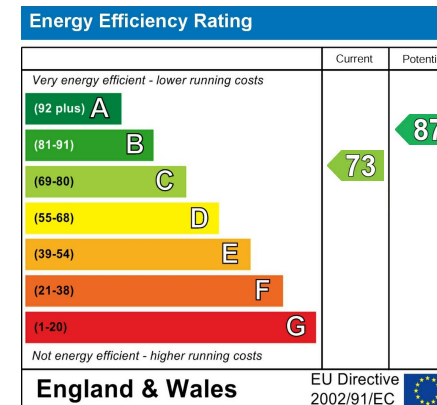

## The difference between house and home

You may download, store and use the material for your own personal use and research. You may not republish, retransmit, redistribute or otherwise make the material available to any party or make the same available on any website, online service or bulletin board of your own or of any other party or make the same available in hard copy or in any other media without the website owner's express prior written consent. The website owner's copyright must remain on all reproductions of material taken from this website.



[www.janforsterestates.com](http://www.janforsterestates.com)

**Gosforth**  
**High Heaton**  
**Tynemouth**  
**Property Management Centre**

**0191 236 2070**  
**0191 270 1122**  
**0191 257 2000**  
**0191 236 2680**

