





3



1



1

- Popular Location
- Open Plan Living
- Front and Rear Gardens
- Double Glazing
- Leasehold
- Three Bedrooms
- Close To Amenities
- Gas Central Heating
- Garage in Nearby Block
- Call for More Information





Jan Forster Estates are pleased to welcome to the market this well presented three-bedroom semi-detached property in the ever-popular Kingston Park. The property will appeal to the first-time buyer, down-sizer, or investor alike.

The location is close to a wealth of local amenities including schools, shops, retail park, local supermarket and superb transport links via Metro line, bus routes and the A1 motorway.

Internally the property briefly comprises to the ground floor: - entrance lobby, bright and airy open plan lounge dining room with storage beneath the stairs and kitchen with fitted units, integrated oven and hob and access to the rear. To the first floor there are three bedrooms, the main with fitted wardrobes and there is a three-piece family bathroom w.c. with shower over the L-shape bath and vanity unit with storage. The property further benefits from gas central heating and double glazing.

Externally there is a garden to the front and a charming garden to the rear with a patio area and lawn. There is also a garage in a nearby block.

For more information and to book your viewing please call our Gosforth team on 0191 236 2070.

Tenure

The agent understands the property to be leasehold. However, this should be confirmed with a licenced legal representative.

Council Tax band *B*



Ground Floor

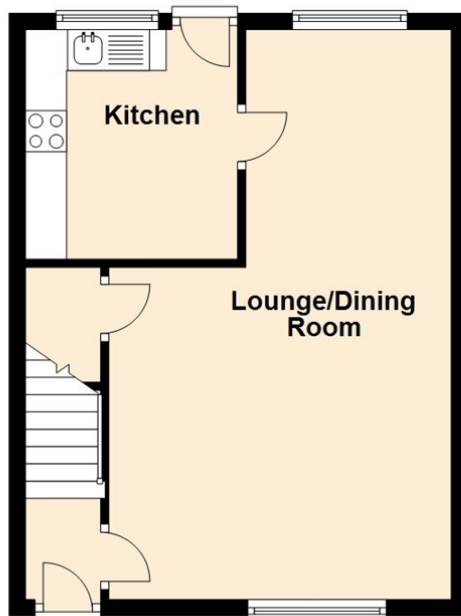

First Floor

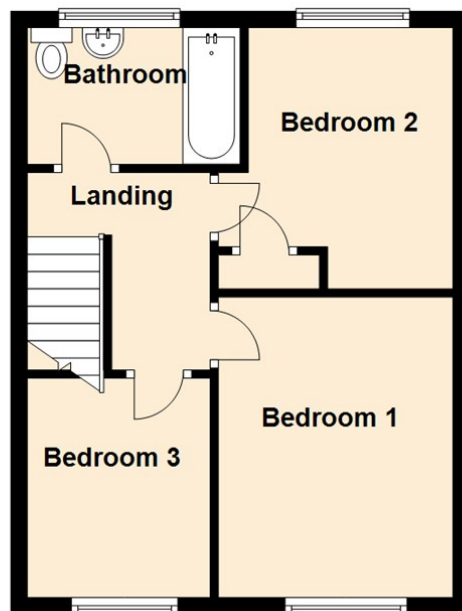

Lounge 13'6" x 13'8" (4.13 x 4.18)

Kitchen 9'8" x 8'3" (2.95 x 2.53)

Bedroom One 8'8" x 12'10" (2.65 x 3.93)

Bedroom Two 8'10" x 10'1" (2.71 x 3.08)

Bedroom Three 9'3" x 6'0" (2.83 x 1.85)

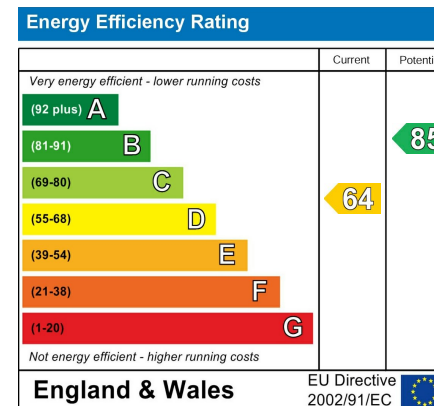

The difference between house and home

You may download, store and use the material for your own personal use and research. You may not republish, retransmit, redistribute or otherwise make the material available to any party or make the same available on any website, online service or bulletin board of your own or of any other party or make the same available in hard copy or in any other media without the website owner's express prior written consent. The website owner's copyright must remain on all reproductions of material taken from this website.



www.janforsterestates.com

Gosforth
High Heaton
Tynemouth
Property Management Centre

0191 236 2070
0191 270 1122
0191 257 2000
0191 236 2680

